

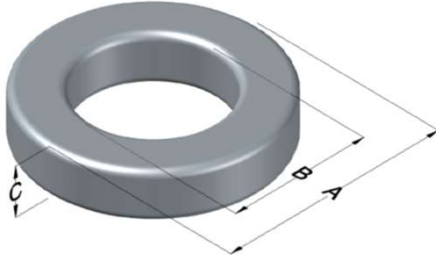

0059439A2

110 Delta Drive
 Pittsburgh, PA 15238
 NAFTA Sales: (1)800-245-3984
 HK Sales : (852)3102-9337
 magnetics@spang.com
 www.mag-inc.com



Edge Permeability (μ)	A_L (nH/T ²)	Core Marking			Coating Color
		Lot Number	Part Number	Inductance Grade	
60	135 ± 8%	XXXXXX	59439A2	N/A	Green

Dimensions	Uncoated		Coated Limits			Packaging
	(mm)	(in)	(mm)	(in)		
OD (A)	46.74	1.840	47.63	1.875	max	Cardboard cut-outs Box Qty= 105 pcs
ID (B)	24.13	0.950	23.32	0.918	min	
HT (C)	18.03	0.710	18.92	0.745	max	

Electrical Characteristics			Physical Characteristics						
Watt Loss @ 100kHz, 100mT max (mW/cm ³)	DC Bias min (oersteds)		Voltage Breakdown wire to wire min (V _{AC})	Break Strength min (kg)	Window Area W _a (mm ²)	Cross Section A _e (mm ²)	Path Length L _e (mm)	Volume V _e (mm ³)	Est. Weight (g)
	80%	50%							
525	100	180	3000	233.0	427	198	107.4	21,300	168

Winding Information					Temperature Rating	
Winding Length Per Turn				Wound Coil Dimensions (mm)		Curie Temp: 500°C
Winding Factor	(mm)	Winding Factor	(mm)	40% Winding Factor	OD	52.4
					HT	26.1
0%	62.2	40%	74.2	Completely Full Window	Max OD	54.8
20%	68.3	45%	76.0		Max HT	35.7
25%	69.7	50%	77.6	Surface Area (mm ²)		
30%	71.0	60%	81.3	Unwound Core	6,900	
35%	72.8	70%	85.6	40% Winding Factor	9,500	
Notes:						
Coating Temp (Continuous up to): 200°C						

