

SUMMARY



Image is for illustrative purpose only

Wires

Low	55
High	0
Coax	0
Triax	0
Quad	0
Fiber	0
Fluidic	0

Download

[Request a quote](#)

[Catalog](#)

Series	LM
Termination type	Female crimp
IP rating	68
Cable Ø	0.00 - 0.00 mm
Matching parts	FMW.LM.355.XLC
Status	
Alternative part	

TECHNICAL DETAILS

Mechanics

Shell Style/Model	ED*: Fixed receptacle with square flange
Keying	
Housing Material	Environment friendly aluminium (nickel plated, anthracite color) shell and nut, other pieces bronze/brass
Cable Fixing	∅ 0 - 0 mm
Variant	

Performance

Configuration	
Insulator	
Rated Current	3.5 Amps

Specifications

Contact Type: Crimp
Max. Matings: 5000
Contact Retention: 30 N
Contact Dia.: 0.9 mm (0.035in)
Bucket Dia.: 1.1 mm (0.043in)

Min. Conductor: 0.25 mm² (AWG 24)
 Max. Conductor: 0.5 mm² (AWG 20)
 R (max): 4.8 mOhm
 Test voltage (kV rms) Contact-contact: 1.65
 Test voltage (kV rms) Contact-shell: 1.95

Others

Humidity (max): ≤95% [at 60 deg C / 140 F]
 Vibration: 15 g [10 Hz - 2000 Hz]
 Shock Resistance: 100 g [6 ms]
 Operating temperature: -55° C / +200° C
 Climatical Category: 15/200/21 (Al. shell)
 Lighting strike EIA 364-75 10K amps - 6 times
 EMI Shielding EIA 364-66A - 1Ghz-80 dB,3GHz-70 dB,6GHz- 58dB
 IP Rating: 68

DRAWINGS

Draws

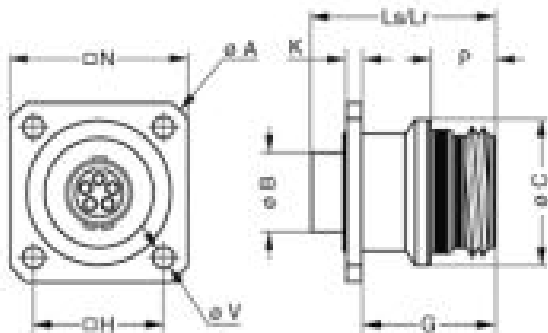

Dimensions

	A	B	C	G	H	K	Lr	Ls	N	P	SV
mm.	38	17.95	28	14.5	23	2	21.9	20	28.5	7.9	3.3
in.	1,50	0,71	1,10	0,57	0,91	0,08	0,86	0,79	1,12	0,31	0,13

RECOMMENDED BY LEMO

Tools

Crimp Tool: DPC.91.701.V
 Crimp settings: AWG/Selector = 20-22-24/6-5-5

Positionner: DCE.91.09T.5MVM
Extractor: DCF.93.090.4LT
Replacement contact: EGW.TM.660.ZZM

Cables