

P	LTR	DESCRIPTION	DATE	DWN	APVD
E1		REVISED PER ECO-17-008114	13JUN2018	RS	DR

AMP WIRE RANGE	E13288 Listed	LR7189 Certified
22-16 AWG SOLID OR STRANDED	22-16 AWG SOLID OR STRANDED	22-16 AWG SOLID OR STRANDED

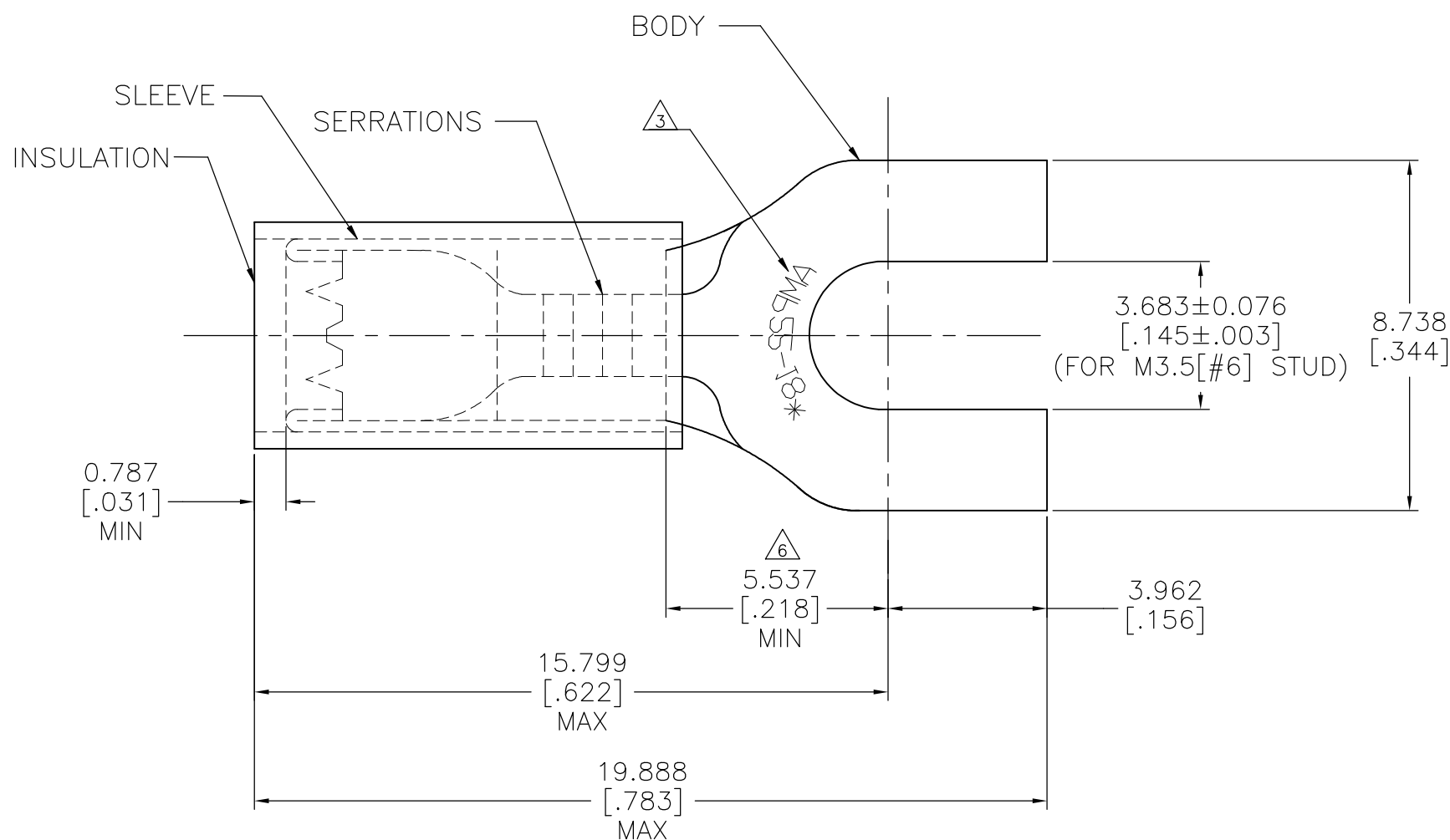

- 1 BODY MATERIAL THK: 0.787±0.051[.031±.002]
- 2 FOR 2.667 TO 3.556[.105 TO .140] WIRE INS. DIA
- 3 MARKING 22-18 FOR MILITARY COMMERCIAL RANGE 22-16
- 4 MATERIAL:
BODY & SLEEVE: COPPER PER ASTM B152
INSULATION: NYLON
- 5 FINISH:
BODY & SLEEVE: TIN PL PER ASTM B545
INSULATION: COLOR - RED
- 6 APPLIES FROM EDGE OF METAL WIRE BARREL TO CENTER OF STUD

1000	LOOSE PIECE	32404
QTY	PACKAGE TYPE	PART NO

AMP INCORPORATED
CUSTOMER SERVICE SYSTEMS

THIS DRAWING IS A CONTROLLED DOCUMENT.

DWN RAVI S 13JUN2018

CHK ROHDE DANIEL 13JUN2018

APVD ROHDE DANIEL 13JUN2018

STE TE Connectivity Ltd.

FOR ADDITIONAL PRODUCT INFORMATION OR COPIES OF DRAWINGS AND TECHNICAL DOCUMENTS
PRODUCT INFORMATION CENTER
1-800-522-6752

MAX RECOMMENDED OPERATING TEMPERATURE:
105°C [221°F]

FOR APPLICATION TOOLING INFORMATION
TOOLING ASSISTANCE CENTER
1-800-722-1111

VOLTAGE RATING:
300 V MAX

FOR ORDER ENTRY
1-800-526-5142

WIRE CROSS SECTIONAL AREA RANGE,
0.26-1.65mm²[509-3,260] CIR MILS
SOLID OR STRANDED

DIMENSIONS:
mm [INCHES]

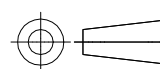

TOLERANCES UNLESS OTHERWISE SPECIFIED:
0 PLC ± -
1 PLC ± -
2 PLC ± -
3 PLC ± 0.127[.005]
4 PLC ± -
ANGLES ± 5°

MATERIAL



FINISH



NAME

ROHDE DANIEL

PRODUCT SPEC

UL 486 A-B

APPLICATION SPEC

114-2157

WEIGHT

WIRE TERMINAL, P.I.D.G.TM - SPADE

WIRE SIZE: 22-16 AWG

SIZE CAGE CODE DRAWING NO RESTRICTED TO

A3 00779 C-32404 -

CUSTOMER DRAWING SCALE NTS SHEET 1 OF 1 REV E1