

used for:

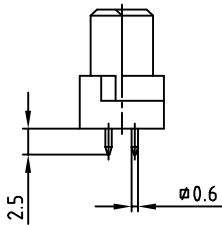
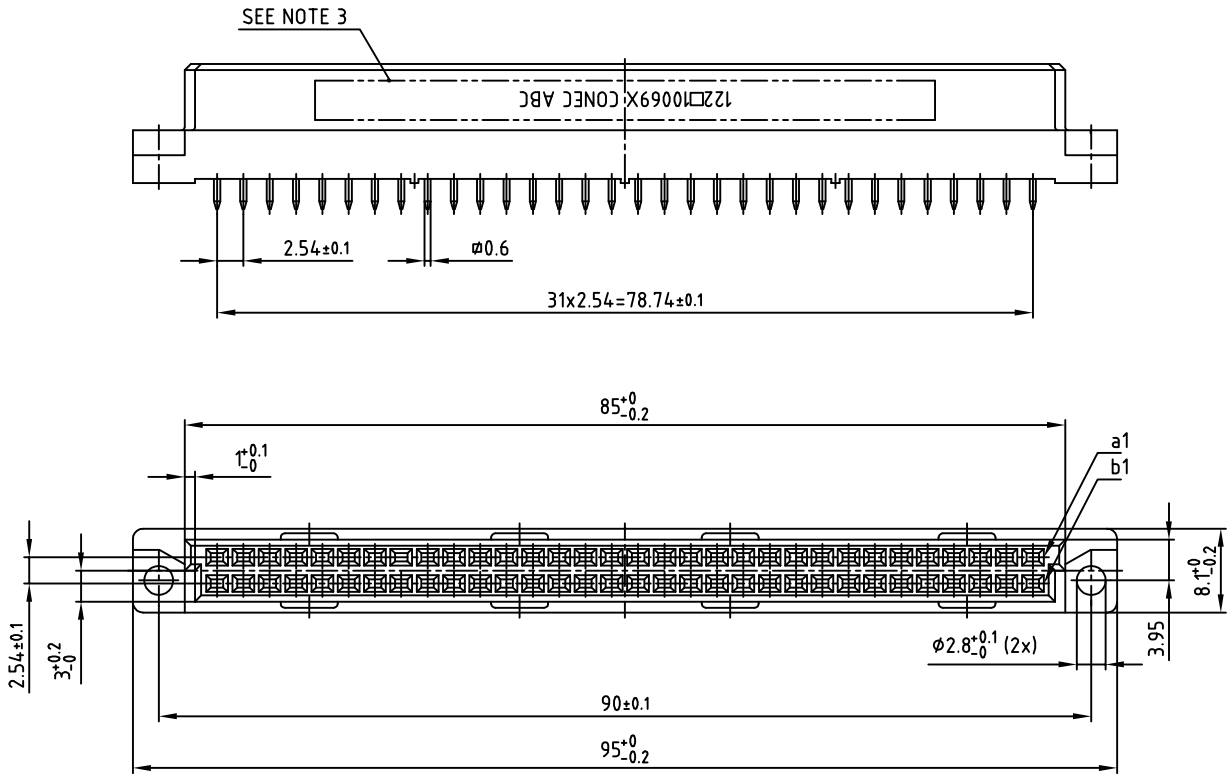

NOTES:

1. INSULATORS: PBT UL 94 V-0, GREY
2. CONTACTS: COPPER ALLOY; PLATING (SEE PART NO.):
 - PLEASE ADD A for GOLD over NICKEL; 50 MATING CYCLES
 - PLEASE ADD B for GOLD over NICKEL; 400 MATING CYCLES
 - PLEASE ADD C for GOLD over NICKEL; 500 MATING CYCLES
3. CONNECTOR IS PART MARKED: 122K10069X CONEC ABC

P.C.B. HOLE DRILLINGS

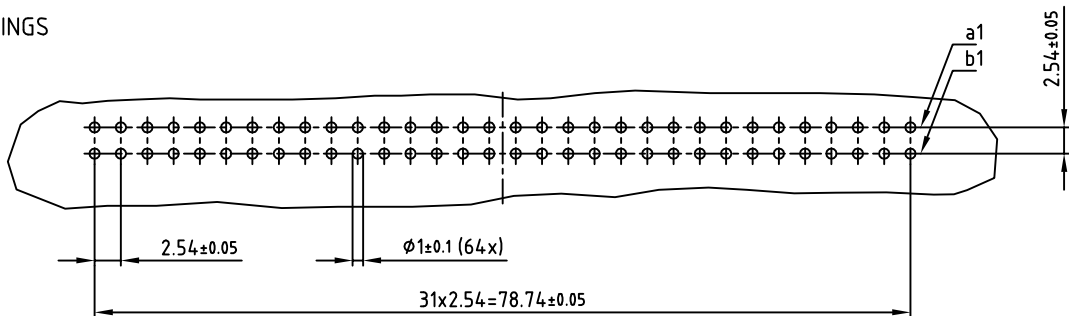

Directive 2002/95/EC RoHS compliant

THIS DRAWING MAY NOT BE COPIED OR REPRODUCED IN ANY WAY, AND MAY NOT BE PASSED ON TO A THIRD PARTY, WITHOUT WRITTEN PERMISSION. OWNERSHIP AND COPYRIGHT OF CONEC GmbH DO NOT ALTER CAD DRAWING BY HAND

rev.	description	date	name
a	Original		

tolerance		
dim.	in mm	
2013	date	name
drawn	28.05.	Henneboel
appd.	28.05.	Mickenbecker
norm		
d-old		

scale:	2:1	
material:	SEE NOTES	
title:	FEMALE CONNECTOR TYPE "B" 64 pos. SOLDER PIN STRAIGHT 2.5mm	
dwg no:	12K1A796	DIN-A 3 sh: 1/1
part no:	122K10069X	(see note 3)