

4

3

2

1

PART NUMBERS BR (Nickel Plated Brass) ST (Zinc Plated Steel)	THREAD TYPE AND SIZE For thread specs see page 29	DIMENSIONS (INCHES)	
		G Thickness	H Wrenching Flats
NM-06-BR NM-08-BR	M6 x 1.0 M8 x 1.25	.10 (2.5) .10 (2.5)	.39 (10) .39 (10)
NM-10-BR	M10 x 1.5	.11 (2.8)	.51 (13)
NM-12-BR NP-07-BR	M12 x 1.5 PG 7 / 1/4" NPT	.11 (3) .11 (3)	.59 (15) .59 (15)
NP-09-BR NN-38-BR	PG 9 3/8" NPT	.11 (3) .14 (3.5)	.71 (18) .75 (19)
NM-16-BR NP-11-BR	M16 x 1.5 PG 11	.11 (3) .12 (3)	.75 (19) .83 (21)
NM-20-BR NP-13-BR	M20 x 1.5 PG 13.5	.12 (3) .12 (3)	.91 (23) .91 (23)
NN-13-BR NP-16-BR	1/2" NPT PG 16	.14 (3.5) .12 (3)	.94 (24) 1.02 (26)
NM-25-BR	M25 x 1.5	.14 (3.5)	1.14 (29)

PART NUMBERS BR (Nickel Plated Brass) ST (Zinc Plated Steel)	THREAD TYPE AND SIZE For thread specs see page 29	DIMENSIONS (INCHES)	
		G Thickness	H Wrenching Flats
NP-21-BR NN-21-BR	PG 21 3/4" NPT	.14 (3.5) .14 (3.5)	1.26 (32) 1.18 (30)
NM-32-BR NP-29-BR	M32 x 1.5 PG 29	.16 (4) .16 (4)	1.42 (36) 1.61 (41)
NN-29-BR	1" NPT	.14 (3.5)	1.38 (35)
NN-10-ST NP-36-BR	1" NPT PG 36	.24 (6) .20 (5)	1.73 (44) 2.01 (51)
NM-40-BR NN-34-ST	M40 x 1.5 1-1/4" NPT	.20 (5) .20 (5)	1.77 (45) 2.01 (53)
NN-36-ST NM-50-BR	1-1/2" NPT M50 x 1.5	.16 (4) .22 (5)	2.19 (55.5) 2.16 (55)
NP-42-BR NP-48-BR	PG 42 PG48	.20 (5) .22 (6)	2.36 (60) 2.52 (64)
NM-63-BR	M63 x 1.5	.24 (6)	2.76 (70)

See pages 12-21 for the Nickel Plated Brass Product Line. To specify fittings with Locking Nut in one part number, add "-N" to the connector number. **Example:** CD13NA-BR-N (product will still be invoiced separately).

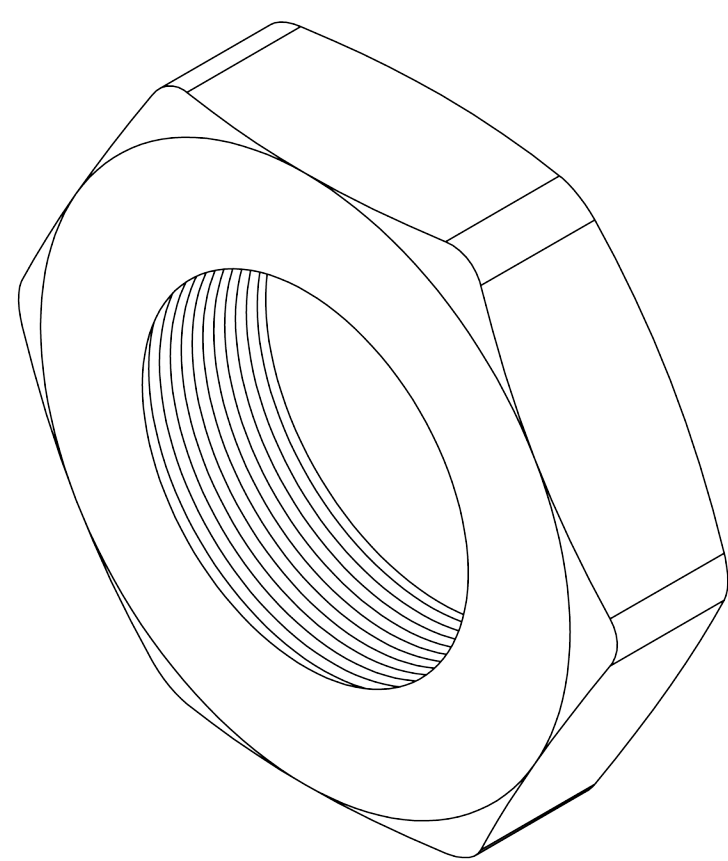

#### NOTES:

- 1) GENERAL DIMENSIONS DRAWINGS.
- 2) DIMENSIONS [ ] ARE IN INCHES.
- 3) DIMENSIONS NOTED ARE FOR REFERENCE ONLY.

Third angle projection

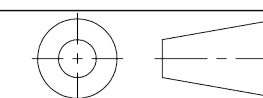

# SEALCON

7374 S. EAGLE STREET  
CENTENNIAL, CO 80112-4221 USA  
TOLL FREE: 1-800-456-9012  
PHONE: 303-699-1135  
EMAIL: [info@SealconUSA.com](mailto:info@SealconUSA.com)  
WEBSITE: [www.SealconUSA.com](http://www.SealconUSA.com)

4

3

2