

Customer Information Sheet

DRAWING No.: M20-789XXXX

SHEET 2 OF 2

IF IN DOUBT - ASK

©

NOT TO SCALE

THIRD ANGLE PROJECTION

ALL DIMENSIONS IN mm

SPECIFICATION:

MATERIAL:
 MOULDING = PA6T UL94V-0, BLACK
 CONTACTS = PHOSPHOR BRONZE
FINISH (OVER NICKEL):
 42 = GOLD FLASH ON CONTACT AREA,
 2.54µ 100% TIN ON TAILS
 46 = 2.54µ 100% TIN
ELECTRICAL:
 CURRENT RATING = 3A
 VOLTAGE PROOF = 500V AC FOR ONE MINUTE
 CONTACT RESISTANCE = 20mΩ MAX
 INSULATION RESISTANCE = 1,000MΩ MIN.
MECHANICAL:
 DURABILITY = 300 CYCLES MIN (GOLD),
 50 CYCLES MIN (TIN)
 INSERTION FORCE = 2.0N MAX PER PIN
 WITHDRAWAL FORCE = 0.5N MIN PER PIN
ENVIRONMENTAL:
 TEMPERATURE RANGE = -40° TO +105°
PACKING:
 TUBE
 FOR COMPLETE SPECIFICATION SEE COMPONENT
 SPECIFICATION C001XX (LATEST ISSUE)

PART SECTION X-X

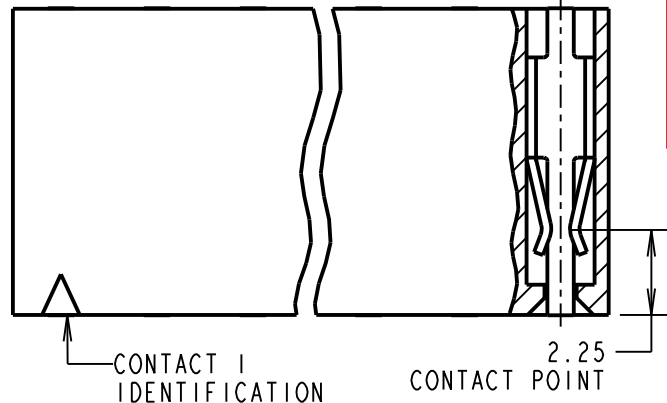

OBSOLETE
 All other size/
 finish
 combinations not
 listed

ORDER CODE: M20-789XXXX
 No. OF CONTACTS: _____
 02 TO 20, 25, 36, 40
FINISH: _____
 42 = SELECTIVE GOLD + 100% TIN
 46 = 100% TIN

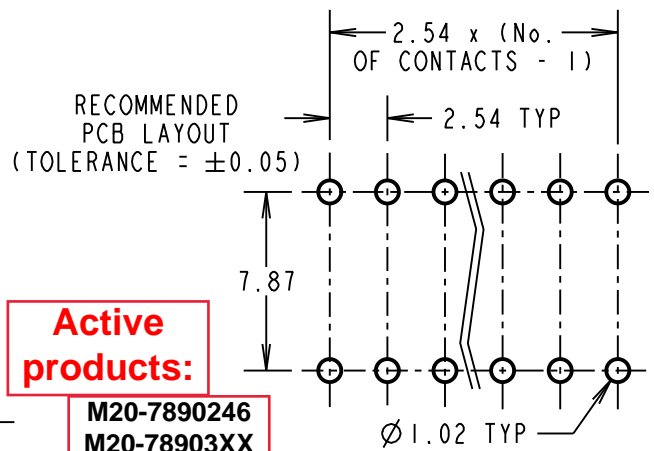

Active products:
 M20-7890246
 M20-78903XX
 M20-78904XX
 M20-78905XX
 M20-78906XX
 M20-78908XX
 M20-7891046
 M20-7891442
 M20-7892046
 M20-7893646

WJP	14	01.08.17	20398
NAME	ISS.	DATE	C/NOTE
APPROVED: W. J. PRESTON			
CHECKED: S. BENNETT			
DRAWN: J. EVANS			
CUSTOMER REF.:			
ASSEMBLY DRG:			

NOTES:
 1. ALL TOLERANCES ARE ±0.15
 UNLESS OTHERWISE STATED.

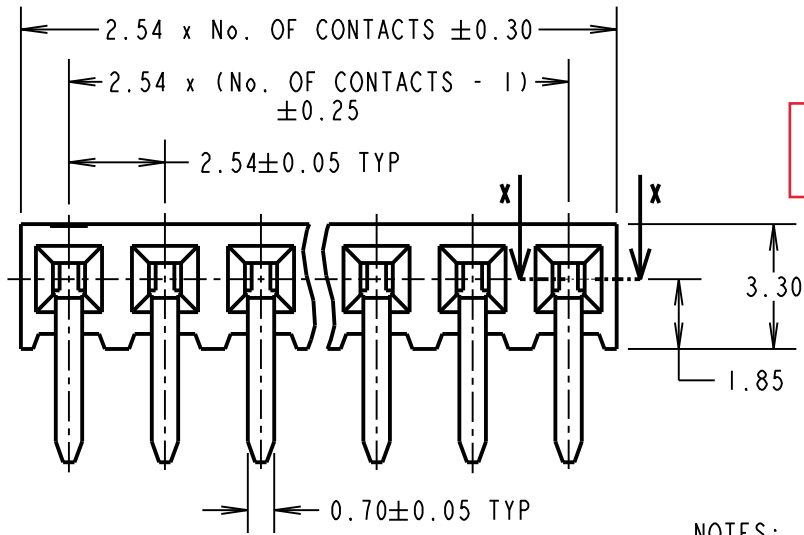
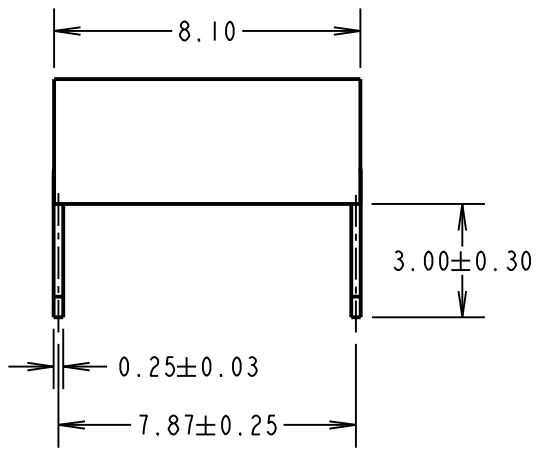

www.harwin.com
 technical@harwin.com

THIS DRAWING AND ANY
 INFORMATION OR DESCRIPTIVE
 MATTER SET OUT HEREON ARE
 CONFIDENTIAL AND COPYRIGHT
 PROPERTY OF THE HARWIN
 GROUP AND MUST NOT BE
 DISCLOSED, LOANED, COPIED
 OR USED FOR MANUFACTURING,
 TENDERING OR FOR ANY
 OTHER PURPOSE WITHOUT
 THEIR WRITTEN PERMISSION.

TOLERANCES
~~X = ±1mm~~
~~X.X = ±0.50mm~~
~~X.XX = ±0.10mm~~
~~X.XXX = ±0.01mm~~
 ANGLES = ±5°
 UNLESS STATED

MATERIAL:
 SEE ABOVE
FINISH:
 SEE ABOVE
S/AREA: mm²

TITLE:
 2.54mm PITCH SIL PC TAIL
 HORIZONTAL SOCKET ASSEMBLY
DRAWING NUMBER:
 M20-789XXXX
 SHT
 2 OF 2