

4

3

2

1

used for: D-SUB

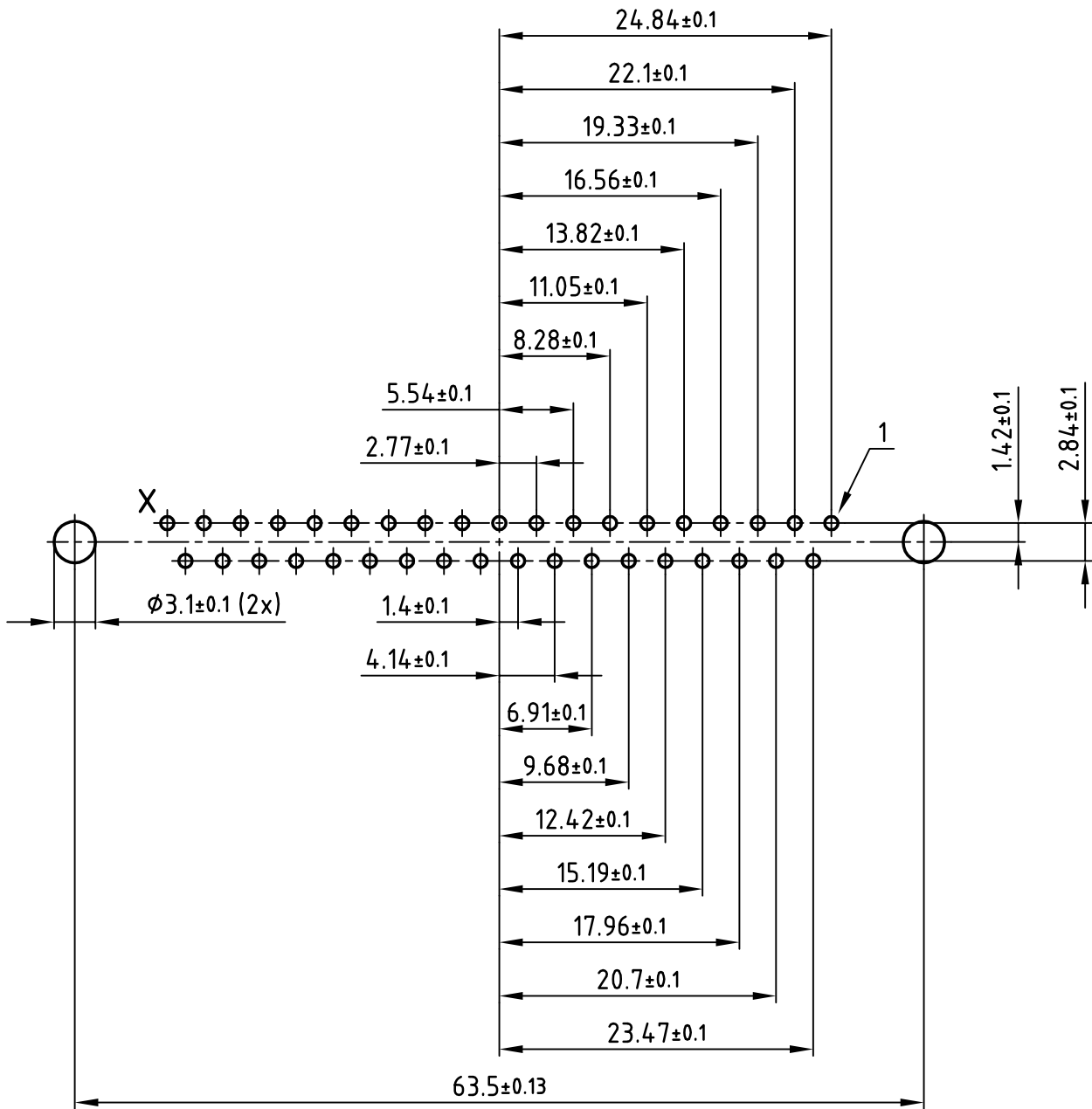

| | |
|---|--------|
| APPROVAL # FREIGABE # DEBLOCAGE # AUTORIZACION # APPROVAL | |
| CUSTOMER APPROVAL DATE: | |
| NAME: | TITLE: |
| COMPANY NAME: | |
| APPROVAL # FREIGABE # DEBLOCAGE # AUTORIZACION # APPROVAL | |

Tin thickness 15µm (600µin) maximum X 5:1
 Copper thickness 25µm (1000µin) minimum

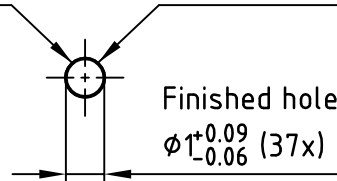

THIS DRAWING MAY NOT BE COPIED OR REPRODUCED IN ANY WAY, AND MAY NOT BE PASSED ON TO A THIRD PARTY WITHOUT WRITTEN PERMISSION.
 OWNERSHIP AND COPYRIGHT OF CONEC GmbH
 DO NOT ALTER CAD DRAWING BY HAND

| | | | | | | | | | |
|------|-------------|------|------|-----------|--------|----------------|--|---|--|
| | | | | tolerance | | dim. in mm | | scale: 2:1 (5:1) | |
| | | | | | | | | material: SEE SHEET 1 | |
| | | | | 2006 | date | name | | title: | |
| | | | | drawn | 11.01. | Lehmenkühler | | P.C.B. HOLE DRILLINGS D-SUB FEMALE 37pos. PRESS-FIT TYPE with threaded rear spacer | |
| | | | | appd. | 11.01. | Mickenbecker | | | |
| | | | | norm | | | | | |
| | | | | d-old | | | | | |
| | | | | | | | | dwg no: AutoCAD 2004 16K2A1259 part no: SEE SHEET 1 | |
| rev. | description | date | name | | | | | DIN-A 4 sh:2/2 | |

4

3

2

1