

**NOTES:**

1. FOR WAVESOLDERING (SOLDER BATH TEMPERATURE 260°C FOR 5 SEC. AND SOLDER PREHEAT 100°C FOR 30 SEC.)
2. METALSHELLS: STEEL; min. 315µin TIN over 40-80µin NICKEL
3. INSULATOR: HIGH TEMPERATURE PLASTIC UL 94 V-0; BLACK
4. CONTACTS: COPPER ALLOY; PLATING (SEE PART NO.):
  - PLEASE ADD A for GOLD FLASH over NICKEL ( PREFERRED TYPE)
  - PLEASE ADD B for 20µin HARD GOLD over min. 50µin NICKEL
  - PLEASE ADD C for 30µin HARD GOLD over min. 50µin NICKEL
- CONTACT TAILS PRETINNED
5. MOUNTING BRACKET: HIGH TEMPERATURE PLASTIC UL 94 V-0; BLACK
6. THREADED INSERTS: COPPER ALLOY; min. 200µin TIN over 80µin NICKEL
7. GROUNDING-CLIPS: COPPER ALLOY; PCB-HOLE: ø3,1±0,1; PCB THICKNESS 1,6mm
8. CAPACITANCE: 1300pF ±20%
9. P.C.B. HOLE DRILLINGS ON SHEET 2
10. DIELECTRIC WITHSTANDING VOLTAGE: 424 VDC
11. MAXIMUM TORQUE VALUE FOR THREAD: 6 in.LB
12. CONNECTOR IS PART MARKED: 242□13000X CONEC ABC (see note 4)

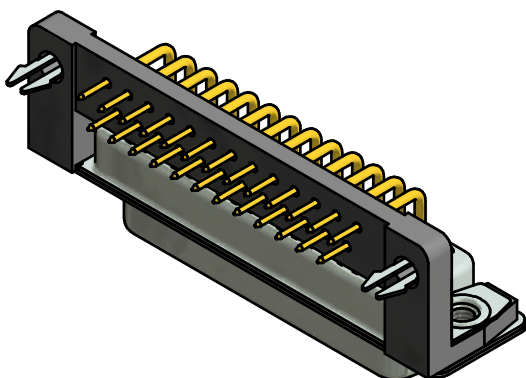

Directive 2002/95/EC RoHS compliant

THIS DRAWING MAY NOT BE COPIED OR REPRODUCED IN ANY WAY, AND MAY NOT BE PASSED ON TO A THIRD PARTY WITHOUT WRITTEN PERMISSION. OWNERSHIP AND COPYRIGHT OF CONEC GmbH DO NOT ALTER CAD DRAWING BY HAND	tolerance		dim. in mm	scale:	2:1 (5:1)	
				material:	SEE NOTES	
	drawn	07.10.14	Henneboel	title: <b>D-SUB C-FILTER FEMALE 90°</b> 25pos. SOLDER PIN ANGLED 0.370inch with threaded insert, mountig bracket, grounding clip		
	appd.	07.10.14	Lehmenkühler			
norm			dwg no:	24K1A1557	DIN-A3	
d-old					sh: 1/2	
a	Original			part no: 242□13000X (see note 4)		
rev.	description date name					

P.C.B. HOLE DRILLINGS  
( P.C.B. TOP SIDE )

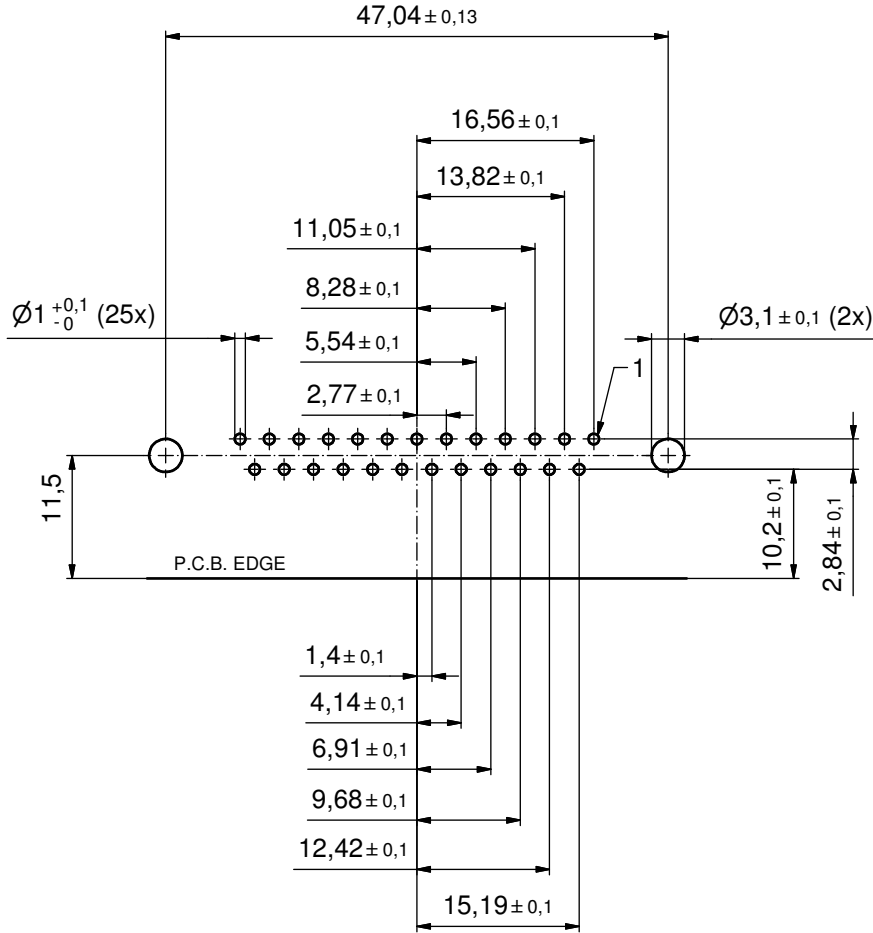

THIS DRAWING MAY NOT BE COPIED OR REPRODUCED IN ANY WAY, AND MAY NOT BE PASSED ON TO A THIRD PARTY WITHOUT WRITTEN PERMISSION. OWNERSHIP AND COPYRIGHT OF CONEC GmbH DO NOT ALTER CAD DRAWING BY HAND				tolerance		scale: 2:1
					dim. in mm	material: SEE SHEET 1
				date	name	title:
				drawn 07.10.14	Henneboel	P.C.B. HOLE DRILLINGS
				appd. 07.10.14	Lehmenkühler	D-SUB C- FILTER FEMALE 90°, 25pos. 0.370inch
				norm		with threaded insert, mounting bracket and grounding clip
				d-old		dwg no:
	a	Original		<b>CONEC</b> <sup>®</sup>		24K1A1557
	rev.	description	date			name
						part no: SEE SHEET 1