

DETAILS

Product Number	CA12070_EMILY-M2
Family	Emily
Type	Assembly
Color	clear
Diameter	26 mm
Height	15 mm
Style	round
Optic Material	PMMA
Holder Material	
Fastening	tape, pin
Status	production ready
ROHS Compliant	Yes
Date Updated	7/07/2016



OPTICAL PROPERTIES

LED	Viewing	Light	Effi-	cd/lm	Connector
	Angle	Beam	ciency		
XM-L	28 deg	M2-class	92 %	-	-
XM-L HVW	sim: 30	M2-class	88 %	-	-
XM-L2	29 deg	M2-class	90 %	3.800	-
XP-L HI	27 deg	M2-class	89 %	4.100	-
NS9x383	26 deg	M2-class	89 %	3.400	-

D

C

B

A

4

4

Beam direction Emily-0-90

Beam direction Emily-0

Bottom view

8.6
C/C

∅2

3

3

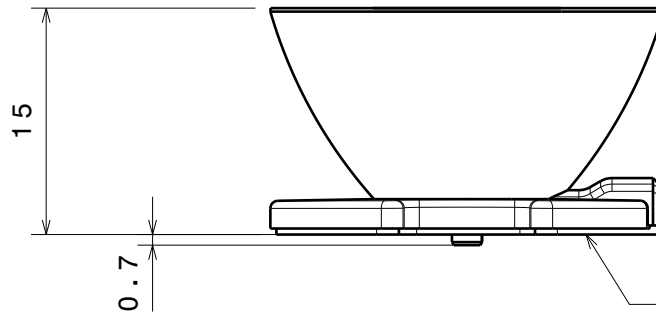

Tape 0.4mm

Front view

2

2

Material:
 Lens: PMMA
 Tape: PU Foam with adhesive

Part no.s:
 CA12062_Emily-SS
 CA12064_Emily-M
 CA12066_Emily-0
 CA12068_Emily-0-90
 CA12070_Emily-M2

∅26

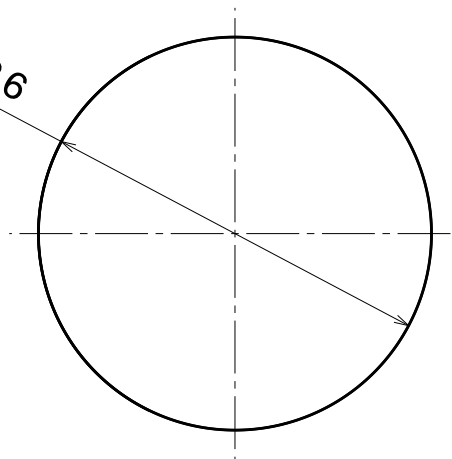

Top view

Tolerances if not otherwise shown
 According to DIN ISO 2768-1
 Linear measures:
 up to 30mm class M, otherwise class C
 According to DIN ISO 2768-2
 Form and position: class L

LEDiL

Ledil Oy
 Salorankatu 10
 FIN 24240 SALO
 Finland

THIRD ANGLE PROJECTION:

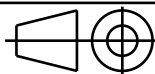

DRAWING TITLE

Datasheet Emily-RE-ES series lens

This drawing is the property
 of LEDiL Oy. It may not be
 reproduced, copied or
 communicated without a written
 agreement with LEDiL Oy.

SIZE PART NUMBER

A4

SCALE 2:1 WEIGHT

SHEET 1/1

D

A

1

Luminaire: Ledil Oy CA12070_Emily-M2-Tape-XM CA12070_Emily-M2-Tape-XM Cree XM-L (white) 97lm @ 250 mA LOR=92%
Lamps: 1 x Cree XM-L (white) 97lm @ 250 mA

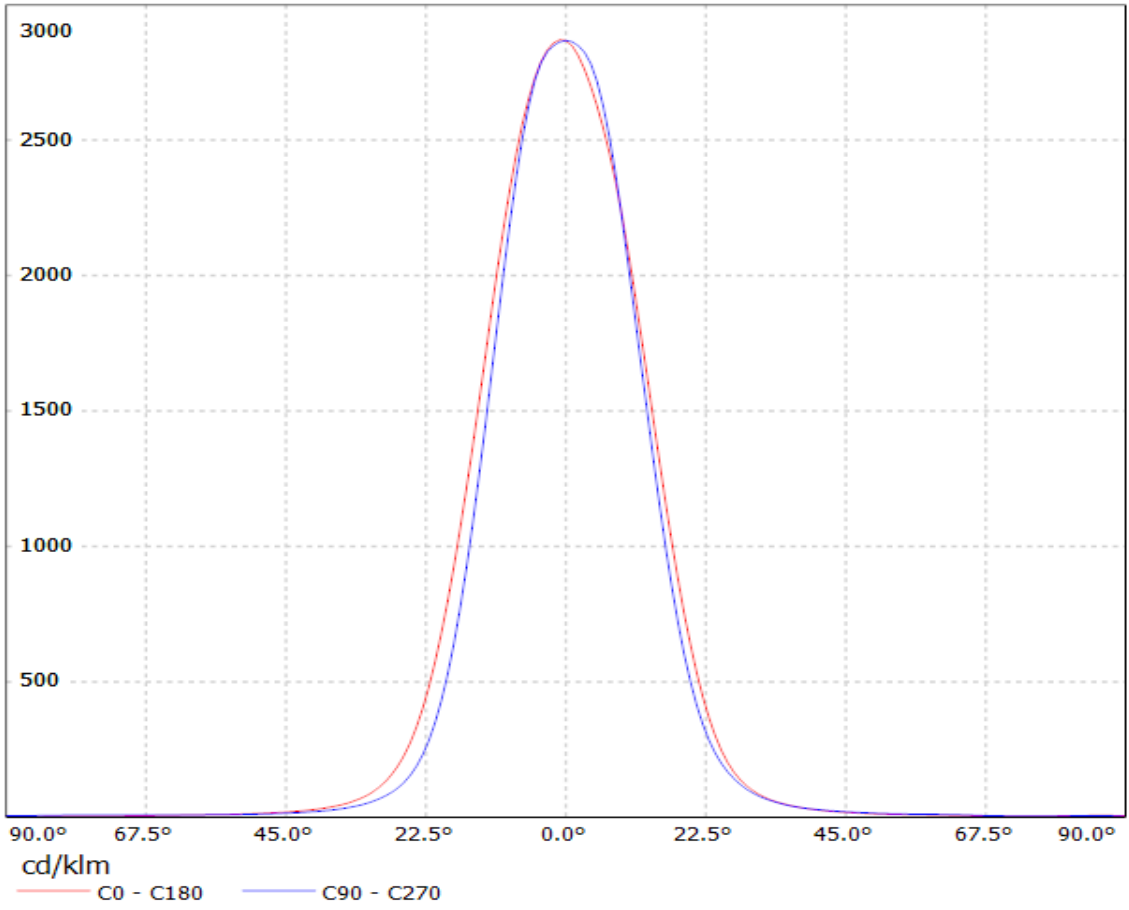

Luminaire: LEDil Oy CA12070_EMILY-M2_(XM-L2) Efficiency=90%
Lamps: 1 x Cree XM-L2 (XMLBWT-0-7B4-T30-0L-0001) 91lm @ 250mA CCT=3200K P=0.7W I=250mA

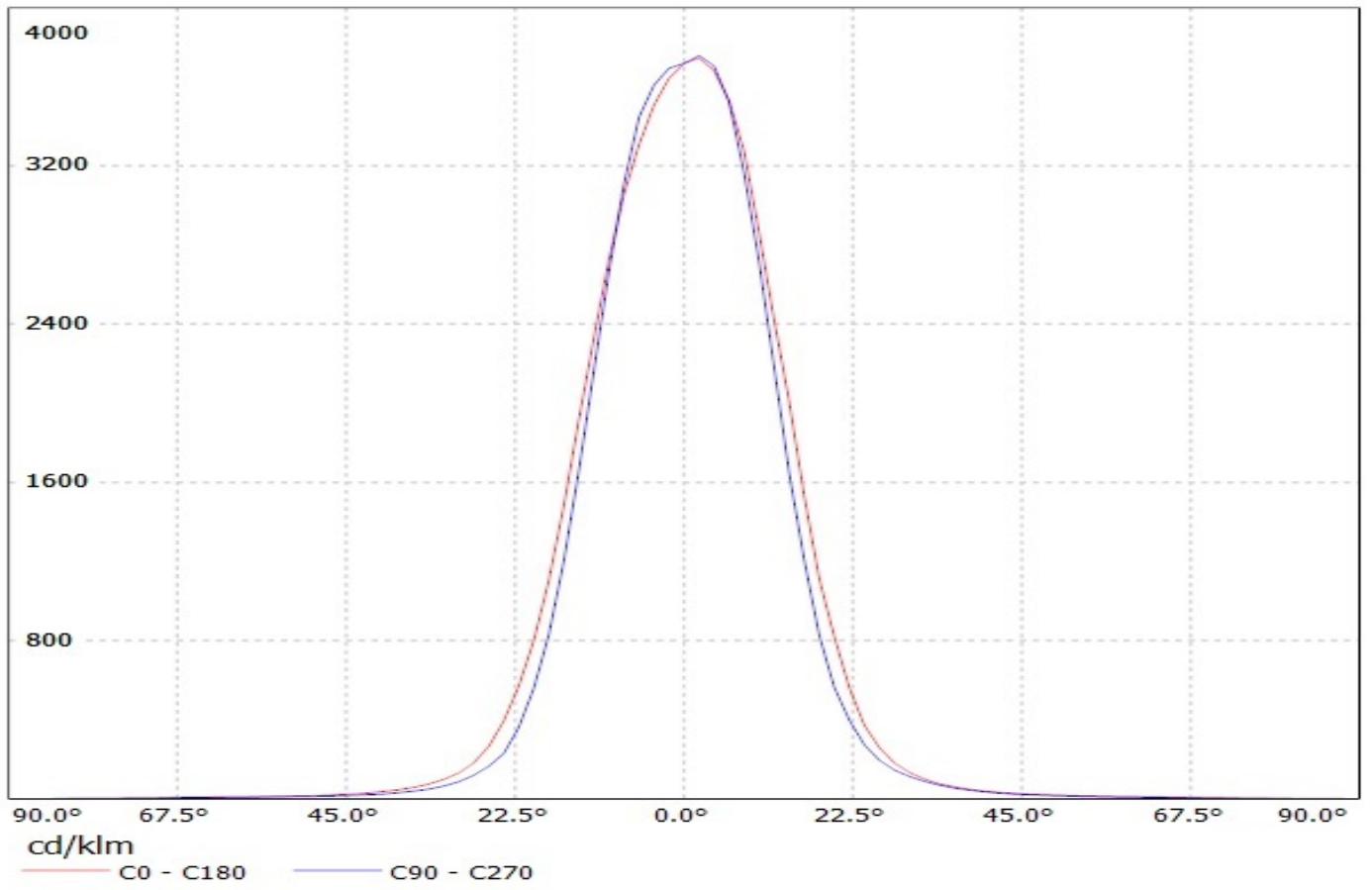

Ledil CA12070_EMILY-M2_(XP-L_HI) / LDC (Linear)

Luminaire: Ledil CA12070_EMILY-M2_(XP-L_HI)

Lamps: 1 x CREE_XP-L_HI_116.971lm@250mA_P=0.75W_I=0.25A

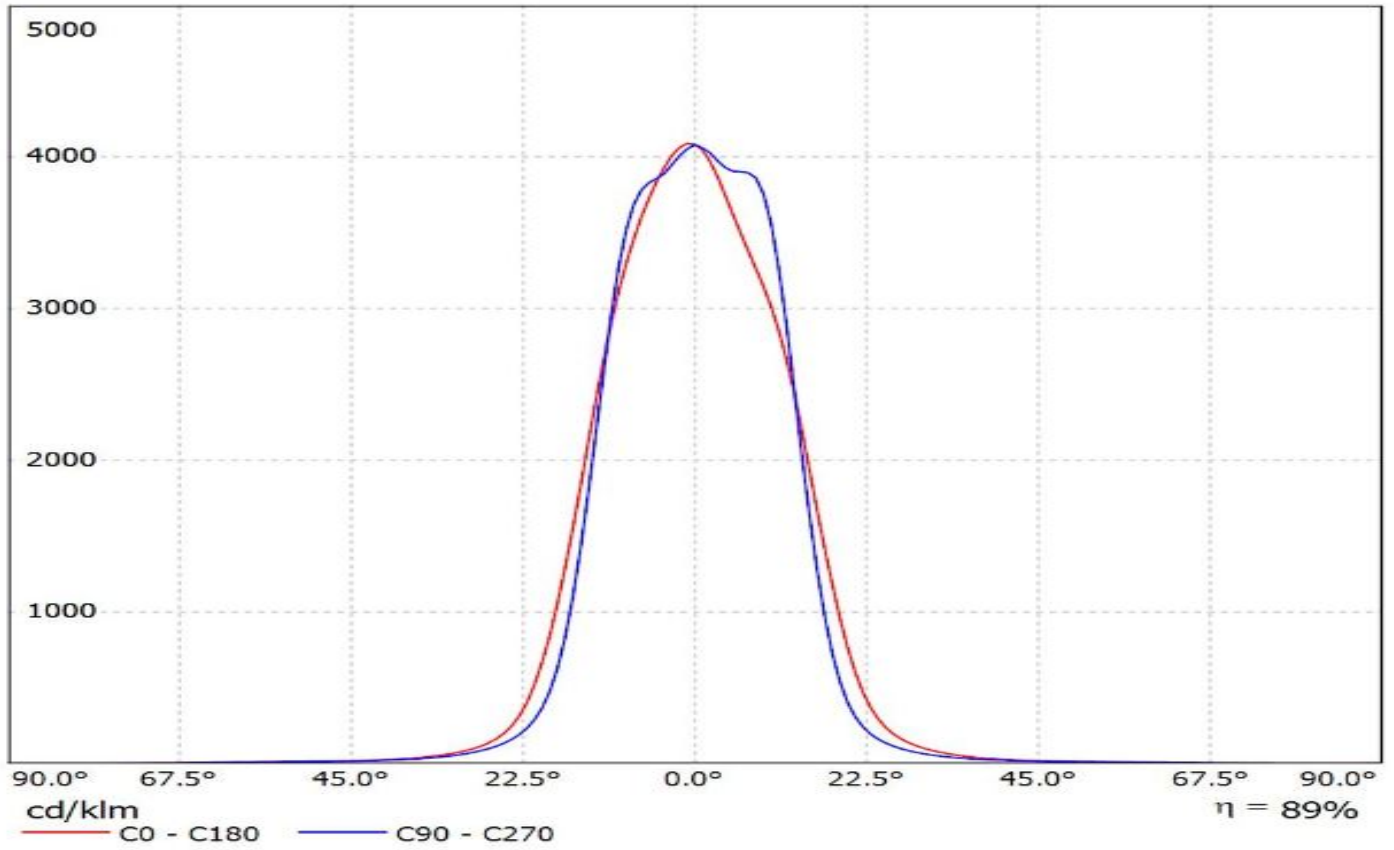

Luminaire: LEDiL Oy CA12070_EMILY-M2_(NS9x383) Eff.88,5%
Lamps: 1 x Nichia NS9x383 (105lm@250mA)

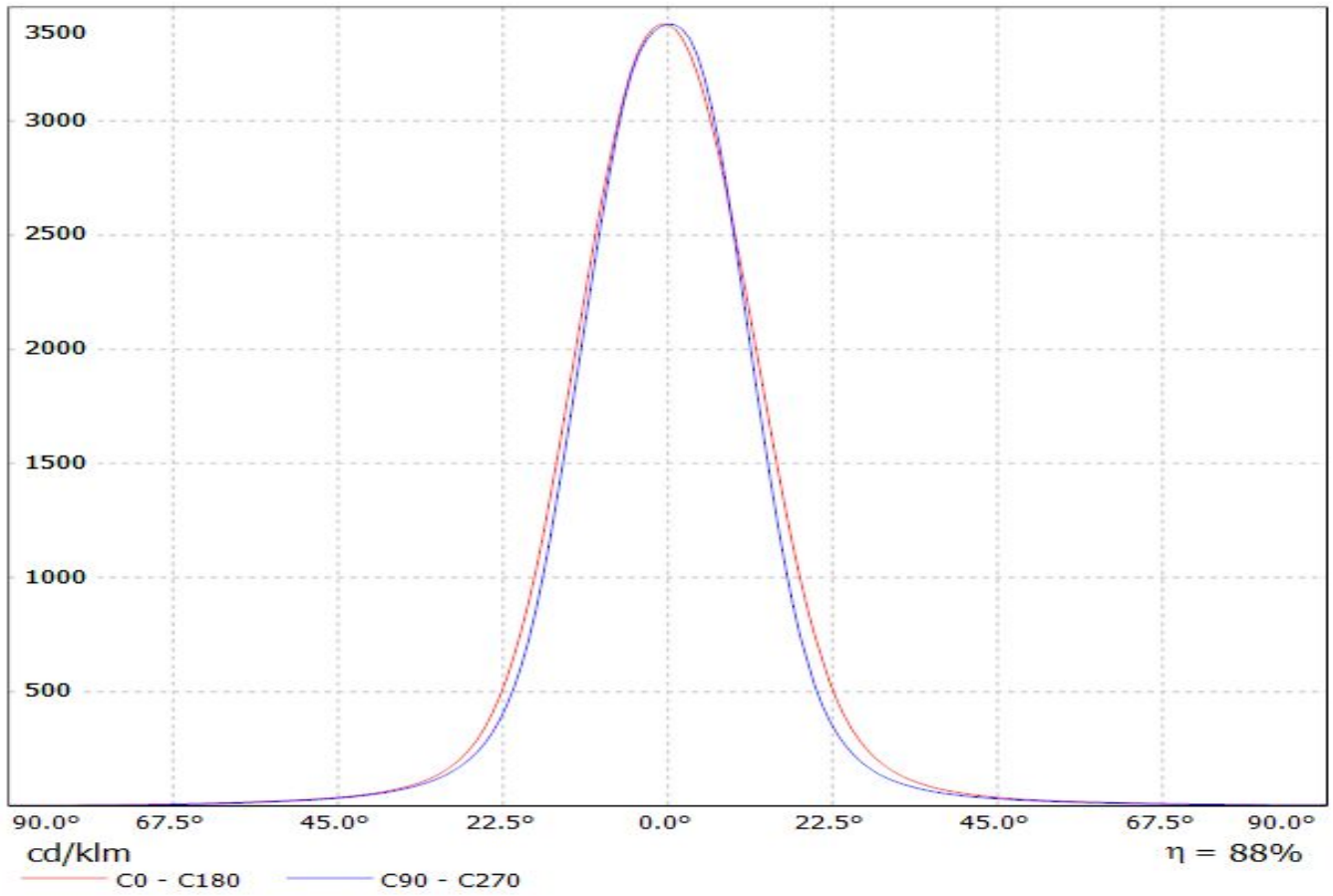

Luminaire: Ledil Oy CA12070_Emily-M2-Tape-XM CA12070_Emily-M2-Tape-XM Cree XM-L (white) 97lm @ 250 mA LOR=92%
Lamps: 1 x Cree XM-L (white) 97lm @ 250 mA

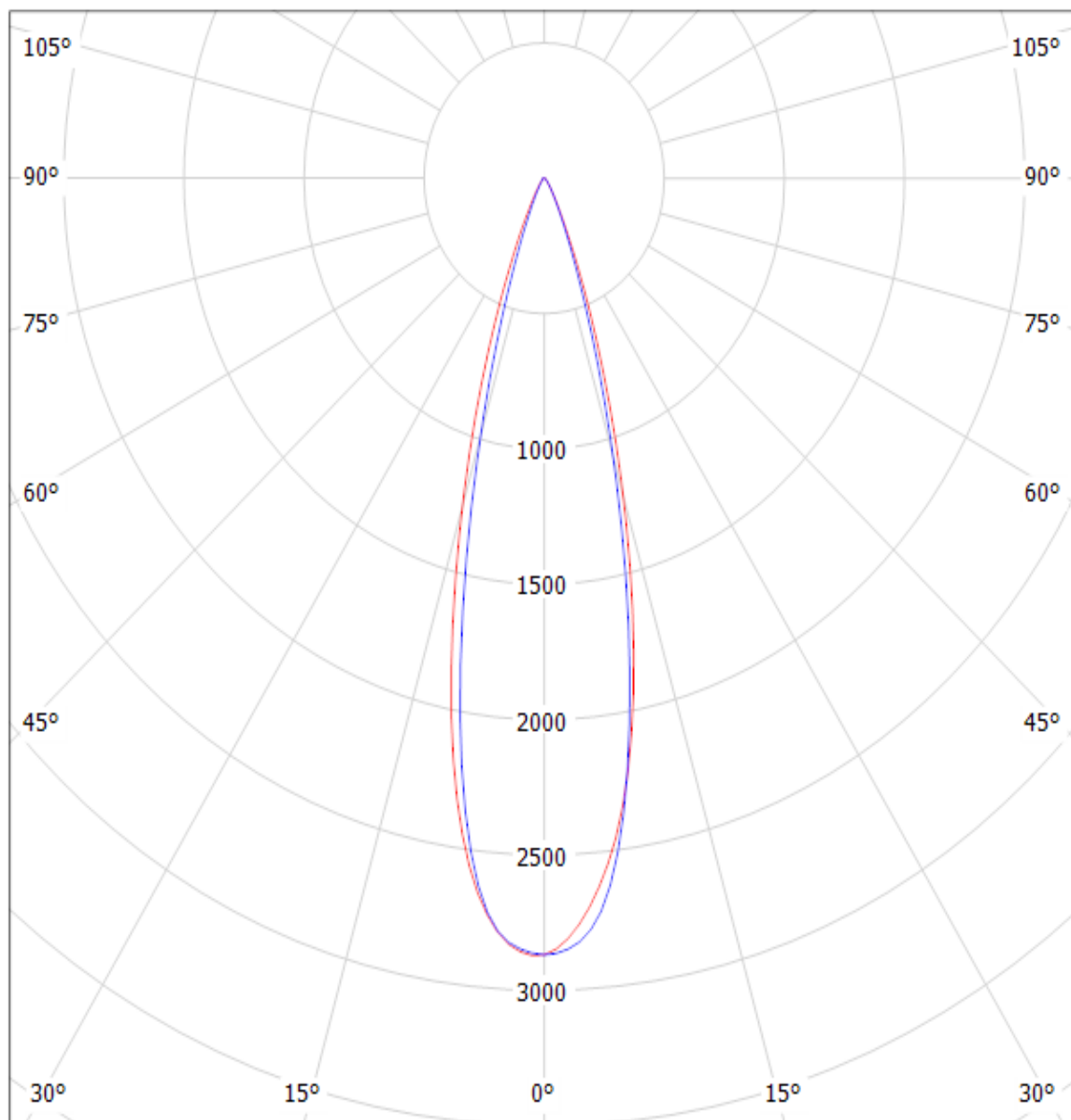

cd/klm

— C0 - C180

— C90 - C270

Luminaire: LEDil Oy CA12070_EMILY-M2_(XM-L2) Efficiency=90%
Lamps: 1 x Cree XM-L2 (XMLBWT-0-7B4-T30-0L-0001) 91lm @ 250mA CCT=3200K P=0.7W I=250mA

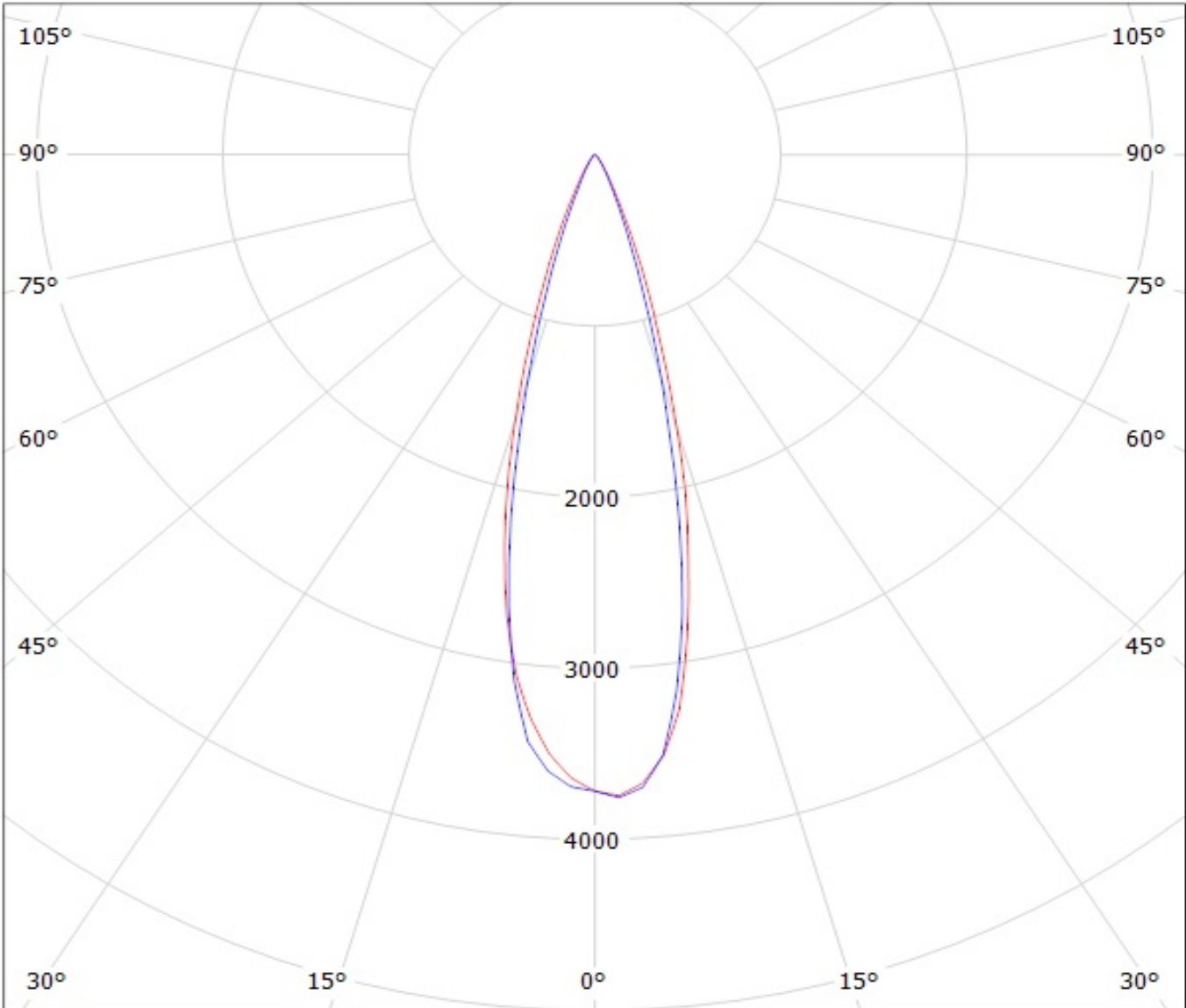

cd/klm

— C0 - C180 — C90 - C270

Ledil CA12070_EMILY-M2_(XP-L_HI) / LDC (Polar)

Luminaire: Ledil CA12070_EMILY-M2_(XP-L_HI)

Lamps: 1 x CREE_XP-L_HI_116.971lm@250mA_P=0.75W_I=0.25A

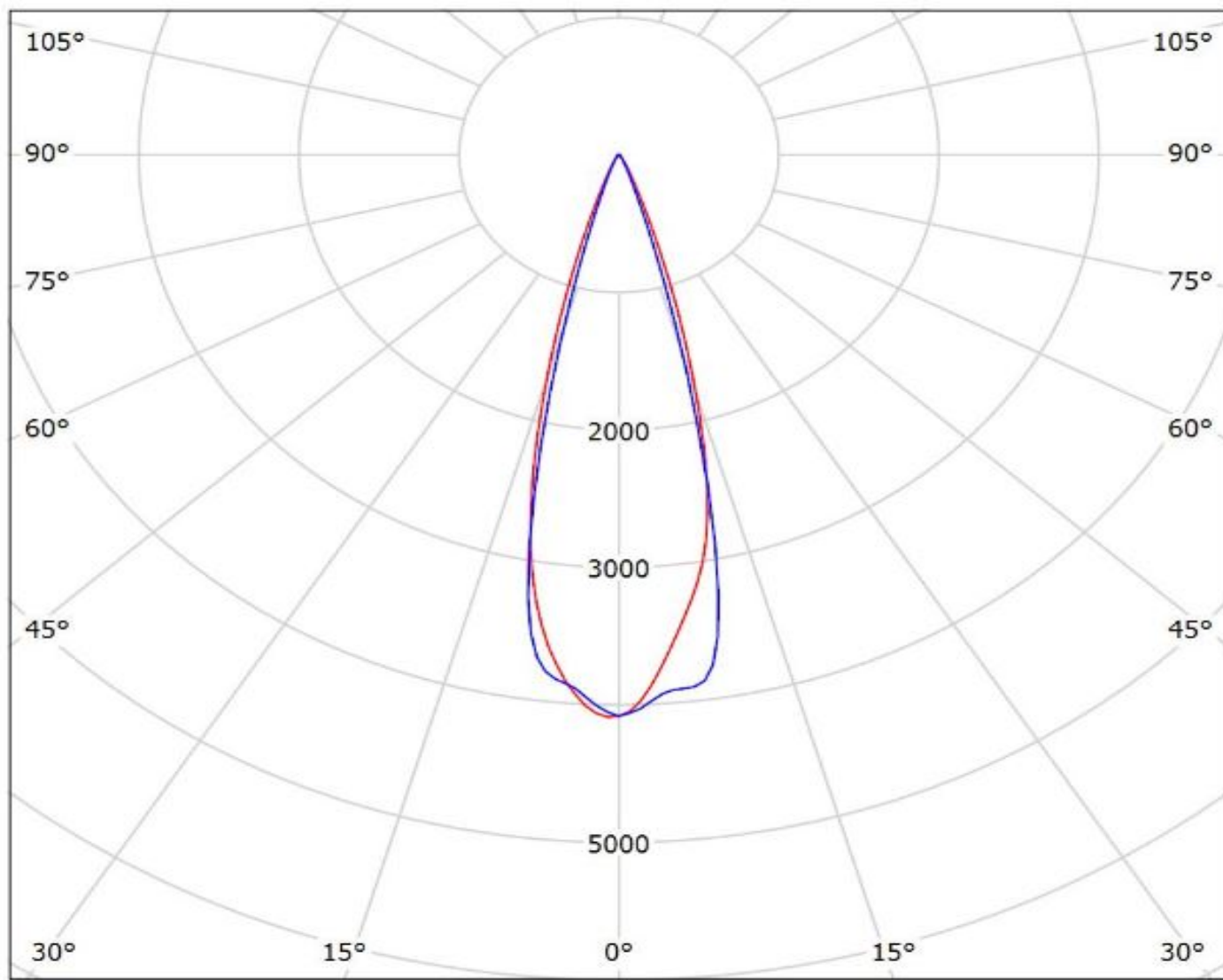

cd/klm

— C0 - C180

— C90 - C270

$\eta = 89\%$

Luminaire: LEDiL Oy CA12070_EMILY-M2_(NS9x383) Eff.88,5%
Lamps: 1 x Nichia NS9x383 (105lm@250mA)

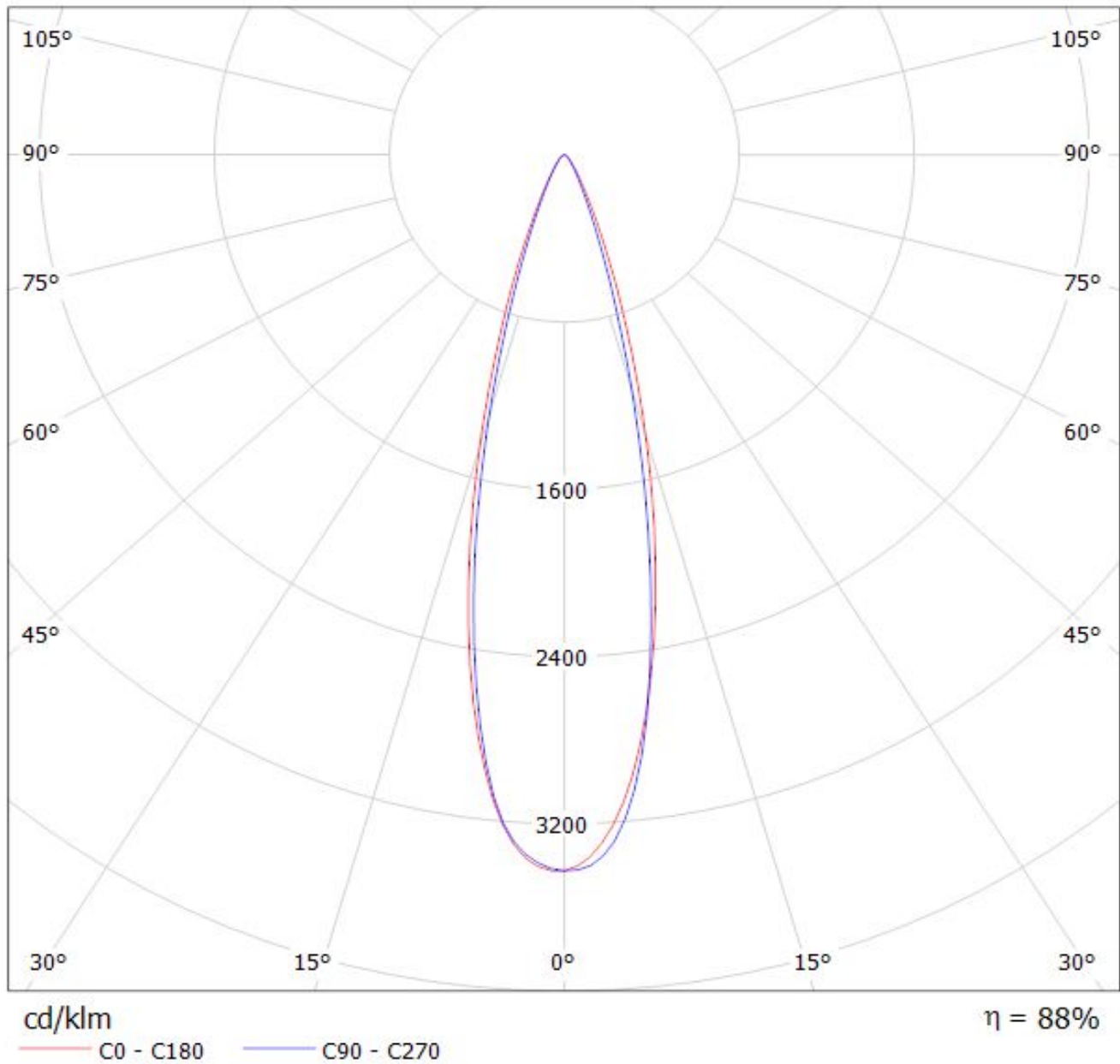

NOTE: The typical divergence will be changed by different color, chip size and chip position tolerance. The typical total divergence is the full angle measured where the luminous intensity is half of the peak value.