

THIS DRAWING IS UNPUBLISHED. RELEASED FOR PUBLICATION 20
 © COPYRIGHT 20 BY - ALL RIGHTS RESERVED.

LOC		DIST		REVISIONS			
P	LTR	DESCRIPTION	DATE	DWN	APVD		
-	-	A	FIRST RELEASED	16AUG2019	WH	DZ	

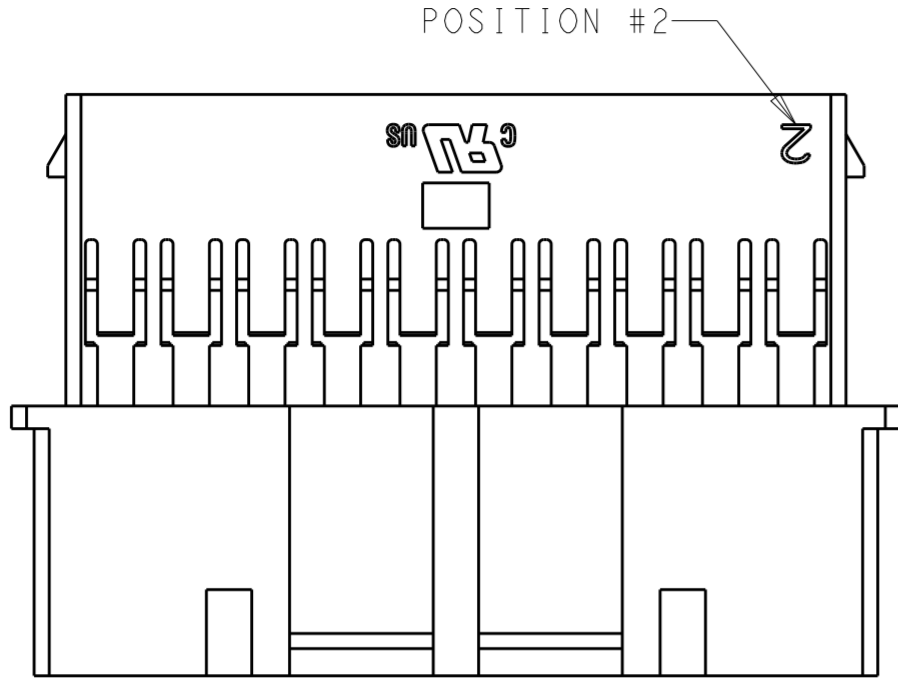

DUAL LATCH DETAIL FOR
1-2324582-8 THROUGH 4-2324582-0

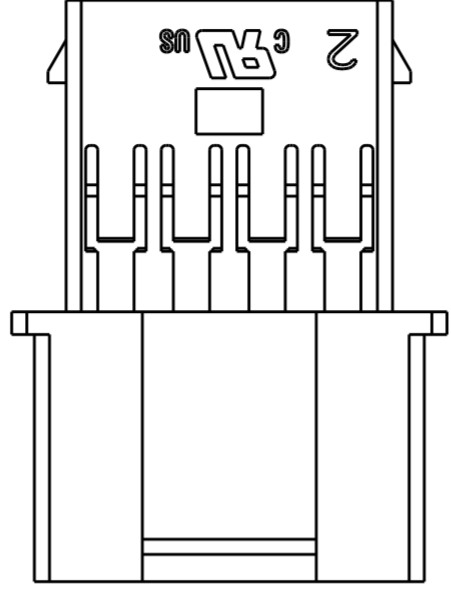

SINGLE LATCH DETAIL FOR
2324582-8 & 1-2324582-0

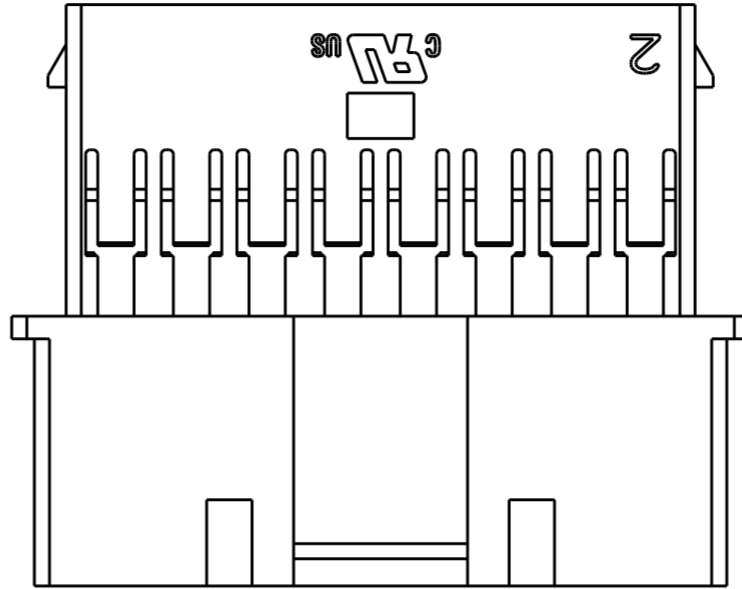

SINGLE LATCH DETAIL FOR
1-2324582-2 THROUGH 1-2324582-6

NOTES:

- 1. MATERIAL: NYLON 66, UL94-V0, COLOR: NATURAL
- 2. DIMENSIONS SHOWN REPRESENT PRODUCT IN DRY, AS MOLDED, CONDITION. ADDITIONAL 2% GROWTH DUE TO SUBSEQUENT MOISTURE ABSORPTION MAY OCCUR AND SHOULD BE ACCOUNTED FOR.
- 3. RECOMMENDED MATING PLUG: []-2324579-[]
- 4. THE HOUSING ACCEPTS TERMINALS: 2238007-1 OR 2238008-1
- 5. ACCEPT OPTIONAL TPA: []-1969541-[] OR []-2315219-[]

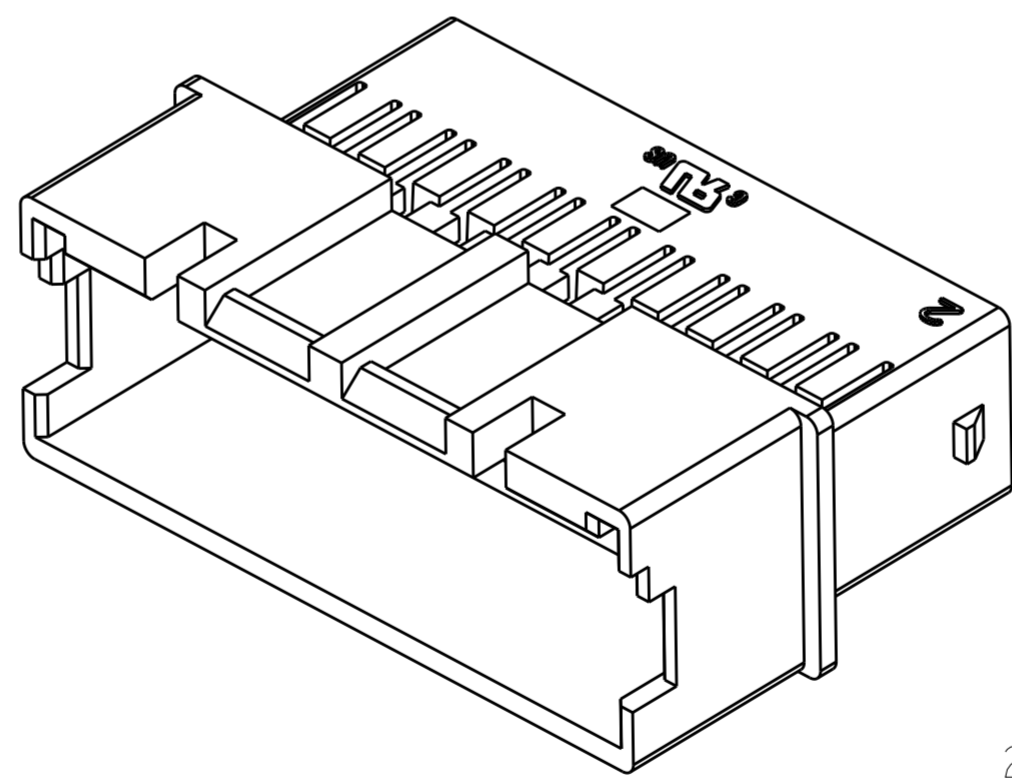
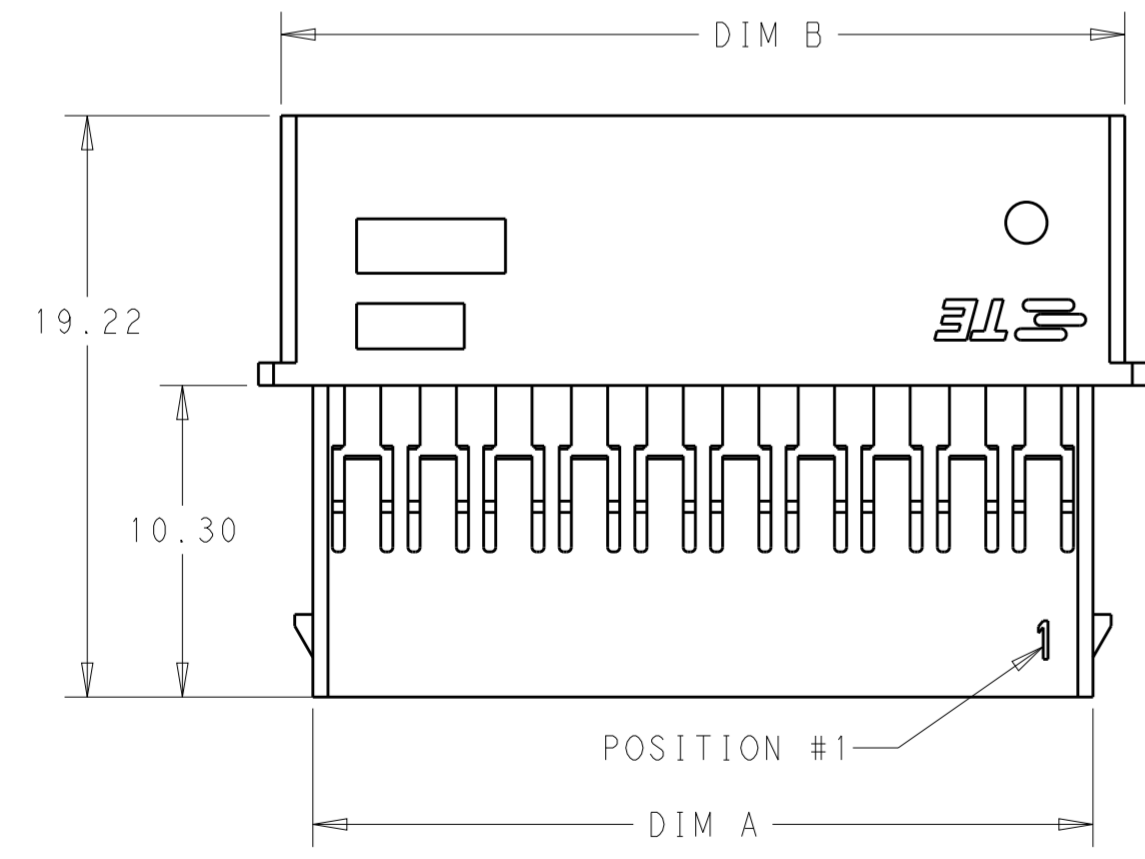
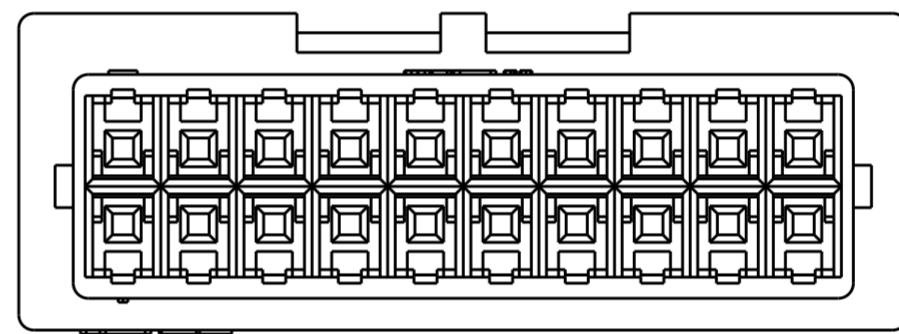
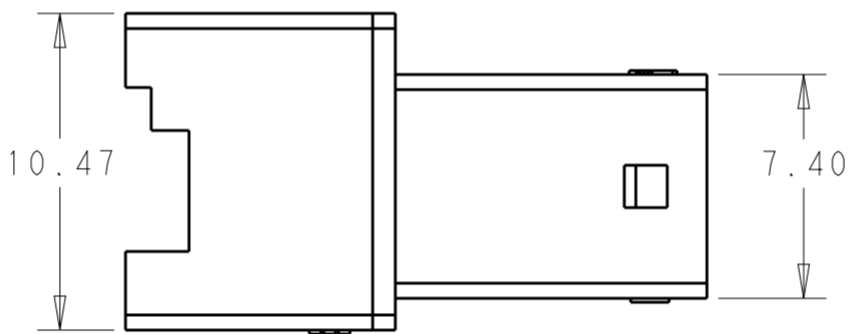
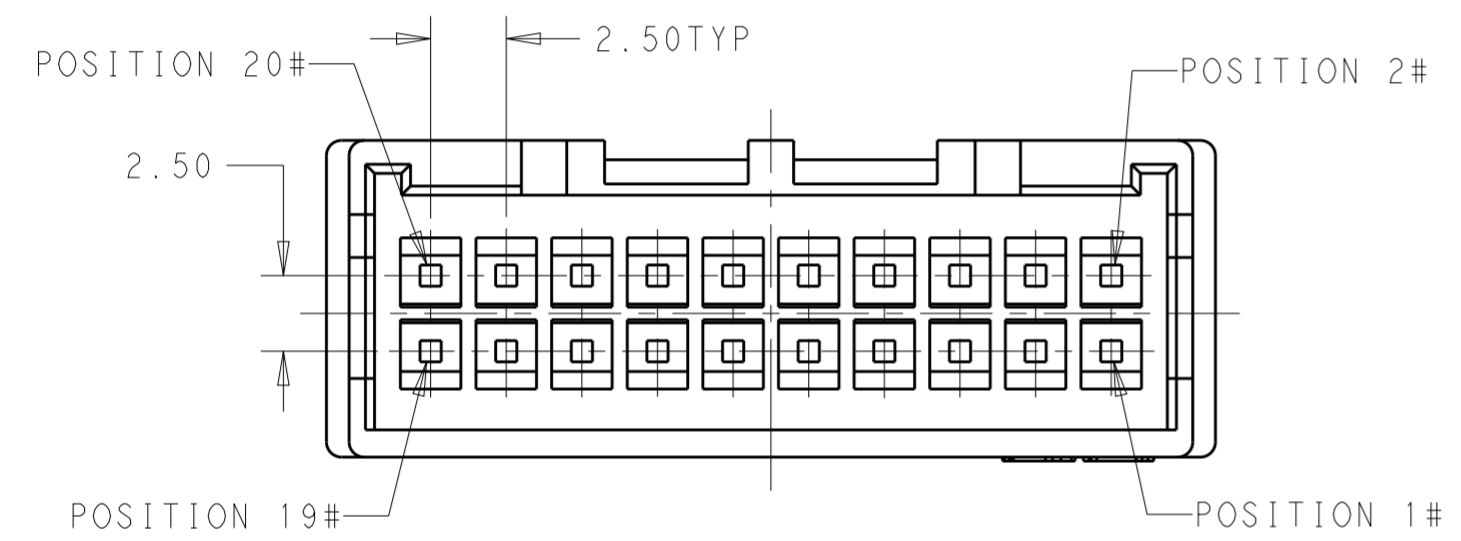

2-2324582-0 SHOWN

POS	DIM.B	DIM.A	PART NO.
40	52.89	50.79	4-2324582-0
38	50.39	48.29	3-2324582-8
36	47.89	45.79	3-2324582-6
34	45.39	43.29	3-2324582-4
32	42.89	40.79	3-2324582-2
30	40.39	38.29	3-2324582-0
28	37.89	35.79	2-2324582-8
26	35.39	33.29	2-2324582-6
24	32.89	30.79	2-2324582-4
22	30.39	28.29	2-2324582-2
20	27.89	25.79	2-2324582-0
18	25.39	23.29	1-2324582-8
16	22.89	20.79	1-2324582-6
14	20.39	18.29	1-2324582-4
12	17.89	15.79	1-2324582-2
10	15.39	13.29	1-2324582-0
8	12.89	10.79	2324582-8

THIS DRAWING IS A CONTROLLED DOCUMENT.

DIMENSIONS:	TOLERANCES UNLESS OTHERWISE SPECIFIED:	DWN 26AUG2018 WARREN HUO	TE Connectivity
mm	0 PLC ±- 1 PLC ±- 2 PLC ±0.25 3 PLC ±- 4 PLC ±- ANGLES ±5° FINISH	CHK 27AUG2018 DANIEL ZHANG	
		APVD 27AUG2018 DANIEL ZHANG	
		PRODUCT SPEC 108-106357	
MATERIAL		APPLICATION SPEC 114-13315	NAME CAP HOUSING, EP2.5 DUAL ROW WIRE TO WIRE, FREE HANGING
		WEIGHT -	SIZE A200779
		CUSTOMER DRAWING	DRAWING NO C-2324582
			RESTRICTED TO -
			SCALE N/A
			SHEET 1 OF 1
			REV A