

MATERIAL NUMBER	ENGINEERING NUMBER	WIRE RANGE	"L" MAX	"A" MIN	"B" MAX	MATERIAL	MATERIAL THICKNESS	TEMPERATURE RATING
192030165	A-T-302	22-18 (0.3-1.0mm ²)	.330 / (8.4)	.060 / (1.5)	.130 / (3.3)	COPPER	.032 / (0.8)	650F (342C)
192030172	B-T-304	16-14 (1.2-2.0mm ²)	.330 / (8.4)	.091 / (2.3)	.160 / (4.1)	COPPER	.032 / (0.8)	650F (342C)
192030169	C-T-303	12-10 (3.0-6.0mm ²)	.330 / (8.4)	.130 / (3.3)	.225 / (5.7)	COPPER	.040 / (1.0)	650F (342C)

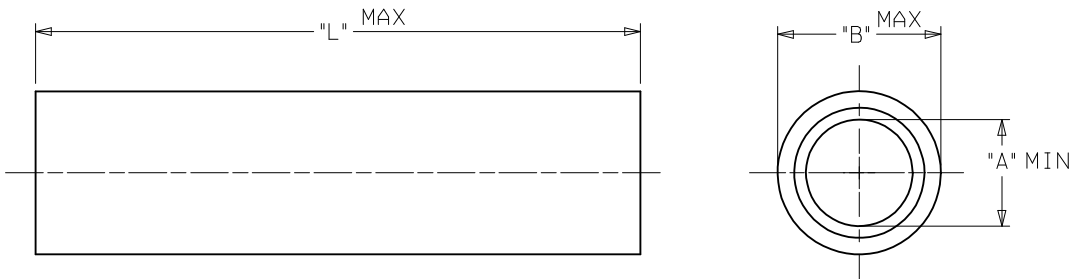

NOTES:
 1. PLATING: ELECTRO-NICKEL.
 2. ALL DIMENSIONS IN INCHES/(MM).
 3. RoHS COMPLIANT

RELEASE FOR PROD EC NO: ETC2007-0146 DRWN: JLOMASTRO 2006/10/11 CHKD: JMACNEIL 2006/10/11 APPR: JMACNEIL 2006/10/12	QUALITY SYMBOLS	GENERAL TOLERANCES (UNLESS SPECIFIED)	DIMENSION STYLE	SCALE	DESIGN UNITS	THIRD ANGLE PROJECTION
	▼=0 ▽=0	mm INCH 4 PLACES ± --- ± --- 3 PLACES ± --- ± .010 2 PLACES ± 0.25 ± .01 1 PLACE ± 0.3 ± --- ANGULAR ±1/2°	IN/MM	INCH	INCH	☉ □ THIRD ANGLE PROJECTION
	DESCRIPTION	DRAFT WHERE APPLICABLE MUST REMAIN WITHIN DIMENSIONS	DRAWN BY DATE JLOMASTRO 10/02/06 CHECKED BY DATE JMACNEIL 10/02/06 APPROVED BY DATE RDEROSS 10/04/06	TITLE	PARALLEL SPLICE VERSAKRIMP TEMP TERMS	
	REV	SEE CHART	MATERIAL NO.	DOCUMENT NO.	MOLEX INCORPORATED SD-19203-042	
A	SIZE B	THIS DRAWING CONTAINS INFORMATION THAT IS PROPRIETARY TO MOLEX INCORPORATED AND SHOULD NOT BE USED WITHOUT WRITTEN PERMISSION				SHEET NO.
						1 OF 1