

SPECIFICATION CONTROL DRAWING

THIS DRAWING CONTAINS INFORMATION PROPRIETARY TO RF INDUSTRIES, LTD. ANY UNAUTHORIZED USE OF THIS DRAWING IS EXPRESSLY PROHIBITED. ANY VIOLATION IS PUNISHABLE UNDER U.S. COPYRIGHT LAWS.

REV	DESCRIPTION	DWN	DATE	APPROVED
A	ENGINEERING RELEASE	KMM	3/6/99	R. RICE

ALL DIMENSIONS ARE REFERENCE ONLY

008974

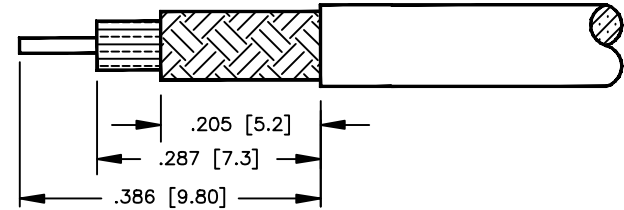
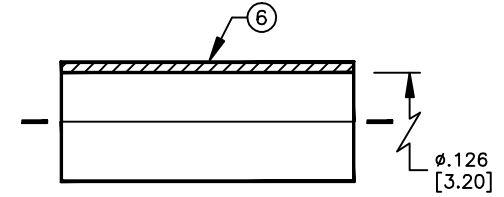
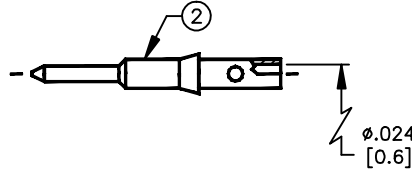
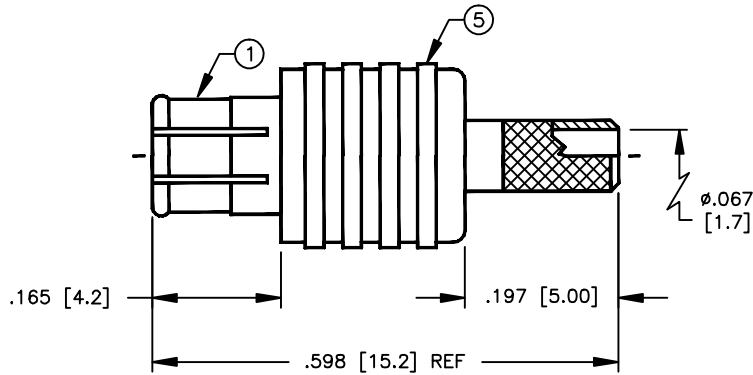

SUGGESTED STRIPPING INSTRUCTIONS

SUGGESTED CRIMP DIES: .130

PIN TO BE SOLDERED

SPECIFICATIONS:

IMPEDANCE: 50 OHMS
 WORKING VOLTAGE: 335 VRMS @ SEA LEVEL
 FREQUENCY RANGE: 0-6 GHz
 INSERTION LOSS: -.1 dB MAX @ 1 GHz
 VSWR MAX: 1.3:1 @ 6 GHz
 FOR RG-316/U DOUBLE SHIELD CABLE

DIMENSIONS ARE IN INCHES AND [MILLIMETERS]

UNLESS OTHERWISE NOTED TOLERANCES ARE:
 DECIMALS DIAMETER

RF connectors
 DIVISION OF RF INDUSTRIES, LTD.

7610 MIRAMAR RD
 SAN DIEGO, CA 92126
 (619)549-6340
 (619)549-6345 FAX

RMX-8000-B1

MCX CRIMP PLUG

ITEM	DESCRIPTION	QTY	MATERIAL	FINISH
6	FERRULE [FER-1BKJ]	1	COPPER	NICKEL
5	HOUSING	1	BRASS	NICKEL
4	DIELECTRIC	1	PTFE	NONE
3	DIELECTRIC	1	PTFE	NONE
2	PIN	1	BRASS	GOLD
1	BODY	1	BeCu	NICKEL

DRAWN	K. MAXWELL	3/6/99
CHECKED		
ORJ DRAWN	K. MAXWELL	3/6/99
APPROVALS		
DATE		

SIZE	CABLE GROUP	DWG NO.	REV
A	B1	9051	A
SCALE:	4 : 1	CAD FILE	13ARC B
		SHEET	1 OF 1