

THIS DRAWING IS UNPUBLISHED. RELEASED FOR PUBLICATION 20
 © COPYRIGHT 20 BY - ALL RIGHTS RESERVED.

LOC -
 DIST -

| REVISIONS | | | | | |
|-----------|-----|---------------------------|-----------|-----|------|
| P | LTR | DESCRIPTION | DATE | DWN | APVD |
| | B | PLATING INFORMATION ADDED | 16JUL2019 | RK | PS |
| | | | | | |
| | | | | | |

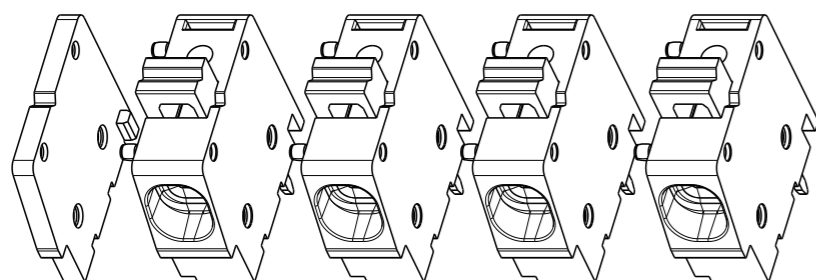

SCALE 2:1
 -4 AS SHOWN

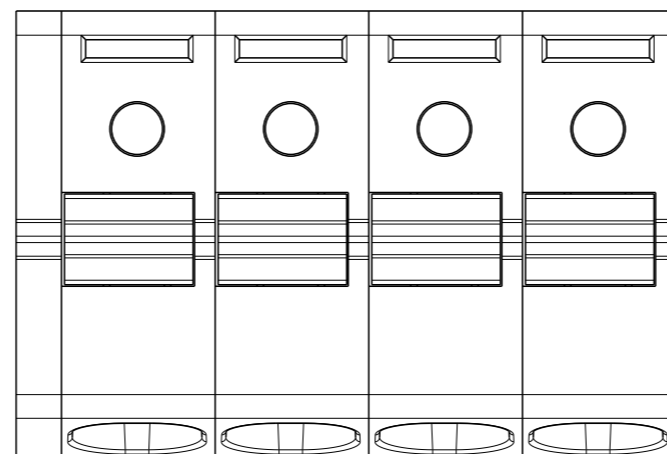

DIM "L"

1.60

5.08

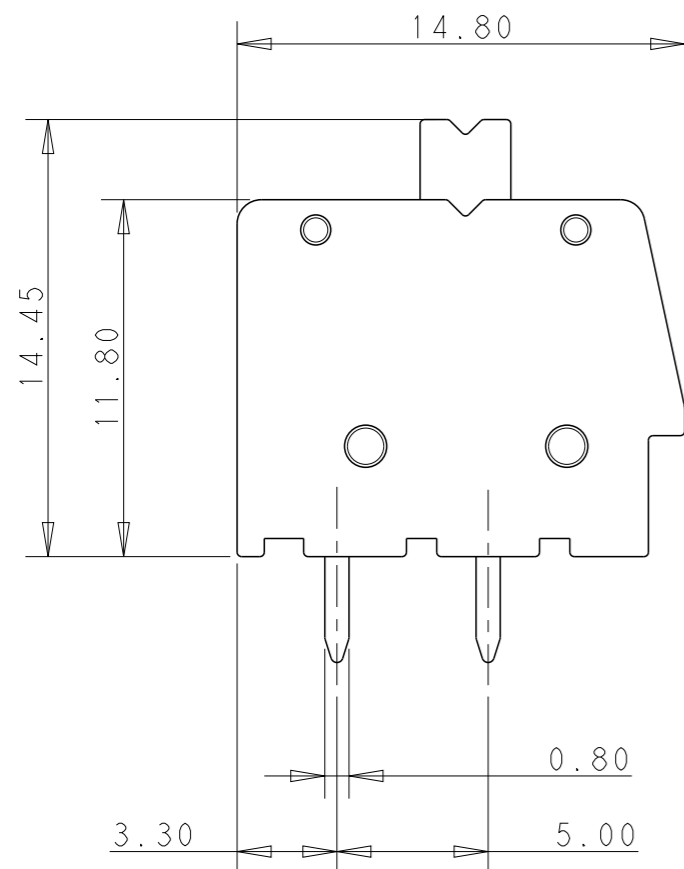

0.50

1.33

1.25

2.50

- MATERIAL:
 HOUSING - PA66 , UL94 V0
 CLAMPING SPRING - STAINLESS STEEL
 PIN - COPPER ALLOY -BRIGHT TIN PLATED
- MECHANICAL:
 MIN. PC BOARD HOLES DIAMETER : 1.2 mm
 MAX. PC BOARD THICKNESS : 2.4 mm
 WIRE STRIPPING LENGTH : 11.5 mm
- ELECTRICAL:
 WIRE RANGE : 12-30 AWG
 RATED VOLTAGE : 300V
 RATED CURRENT : 16A
 CONTACT RESISTANCE : <15 m Ohm
 INSULATION RESISTANCE : >1000 M Ohm (500V DC)
- OPERATING TEMPERATURE RANGE : -40°C TO +105°C

PCB LAYOUT FOR-4
 AS SHOWN

Ø1.00^{-0.20}

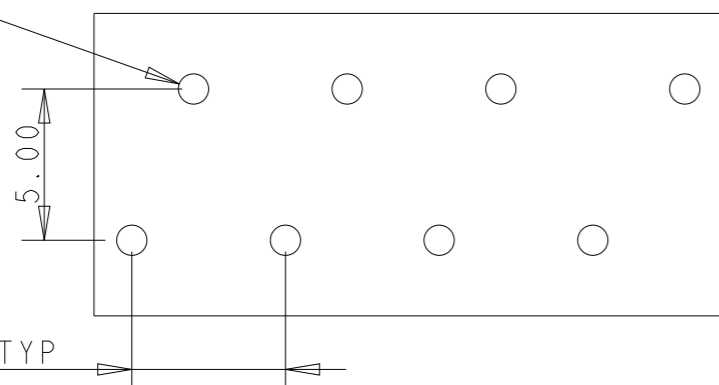

5.08 TYP

| | | |
|---------|------|-------------|
| 62.46 | 12 | 1-1986775-2 |
| 57.38 | 11 | 1-1986775-1 |
| 52.30 | 10 | 1-1986775-0 |
| 47.22 | 9 | 1986775-9 |
| 42.14 | 8 | 1986775-8 |
| 37.06 | 7 | 1986775-7 |
| 31.98 | 6 | 1986775-6 |
| 26.90 | 5 | 1986775-5 |
| 21.82 | 4 | 1986775-4 |
| 16.74 | 3 | 1986775-3 |
| 11.66 | 2 | 1986775-2 |
| DIM "L" | POLE | PART NO |

THIS DRAWING IS A CONTROLLED DOCUMENT.

| DIMENSIONS: | TOLERANCES UNLESS OTHERWISE SPECIFIED: |
|-------------|--|
| mm | |
| | 0 PLC ±0.5 |
| | 1 PLC ±0.25 |
| | 2 PLC ±0.25 |
| | 3 PLC ±0.25 |
| | 4 PLC ±0.25 |
| | ANGLES ±1° |
| MATERIAL | FINISH |

| | |
|------------------|-----------|
| DWN | 12OCT2012 |
| KIRAN HOLAL | |
| CHK | 12OCT2012 |
| MARK BRUBAKER | |
| APVD | 12OCT2012 |
| MARK BRUBAKER | |
| PRODUCT SPEC | |
| APPLICATION SPEC | |
| WEIGHT | |

| | | | | | |
|-----------------|-----------|------------|---------------|--|--|
| TE Connectivity | | | | NAME | |
| | | | | SPRING TYPE, SIDE WIRE ENTRY TERMINAL BLOCK SIDE STACKABLE 02-25 POLES PITCH 5.08MM | |
| SIZE | CAGE CODE | DRAWING NO | RESTRICTED TO | | |
| A3 | 00779 | C-1986775 | | | |

CUSTOMER DRAWING SCALE 1:4 SHEET 1 OF 1 REV B