

Apr.1.2017 Copyright 2017 HIROSE ELECTRIC CO., LTD. All Rights Reserved.

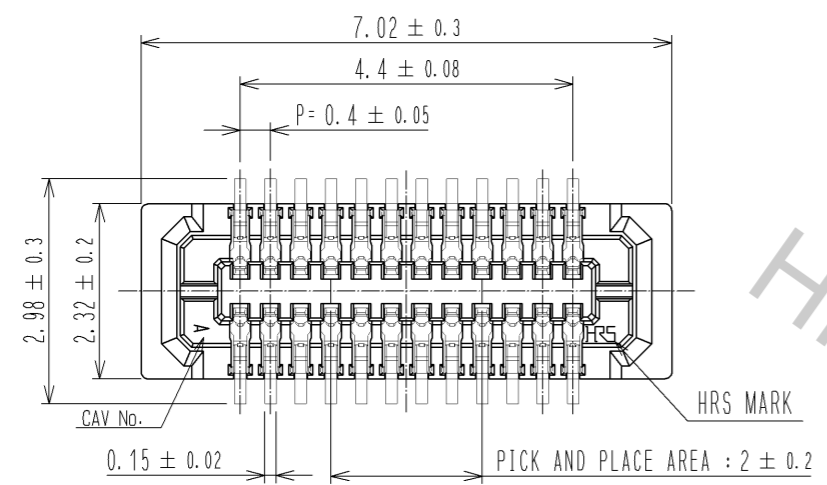

◆ RECOMMENDED PCB LAYOUT (MOUNTING SURFACE SIDE)

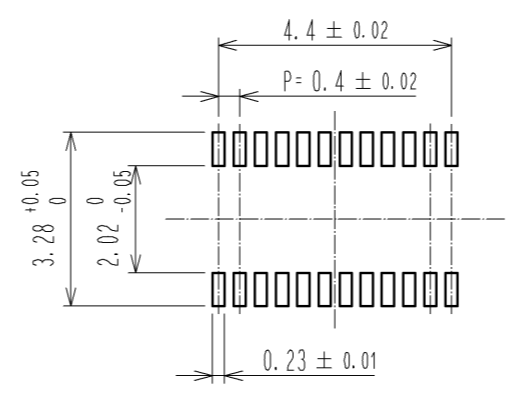

◆ RECOMMENDED METAL MASK DIMENSIONS METAL MASK THICKNESS : 0.12mm

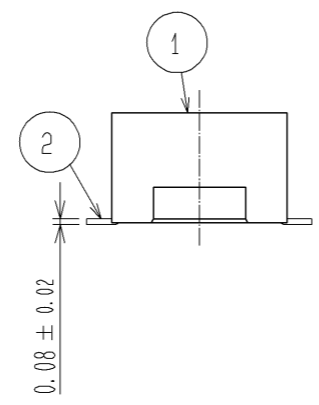
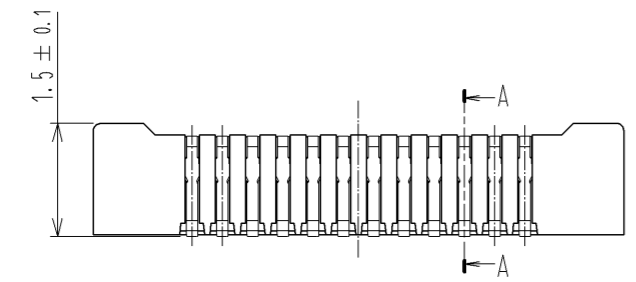
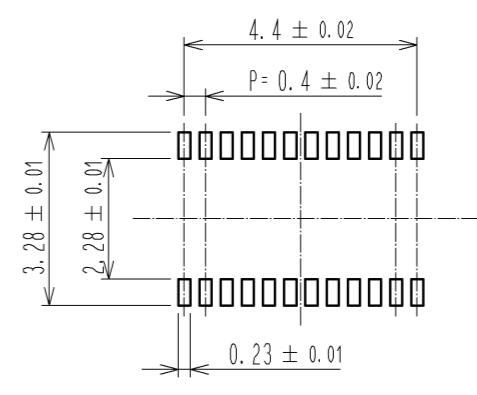

◆ RECOMMENDED METAL MASK DIMENSIONS METAL MASK THICKNESS : 0.1mm

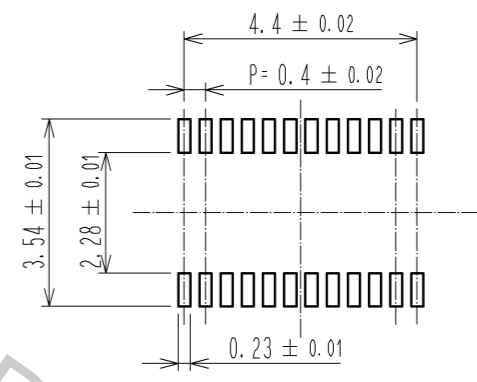

A-A (FREE SIZE)

ENGAGEMENT FIGURE (FREE SIZE)

NOTE 1. ALL LEADS CO-PLANARITY SHALL BE 0.1mm MAX.
 ② CONTACT PLATING SPECIFICATIONS.
 CONTACT AREA : GOLD 0.05 μm MIN.
 SMT LEAD : GOLD 0.05 μm MIN.
 UNDERPLATING : NICKEL 1 μm MIN.
 (SURFACE : SEALING)

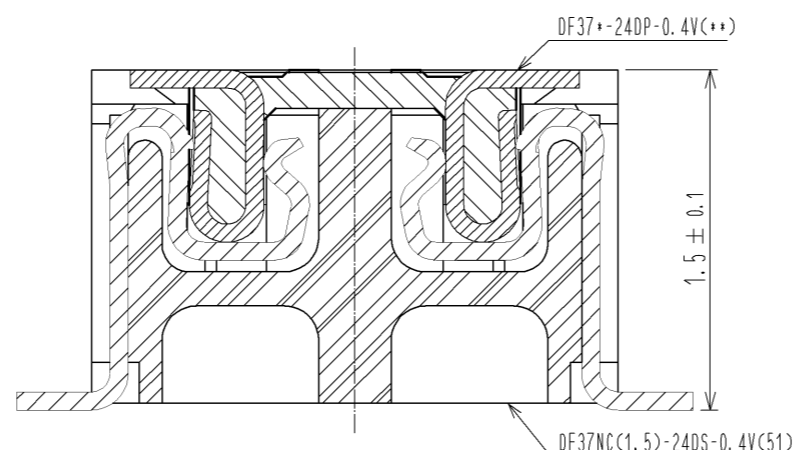
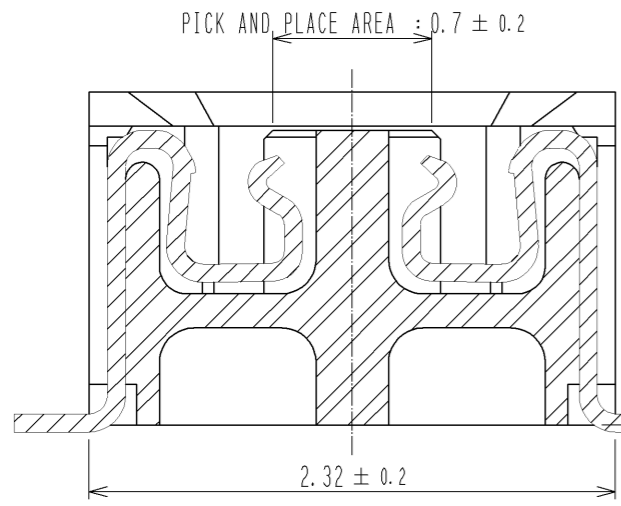

3	PS	CLEAR(EMBOSSD CARRIER TAPE)	6	PS	REINFORCEING COLLAR			
2	PHOSPHOR BRONZE	②	5	PS	PLASTIC REEL(BLACK)			
1	LCP	UL94V-0, BLACK	4	POLYESTER	CLEAR(COVER TAPE)			
NO.	MATERIAL	FINISH, REMARKS	NO.	MATERIAL	FINISH, REMARKS			
UNITS	mm	SCALE	FREE	COUNT	DESCRIPTION OF REVISIONS	DESIGNED	CHECKED	DATE
APPROVED : KH. IKEDA		11.11.07		DRAWING NO.		EDC3-339438-01		
CHECKED : TS. MIYAZAKI		11.11.05		PART NO.		DF37NC(1.5)-24DS-0.4V(51)		
DESIGNED : NY. YAMASHIRO		11.11.05		CODE NO.		CL684-3603-5-51		
DRAWN : NY. YAMASHIRO		11.11.05				1/2		

EMBOSSED CARRIER TAPE PACKAGING (FREE SIZE)

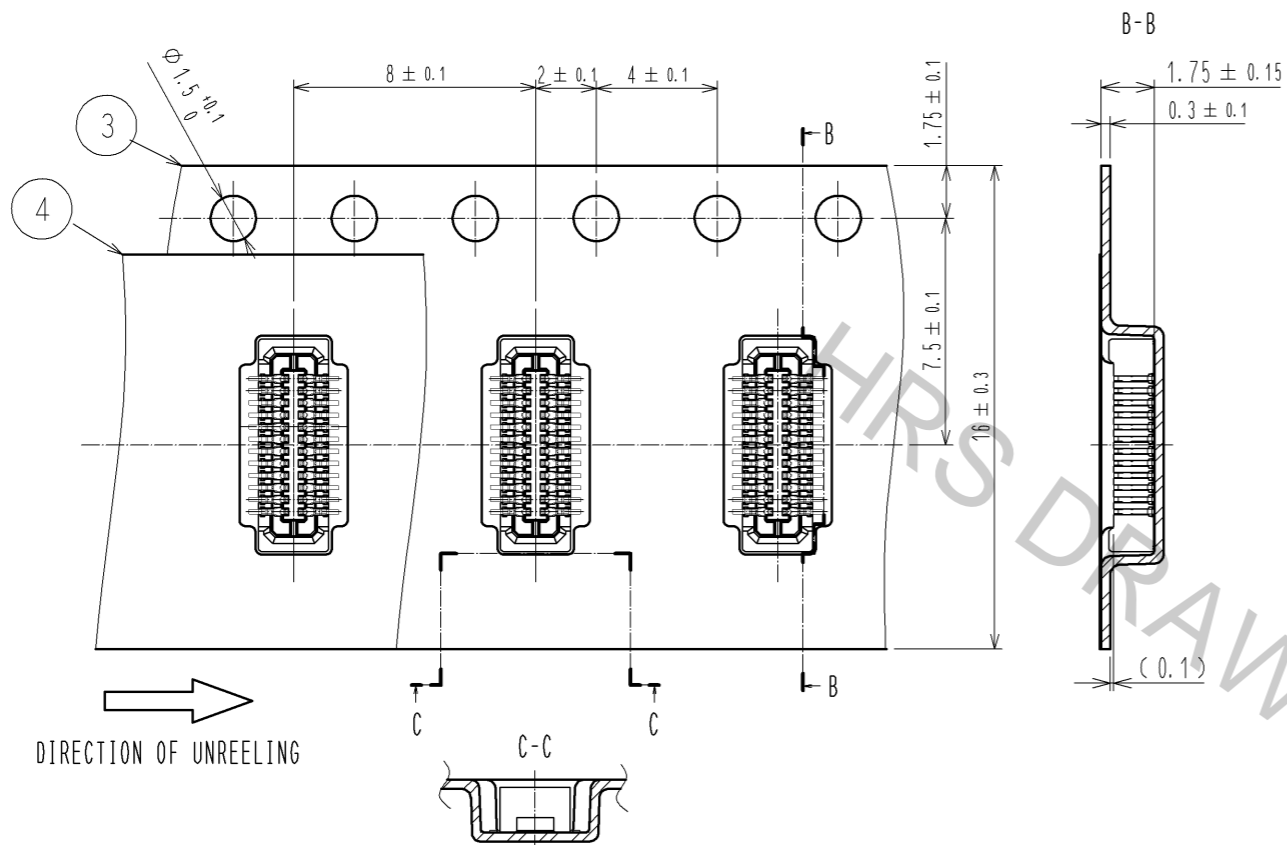

RECOMMENDED REFLOW TEMPERATURE PROFILE USING LEAD-FREE SOLDER PASTE.

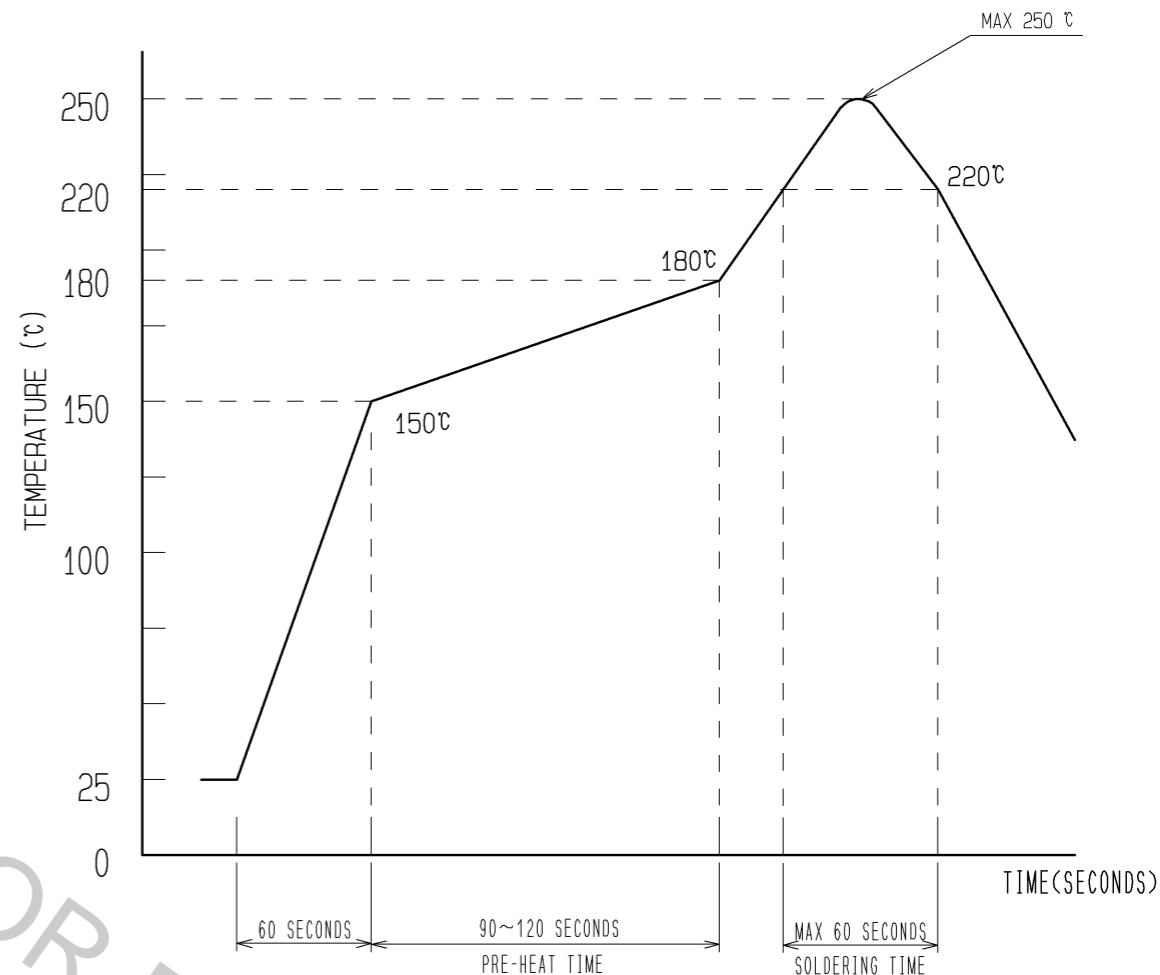

STYLE AND DIMENSION OF REEL (FREE SIZE)

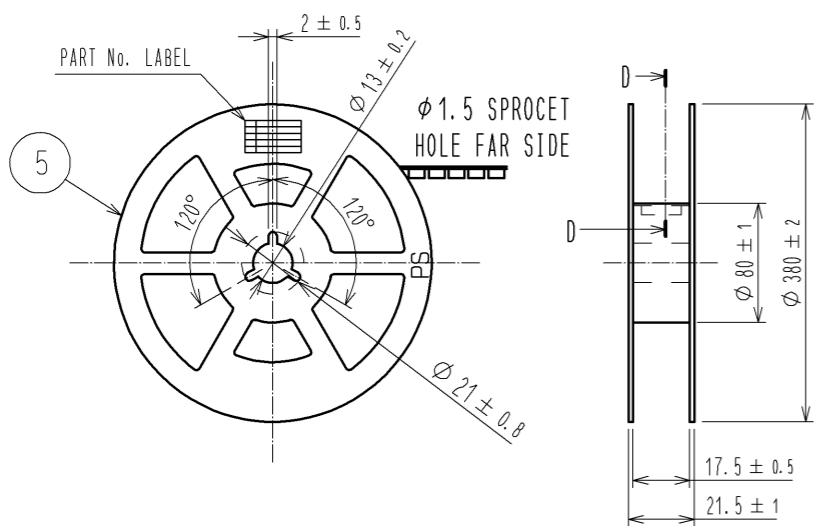

DETAIL OF PART No. LABEL

SUPPLIER	
QUANTITY	
PART NO.	
CODE NO.	
DATE OF MANUFACTURED	
製造年月日	年 月 日
製品コード	CL684-3603-5-51
製品名	DF37NC(1.5)-24DS-0.4V(51)
数量	5000個
納入者	ヒロセ電機(株)

1) REFLOW TIME
 REFLOW METHOD: IR REFLOW
 NUMBER OF REFLOW CYCLES: 2 CYCLES MAX.
 DURATION ABOVE 220 °C. 60 SEC. MAX.
 (PEAK TEMPERATURE: 250°C MAX.)

2) PRE-HEAT TIME
 PRE-HEAT TEMPERATURE(MIN) :150 °C
 PRE-HEAT TEMPERATURE(MAX) :180 °C
 PRE-HEAT TIME : 90~120 sec.

NOTES 3) THIS TEMPERATURE PROFILE IS PER THE CONDITIONS SHOWN ABOVE. ADDITIONAL FACTORS, SUCH AS SOLDER PASTE TYPE, PCB SIZE AND OTHER MOUNTED COMPONENTS COULD AFFECT THE PROFILE. THEREFORE, A THOROUGH EVALUATION OF MOUNTING CONDITION IS REQUIRED PRIOR TO PRODUCTION. TEMPERATURE IS MEASURED AT CONTACT LEAD.

- 4. PER REEL 5000 CONNECTORS.
- 5. THE DIMENSIONS IN PARENTHESSES ARE FOR REFERENCE.
- 6) REFER TO JIS C 0806(PACKING OF COMPONENTS FOR AUTOMATIC HANDLING)
- 7) DETAIL OF PART No. LABEL IS WRITTEN IN JAPANESE.
- 8) AFTER FINISHING THE REELING, COVER THE SURFACE WITH 2 METERS OF REINFORCING COLLAR AND THE DOWN AT THE END.

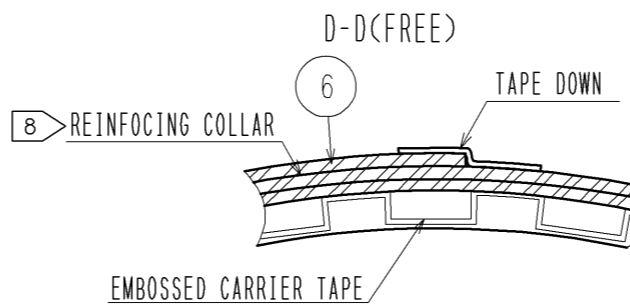

HRS	DRAWING NO.	EDC3-339438-01
	PART NO.	DF37NC(1.5)-24DS-0.4V(51)
	CODE NO.	CL684-3603-5-51
		\triangle 2/2