

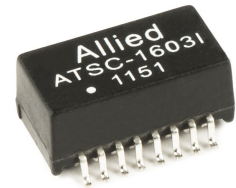

- 16 Pin SMD Line Interface Filter Module
- Cw/w: 30pF Max 100KHz, 0.1V
- Primary Pins: 9-11, 1-3
- Operating Temp: -40°C to +85°C
- Telecom, WAN Applications
- Halogen Free 3



Electrical Specifications @ 25°C

Pri OCL(mH Min) @ 10KHz, 0.1V	Pri LL(μH Min) @ 100KHz, 0.1V	Turns Ratio Chip : Cable (±5%)		DCR (Ω) Max	Isolation Hi-Pot (Vrms)
		(1-3) : (16-14)	(6-8) : (11-9)		
1.00	0.8	1CT : 2.4CT	1CT : 1CT	1.4	1500

All specifications subject to change without notice.

MECHANICAL

Dimensions: $\frac{\text{inch}}{\text{(mm)}}$

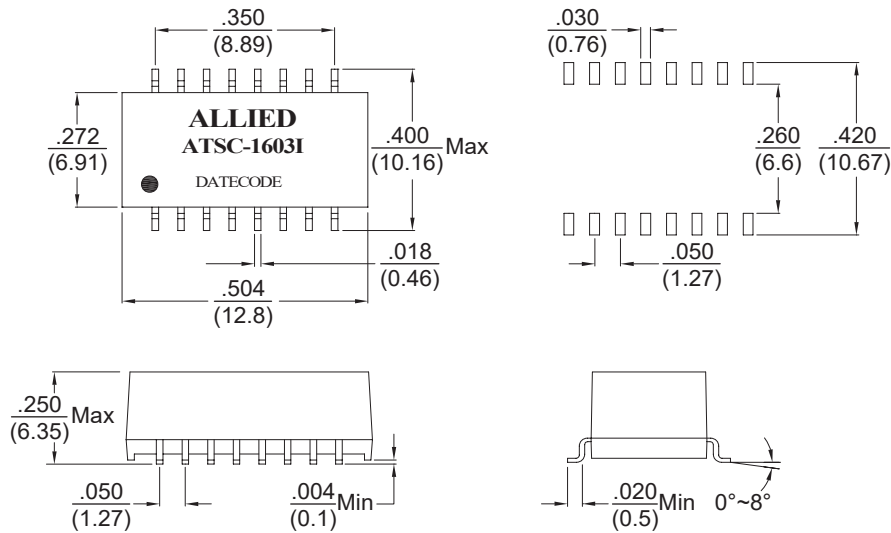

Unless otherwise specified, all tolerances are ±.010(0.25)

SCHEMATICS

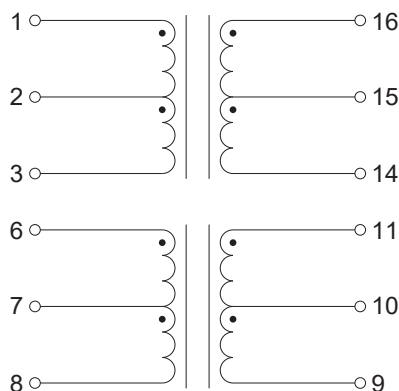



Packaging Specifications

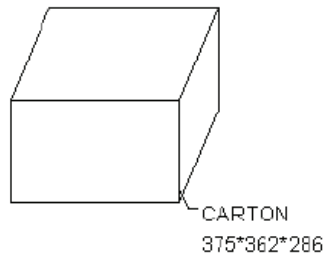
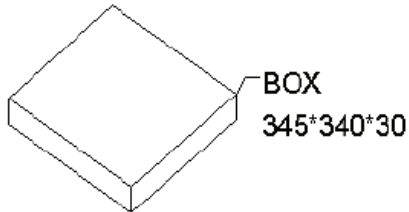
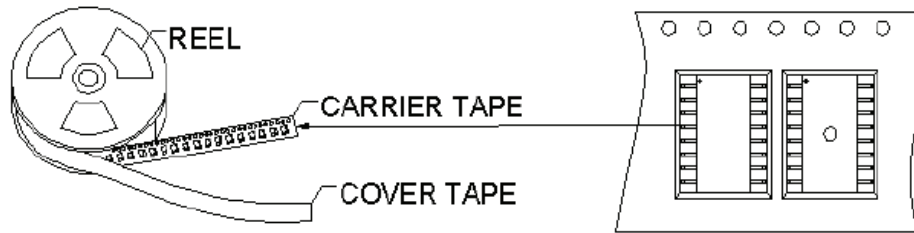

0.6g/pcs

:3.6kg

6.9kg

750pcs/Reel

750pcs/Box

6000pcs/CARTON

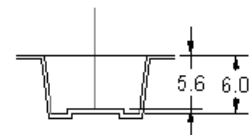
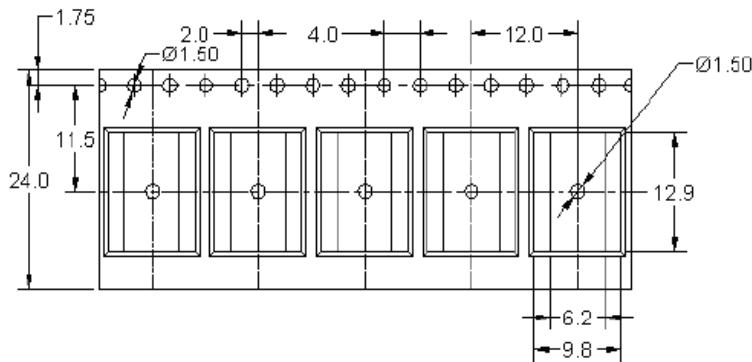

unit:mm