

## SUMMARY

### # Wires

Low	2
High	0
Coax	0
Triax	0
Quad	0
Fiber	0
Fluidic	0



*Image is for illustrative purpose only*

### Download

- [Request a quote](#)
- [PCB Eagle Pattern](#)
- [PCB Altium Pattern](#)
- [Catalog](#)

Series	P
Termination type	Female print 90° PCB
IP rating	50
Cable Ø	0.00 - 0.00 mm
Matching parts	PAG.M0.2GL.AC39Z
Status	
Alternative part	

## TECHNICAL DETAILS

### Mechanics

Shell Style/Model	PK*: Fixed receptacle with two nuts (back panel mounting), 90° print contacts
Keying	1 key (alpha=0; Plug: male contact; Receptacle: female contact)
Housing Material	PSU (Polysulfone), gray
Cable Fixing	∅ 0 - 0 mm
Variant	Z : without front nut

### Performance

Configuration	1P.M02 : 2 Low Voltage
Insulator	
Rated Current	10 Amps

### Specifications

Contact Type: Print (elbow)
Max. Matings: 2000
Contact Dia.: 1.3 mm (0.0512in)
R (max): 3.5 mOhm
Test voltage (kV rms) Contact-contact: 1.2
Air clearance min. (mm) or Creepage distance min. (mm): 1.3

## Others

F ret (min): 50 N  
F ret (max): 150 N  
IP Rating: 50

---

# DRAWINGS

## Draws

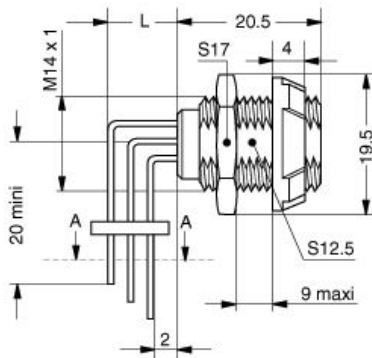

## Dimensions

	A	Lmax
mm.	19.5	33.5
in.	0,77	1,32

---

# RECOMMENDED BY LEMO

## Tools

None

## Cables