



STANDARD EXECUTIONS

- **DVB.7:** bushing with threaded blind hole and base plate in polished zinc-plated steel, vibration-damper body in natural rubber NR, black colour, hardness 40, 55, 70 Shore A ± 5 .
- **DVB.7-SST:** bushing with threaded blind hole and base plate in AISI 304 stainless steel, vibration-damper body in natural rubber NR, black colour, hardness 55 Shore A ± 5 .

FEATURES AND APPLICATIONS

DVB. rubber buffers have been designed to damp vibrations, shocks and noises produced by moving bodies or non-balanced vibrating masses of equipment and machines.

DVB elements are generally used as a bumper or as a limit stop for the absorption of vibrations.

Vibrations can cause:

- malfunctioning and reduction of the machine lifespan and/or of the adjacent ones;
- damage to operator's health;
- noise.

Load diagrams for each single code are available on request.
See Technical data and guidelines for the choice(on page).

SPECIAL EXECUTIONS ON REQUEST

Natural rubber NR, hardness 40, 70 Shore A ± 5 for the executions with AISI 304 stainless steel base.



Conversion Table 1 mm = 0.039 inch			
D		L	
mm	inch	mm	inch
20	0.79	17	0.67
25	0.98	20	0.79
32	1.26	22	0.87
38	1.50	35	1.38
43	1.69	40	1.57
50	1.97	50	1.97
60	2.36		

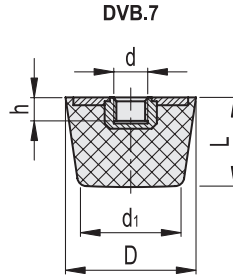

DVB.7 - 20 - 17 - M5 - 55
 D L d Shore A

METRIC

Description	D	L	d	d1	h	△	Hardness 40 Shore A				Hardness 55 Shore A				Hardness 70 Shore A			
							Code	Max load [N]	Max. deflection [mm]	Stiffness [N/mm]	Code	Max load [N]	Max. deflection [mm]	Stiffness [N/mm]	Code	Max load [N]	Max. deflection [mm]	Stiffness [N/mm]
DVB.7-20-17-M5-*	20	17	M5	10	5	12	432301	207	4.25	49	432101	253	4.25	60	432501	311	4.25	73
DVB.7-20-17-M6-*	20	17	M6	10	6	18	432302	207	4.25	49	432102	253	4.25	60	432502	311	4.25	73
DVB.7-25-17-M6-*	25	17	M6	19	6	22	432303	289	4.25	68	432103	358	4.25	84	432503	454	4.25	107
DVB.7-32-22-M8-*	32	22	M8	24	8	33	432311	411	5.5	75	432111	506	5.5	92	432511	673	5.5	122
DVB.7-38-35-M8-*	38	35	M8	30	8	46	432321	604	8.75	69	432121	893	8.75	102	432521	1104	8.75	126
DVB.7-38-35-M10-*	38	35	M10	30	10	56	432331	604	8.75	69	432131	893	8.75	102	432531	1104	8.75	126
DVB.7-43-50-M10-*	43	50	M10	30	10	72	432341	1327	12.5	106	432141	2011	12.5	161	432541	3027	12.5	242
DVB.7-50-20-M10-*	50	20	M10	40	10	61	432351	2763	5	553	432151	3570	5	714	432551	4875	5	975
DVB.7-60-40-M10-*	60	40	M10	40	10	93	432361	1685	10	169	432161	2101	10	210	432561	3231	10	323

DVB.7-SST

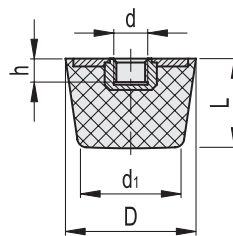

DVB.7 - 20 - 17 - SST - M5 - 55
 D L Stainless steel d Shore A

INOX STAINLESS STEEL METRIC

Description	D	L	d	d1	h	△	Hardness 40 Shore A				Hardness 55 Shore A				Hardness 70 Shore A			
							Code	Max load [N]	Max. deflection [mm]	Stiffness [N/mm]	Code	Max load [N]	Max. deflection [mm]	Stiffness [N/mm]	Code	Max load [N]	Max. deflection [mm]	Stiffness [N/mm]
DVB.7-20-17-SST-M5-55	20	17	M5	10	5	12	ON REQUES	207	4.25	49	432701	253	4.25	60	ON REQUES	311	4.25	73
DVB.7-20-17-SST-M6-55	20	17	M6	10	6	18	ON REQUES	207	4.25	49	432702	253	4.25	60	ON REQUES	311	4.25	73
DVB.7-25-17-SST-M6-55	25	17	M6	19	6	22	ON REQUES	289	4.25	68	432703	358	4.25	84	ON REQUES	454	4.25	107
DVB.7-32-22-SST-M8-55	32	22	M8	24	8	33	ON REQUES	411	5.5	75	432711	506	5.5	92	ON REQUES	673	5.5	122
DVB.7-38-35-SST-M8-55	38	35	M8	30	8	46	ON REQUES	604	8.75	69	432721	893	8.75	102	ON REQUES	1104	8.75	126
DVB.7-38-35-SST-M10-55	38	35	M10	30	10	56	ON REQUES	604	8.75	69	432731	893	8.75	102	ON REQUES	1104	8.75	126
DVB.7-43-50-SST-M10-55	43	50	M10	30	10	72	ON REQUES	1327	12.5	106	432741	2011	12.5	161	ON REQUES	3027	12.5	242
DVB.7-50-20-SST-M10-55	50	20	M10	40	10	61	ON REQUES	2763	5	553	432751	3570	5	714	ON REQUES	4875	5	975
DVB.7-60-40-SST-M10-55	60	40	M10	40	10	93	ON REQUES	1685	10	169	432761	2101	10	210	ON REQUES	3231	10	323

- 1
- 2
- 3
- 4
- 5
- 6
- 7
- 8
- 9
- 10
- 11
- 12
- 13
- 14
- 15
- 16
- 17
- 18

Vibration damping elements