

THIS DRAWING IS A CONTROLLED DOCUMENT.

THIS INFORMATION IS CONFIDENTIAL AND PROPRIETARY TO TYCO ELECTRONICS CORPORATION AND ITS WORLDWIDE SUBSIDIARIES AND AFFILIATES. IT MAY NOT BE DISCLOSED TO ANY OTHER PARTY WITHOUT THE EXPRESS WRITTEN AUTHORIZATION OF TYCO ELECTRONICS CORPORATION, HARRISBURG, PENNSYLVANIA, USA.

PART NUMBER	REV	FIRST USED	POWER UNIT	FEED TYPE
1855521-1	C	-	LEADMAKER	MECH POST FEED

TERMINAL NAME:	
.250 FLAG FASTON RECEPTACLE	60851
	42563-6
	42563-8
	42563-9
TERM APPL SPEC 114-2078	

CRIMPING DATA			
PAD LTR	CRIMP HEIGHT	WIRE SIZE	REF SETTING
A	.089±.002	10	B0
B	.075±.002	12	D4
C	NOT	USED	-
D	NOT	USED	-
CRIMP	SIZE	TYPE	RANGE
WIRE	.200	TAB LOCK	12-10
INSUL	.220	0	.110-.210
FEED	APPL INST	SET UP GAGE	LAYOUT
.770	A18031	-	-
WIRE STRIP LENGTH .205-.235			

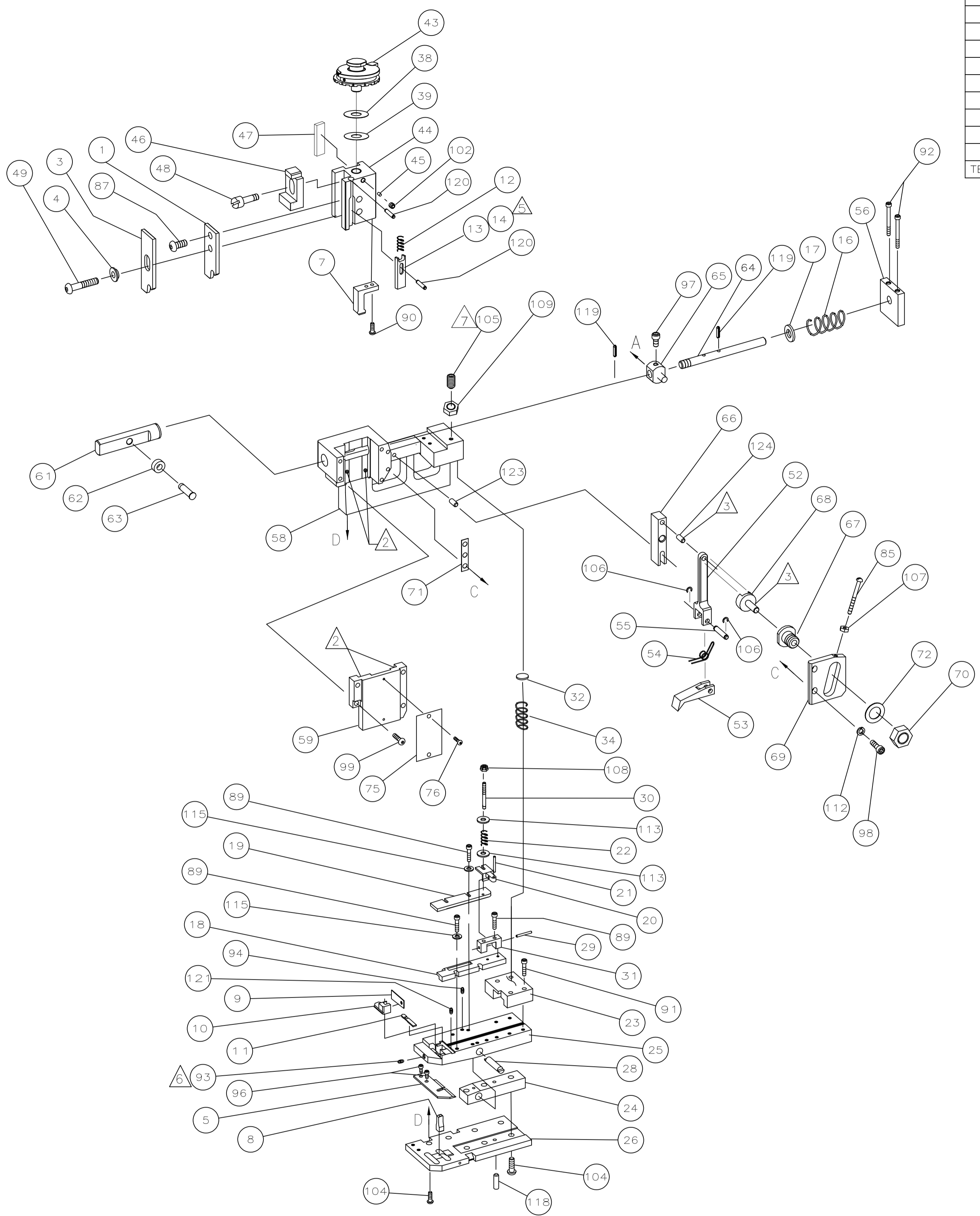

- ▲ 1 RECOMMENDED SPARE PARTS.
- ▲ 2 GREASE LIGHTLY.
- ▲ 3 LUBRICATE DAILY USING NO. 20 MACHINE OIL.
- 4. DO NOT EXCEED 80 C.P.M. WITH THIS APPLICATOR.
- ▲ 5 TERMINAL POSITIONERS (ITEMS 13 & 14) CAN BE CHANGED TO CENTER TAB IN SLOT WHILE CRIMPING
- ▲ 6 APPLY LOCTITE P/N 1-23419-5 TO ITEM 93 AT ASSEMBLY.
- ▲ 7 AFTER ASSEMBLY OF APPLICATOR, PROPER SPRING PRESSURE (ITEM 34) CAN BE OBTAINED BY TIGHTENING SET SCREW (ITEM 105) UNTIL CONTACT IS MADE WITH SPACER (ITEM 32) THEN TIGHTEN AN ADDITIONAL 5 1/2 - 6 REVOLUTIONS.

1	-	1-21030-2	PIN, DOWEL (Ø.187X.62)	124
1	-	1-21030-6	PIN, DOWEL (Ø.187X1.25)	123
2	-	3-21028-2	PIN, SLOTTED SPRING (Ø.094X.25)	121
3	-	4-21028-9	PIN, SLOTTED SPRING (Ø.125X.38)	120
2	-	5-21028-1	PIN, SLOTTED SPRING (Ø.125X.50)	119
1	-	21029-5	PIN, SLOTTED SPRING (Ø.188X.75)	118
4	-	21024-4	WASHER, LOCK (#8)	115
2	-	21055-6	WASHER, FLAT (#8)	114
2	-	21899-2	WASHER, FLAT (#10)	113
2	-	21024-5	WASHER, LOCK (#10)	112
1	-	1-22202-7	NUT, HEX (5/16-24)	109
1	-	21022-3	NUT, HEX (LOCKING)(10-32)	108
1	-	21018-5	NUT, HEX (6-32)	107
2	-	21045-3	RING, RET "C" (Ø.187) FD PIN	106
1	-	8-21007-5	SCREW, SKT SET (5/16-24x.75)	105
7	-	2-22733-8	SCREW, BHC (1/4-20X.63)	104
1	-	21009-2	SCREW, SKT SET (1/4-20x.25)	102
2	-	3-21000-9	SCREW, SHC (10-32X1.00)	100
4	-	3-21000-8	SCREW, SHC (10-32X.88)	99
2	-	3-21000-6	SCREW, SHC (10-32X.62)	98
1	-	3-21000-4	SCREW, SHC (10-32X.38)	97
2	-	7-21000-6	SCREW, SHC (10-32X.31)	96
1	-	4-21006-5	SCREW, SKT SET (8-32X.62)	94
1	-	21061-9	SCREW, SKT SET (8-32X.25)	93
2	-	3-21000-0	SCREW, SHC (8-32X.88)	92
4	-	2-21000-9	SCREW, SHC (8-32X.75)	91
2	-	1-23030-1	SCREW, SHC (NYLOK)(8-32X.62)	90
6	-	2-21000-8	SCREW, SHC (8-32X.62)	89
1	-	2-21002-1	SCREW, SBHC (8-32X.38)	87
1	-	6-23715-5	SCR, PAN HD (6-32x1.50) FEED ADJ	85
1	-	21017-2	SCR, DRIVE (2X .19)	76
1	-	461264-5	PLATE, IDENTIFICATION	75
1	-	458109-1	WASHER, SPECIAL	72
1	-	690517-1	SPACER	71

1	-	22594-8	NUT, HEX	70
1	-	240628-1	PLATE, ADJ	69
1	-	240626-1	SHAFT, PIVOT	68
1	-	240633-1	BUSHING	67
1	-	240630-1	LEVER, INTERMEDIATE	66
1	-	1804317-1	BLOCK, PIVOT	65
1	-	1633286-1	SCR, ADJ	64
1	-	240659-3	PIN, CAM ROLLER	63
1	-	240658-1	ROLLER, CAM	62
1	-	240631-1	ROD, FEED	61
1	-	2217626-1	CAP ASSEMBLY	59
1	-	2217625-1	HOUSING	58
1	-	458361-1	GUIDE, FEED ROD	56
1	-	240624-1	PIN, FEED FINGER	55
1	-	691499-1	SPRING, FEED FINGER	54
1	-	454568-1	FINGER, FEED	53
1	-	240634-1	LEVER, TERMINAL	52
1	-	3-21002-5	BOLT, CRIMPER	49
1	-	2256119-1	SCREW, SHOULDER	48
1	-	238015-1	CAM, POST-FEED 1 5/8 ST	47
1	-	690578-3	BLOCK, INSULATION ADJUST	46
1	-	690191-1	PLUG, NYLON	45
1	-	2217624-1	RAM	44
1	-	879103-2	FINE ADJUST HEAD ASSY	43
1	-	690125-1	SHIM, SUB-ASSY	39
1	-	1-469367-2	SHIM	38
1	-	3-23846-5	SPRING, HINGE BAR	34
1	-	690573-1	SPACER, SPRING	32
1	-	454569-1	MOUNT, DRAG	31
1	-	1-22354-8	STUD, DRAG	30
1	-	21030-2	PIN, MOUNT, DRAG	29
1	-	1633530-1	PIN, HINGE	28
1	-	684905-1	PLATE, BASE	26
1	-	454579-2	HINGE BAR	25
1	-	690571-1	BLOCK, STABILIZER	24
1	-	690585-1	BLOCK, PRESSURE	23
1	-	22282-5	SPRING, DRAG	22
1	-	21030-6	LEVER, DRAG	21
1	-	454570-1	DRAG, STOCK	20
1	-	454573-1	GUIDE, STRIP (REAR)	19
1	-	454571-1	GUIDE, STRIP (FRONT)	18
1	-	21899-4	WASHER, ADJ. SCREW	17
1	-	4-22284-9	SPRING, FEED RETURN	16
1	-	1-692134-6	POSITIONER, TERMINAL	14
1	-	692134-6	POSITIONER, TERMINAL	13
1	-	5-22280-5	SPRING, TERM. POSITIONER	12
1	-	454711-1	PLATE, REAR SHEAR	11
1	-	454710-1	ANVIL INSERT	10
1	-	1-690569-1	PLATE, FRONT SHEAR	9
1	-	690761-1	ANVIL	8
1	-	454575-4	BLADE, SLUG	7
1	-	684906-1	PLATE, ANVIL RETAINING	5
1	-	690574-1	SPACER, TUBULAR INSUL CRIMPER	4
1	-	690764-1	CRIMPER, INSULATION	3
1	-	690763-2	CRIMPER, WIRE	2

QTY REQD PER ASSY	U/M	PART NO	DESCRIPTION	ITEM NO
PARTS LIST				

QTY REQD PER ASSY	U/M	PART NO	DESCRIPTION	ITEM NO
PARTS LIST				

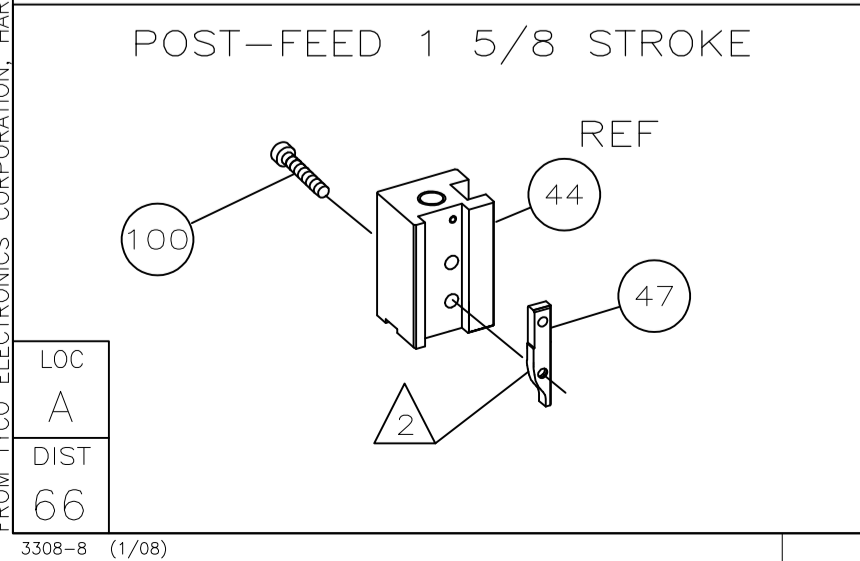

DIMENSIONS: INCHES
 TOLERANCES UNLESS OTHERWISE SPECIFIED:
 0 PLC ±.0005
 1 PLC ±.0010
 2 PLC ±.0015
 3 PLC ±.0020
 4 PLC ±.0025

SURFACE TEXTURE: ✓

SCALE: NTS A1
 SIZE: 1855521
 SHEET: 1 of 1
 REV: C

DATE: 25FEB2014
 DWN: KH
 APVD: TE

M.YOUNGER
 G.BAILEY
 T.ELBIN
 NAME: FINE ADJUST END FEED HINGE BAR APPLICATOR

MATERIAL: -
 HEAT TREAT: -
 16SEP2009
 16SEP2009

STE TE Connectivity
 Harrisburg, PA 17105-3608