

a) Part as supplied.

KTKK 1251-1258

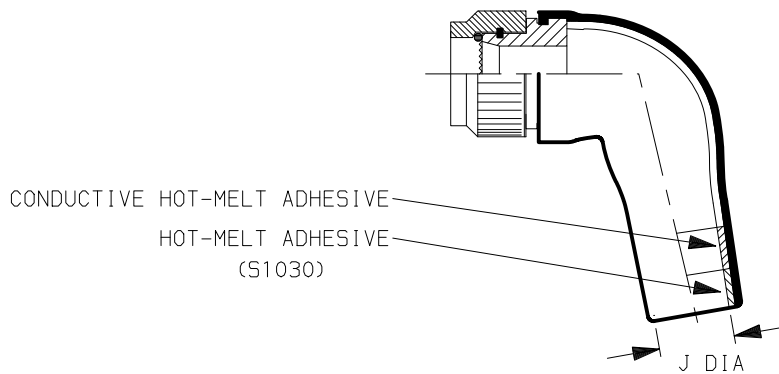

b) Part after unrestricted recovery.

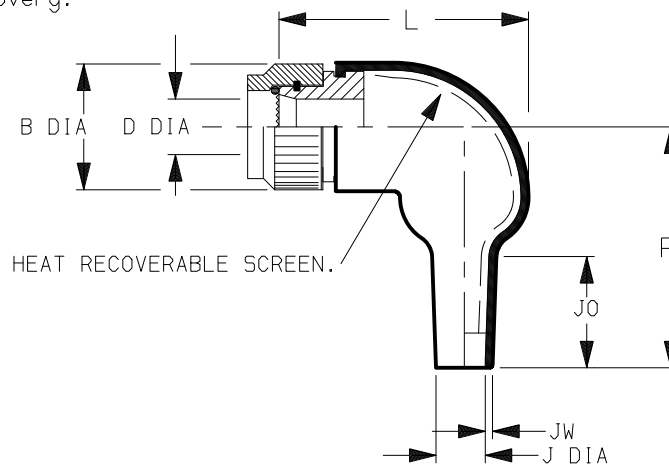

Raychem connector code:- 76

Connector series:- BS 9522 F0017 (PATT 105)

Adaptor Series:- 228M0**-19-R**-K-NS

Moulded Part Material:- -1005

Kits to include cleaning tissue, 1 piece 100 grit emery cloth & packing piece.

Kit to be used in conjunction with installation guide for 90 & 45 deg. assemblies.

Dimensions (in millimetres.)

Part No.	SHELL SIZE	B	D	J		L	P	J0	JW
		DIA MAX	DIA MIN	MIN a	MAX b	±10% b	±10% b	REF b	±30% b
KTKK 1251	10	20.1	9.4	9	6.0	46	38	17	1.0
KTKK 1252	12	23.6	13.4	11	7.2	49	42	18	1.0
KTKK 1253	14	26.6	14.2	11	7.2	49	42	18	1.0
KTKK 1254	16	30.1	18.9	17	8.5	56	51	20	1.0
KTKK 1255	18	33.1	18.9	17	8.5	56	51	20	1.0
KTKK 1256	20	36.6	23.7	21	10.0	63	67	28	1.5
KTKK 1257	22	39.6	23.7	21	10.0	63	67	28	1.5
KTKK 1258	24	43.1	30.9	29	15.8	72	80	31	1.5

Copyright (!)

Urheberrechte

The copyright in this drawing is the property of Tyco Electronics UK Ltd. The drawing is issued on condition that it is not copied, reproduced or disclosed to a third party, either in whole or in part without the prior written consent of Tyco Electronics UK Ltd.

Drawn J.RIBBONS Checked

Issue 4

Date Dec 2010

Conforms to ISO Recommendations

Approval

Design

MKTG.

Q.C.

3rd Angle Projection
Not to Scale

