

CAB469RF: MMCX R/A PLUG + SMA STRAIGHT BULKHEAD JACK WITH O-RING RATED TO IP67/68 + MULTIPLE CABLE SIZES, 6GHz

SPECIFICATIONS :

- MMCX RIGHT ANGLE PLUG, P/N:
FOR $\phi 1.37\text{MM}$, RG178 CABLE: RFCT-MMCX003-M78.
FOR $\phi 1.13\text{MM}$ LOW LOSS CABLE: RFCT-MMCX002-M13.
- COAXIAL CABLE, SEE P/N OPTIONS.
- SMA STRAIGHT BULKHEAD JACK WITH O-RING RATED TO IP67/68, P/N: RFCT-SMA069-F78.

USAGE PRECAUTIONS: CABLES USING 'MICRO' COAX ARE DELICATE:
 (i) HANDLE WITH CARE.
 (ii) DO NOT TWIST; APPLY EXCESSIVE FORCES OR SHARP BENDS TO THE CABLE. DO NOT FORCEFULLY DEFORM WIRES.
 (iii) CONSULT CONNECTOR MANUFACTURER'S DATASHEETS FOR DETAILED NOTES ON HANDLING INSTRUCTIONS.

ENVIRONMENTAL:

- BULKHEAD MOUNTED CONNECTOR (RFCT-SMA069-F78) RATED TO THE FOLLOWING SPECIFICATION:
 - IP6X - DUST TIGHT - NO PARTICLE INGRESS.
 - IPX7 WATERPROOF FOR 30 MINUTES UP TO 1 METER UNDERWATER.
 - IPX8 WATERPROOF FOR 48 HOURS AT 1 METER UNDERWATER.

NOTES:

- THE ORIENTATION OF CONNECTORS ON DRAWING IS FOR REFERENCE ONLY, IF THE ORDER IS LEFT BLANK THE CONNECTOR WILL NOT HAVE FIXED ORIENTATION.
- FIXED ORIENTATION IS SUGGESTED FOR CABLE LENGTH 50MM TO 100MM. PLEASE SPECIFY THE FIXED ORIENTATIONS FROM THE ORDER CODE (F1, F2, ETC)
- CONTACT GRADCONN IF THE ORIENTATION YOU REQUIRE IS NOT SHOWN.
- WORKING FREQUENCY RANGE: DC-6GHz.
- OPERATING TEMPERATURE: -40°C TO $+125^{\circ}\text{C}$.
- IMPEDANCE: 50 Ohm.

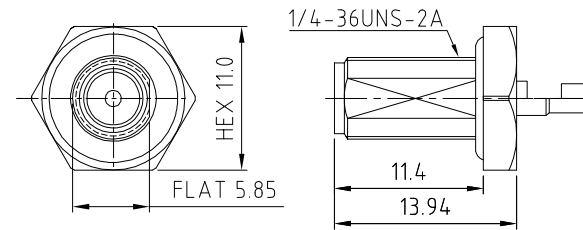
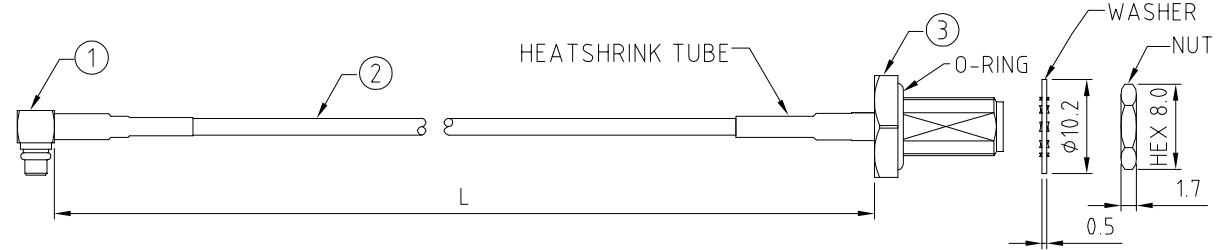

HOW TO ORDER
 CAB469RF - X X X X - X X - X - X

SMA DETAIL DRAWING

"L" LENGTH IN MM:
 eg: 100MM = 0100
 (MIN. 0050-MAX.0400)
 STANDARD = 0100, 0150, 0200
 TOLERANCE: 50-200mm: $\pm 5\text{mm}$.
 201-400mm: $\pm 7\text{mm}$.

CABLE SIZE OPTIONS:
 1 = RG178 CABLE, COLOR: BROWN
 2 = $\phi 1.37\text{MM}$ CABLE, COLOR: BLACK
 3 = $\phi 1.13\text{MM}$ LOW LOSS CABLE, COLOR: GRAY

WASHER AND NUT OPTIONS:
 BLANK = SEPARATELY PACKED (STANDARD)
 A = ASSEMBLED WITH CONNECTOR

ORIENTATION OPTIONS:
 BLANK = DOES NOT HAVE A FIXED ORIENTATION
 F1 = MMCX CONNECTION DOWN (L=50-200MM)
 F2 = MMCX CONNECTION UP (L=50-200MM)
 F3 = MMCX CONNECTION & SMA FLAT SAME ORIENTATION (L=50-200MM)
 F4 = MMCX CONNECTION & SMA FLAT OPPOSITE ORIENTATION (L=50-200MM)
 (SEE NOTES 1, 2, 3 AND DIAGRAMS FOR MORE INFORMATION)

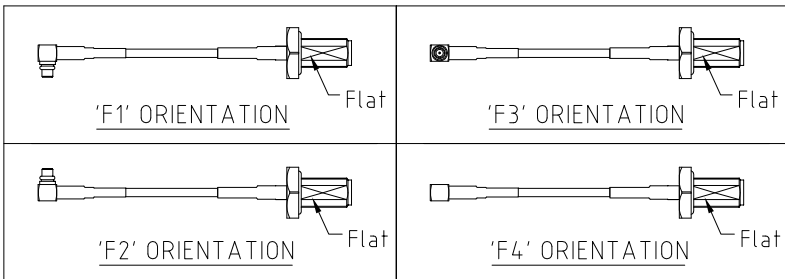
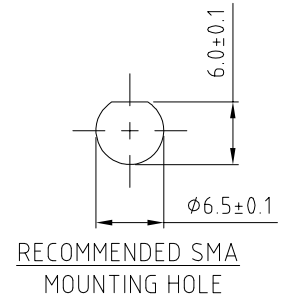

| | |
|-------------------------------|---------------------------|
| REV. DATE & DRN | 11.15/04/72 - NYW RELEASE |
| ADD 131. CABLE OPTION. | 17.08/17/22 - GLETONS |
| ADD 134.63. OPTION | 13.03/27/23 - NYW |
| 13. CORRECT RG178 CABLE COLOR | 14.12/01/73 - NYW |
| ADD 133. 1L CABLE OPTION. | |

| | | | |
|-------------------|----------------------|--------------------------------------|---|
| Scale: NTS | THIRD ANGLE | Unstated X XX XXX ANGLES | Tolerances: N/A N/A N/A N/A |
| Drawn: NYW | | | |
| App'd: XXX | Title CABLE ASSEMBLY | | |
| Date: 12 JAN. '23 | Revision: 14 | Unit: mm | |

| | | |
|--|----------------------|------------------------------------|
| IP67/68 Rated Cables | www.gradconn.com | Drawing Number: CAB469RF |
| | | Sheet 1 of 1 Drawing © E and OE |
| © THIS DRAWING IS CONFIDENTIAL AND MUST NOT BE COPIED OR DISCLOSED WITHOUT WRITTEN CONSENT | | |