

EM-90858-001

PCB PIN POLARISATION
OPTION A AND B

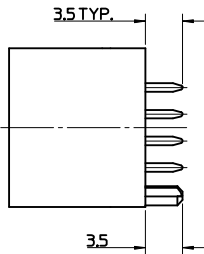

COLOUR STRIPE OPTION

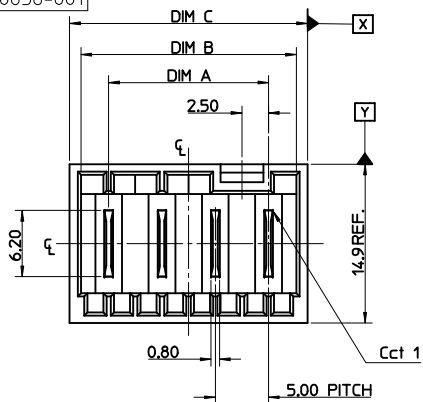
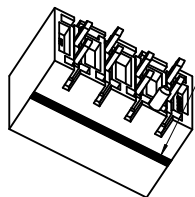

HOLE ON SOME TOOLED VERSIONS

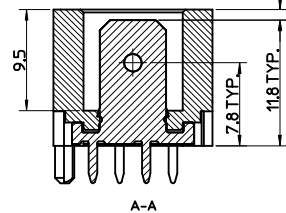
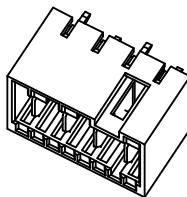
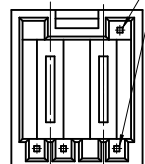

COLOUR STRIPE OPTION

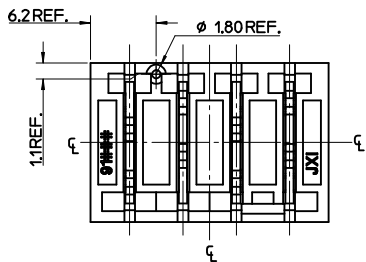
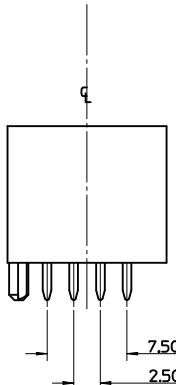
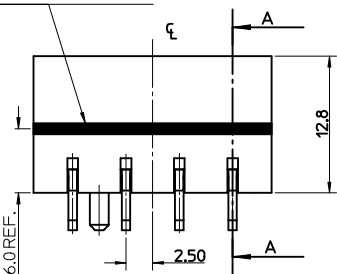

NOTES:

- MATERIALS
HOUSING: PA 66, UL94 V-2 HALOGEN FREE
TERMINAL: BRASS 0.80 REF. THICK
PLATING: OPTIONAL (SEE CHARTS SHEET 2)
TIN PLATING OPTION : 34µm TIN OVER
1.27µm NICKEL ALL AREAS.
SELECTIVE SILVER
CONTACT AREA : 24µm SILVER OVER 1.27µm NICKEL. ALL OTHER AREAS FLASH OF SILVER 0.10µm
- PRODUCT CONFORMS TO SPECIFICATION PS-99020-0037/39
- MATES WITH MOLEX 91338, 90833, 90835, 91777, 91778, 91779, 91954 & 92000.
- SEE PACKAGING SPECIFICATION PK-90858-001
TWO PACKAGING OPTIONS
A LOOSE IN POLYBAGS IN SHIPPING CARTON
B IN TUBES IN SHIPPING CARTON
SEE TABLES IN FOLLOWING SHEETS FOR PACKAGING TYPE FOR EACH PART NUMBER
- PLATED THRU HOLE
- NON-PLATED THRU HOLE
- RECOMMENDED PCB THICKNESS: 15mm REF
- PCB VIEW IS FROM SOLDER SIDE

CCT	DIM A	DIM B	DIM C	TOL
2	5.00	10.20	12.30	
3	10.00	15.20	17.30	
4	15.00	20.20	22.30	
5	20.00	25.20	27.30	
6	25.00	30.20	32.30	
7	30.00	35.20	37.30	
8	35.00	40.20	42.30	
9	40.00	45.20	47.30	
10	45.00	50.20	52.30	
11	50.00	55.20	57.30	
12	55.00	60.20	62.30	+/-0.30

OPTION "C"

PCB LAYOUT

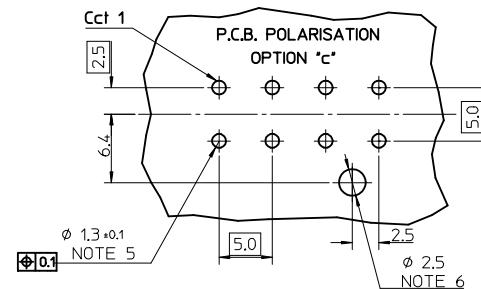
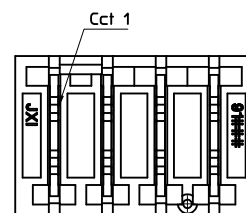

OPTION "B"

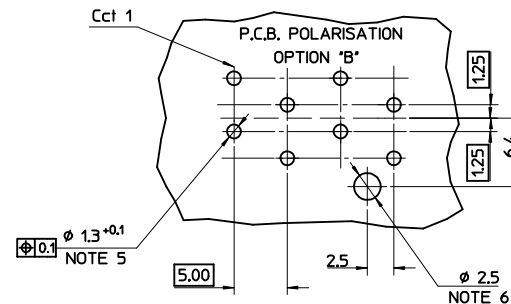
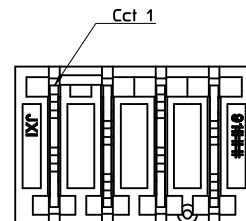

OPTION "A"

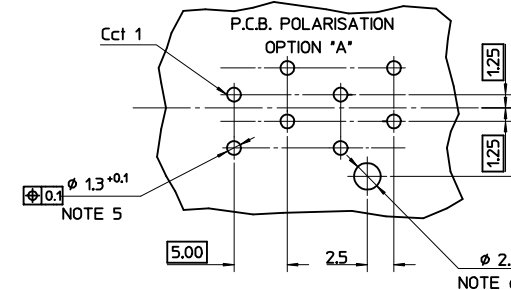
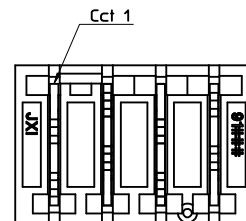

NOTE 7 PCB DIM CHANGE
EC NO: IFC2016-1580
DRAWN: CRAMER 2016/05/24
CHKD: CHKD
APPR: BRUTTLE 2016/08/30

QUALITY SYMBOLS
▽=0
▽=0

GENERAL TOLERANCES (UNLESS SPECIFIED)
mm INCH
4 PLACES ± --- ± ---
3 PLACES ± --- ± ---
2 PLACES ± 0.1 ± ---
1 PLACE ± 0.2 ± ---
ANGULAR ± 2°
DRAFT WHERE APPLICABLE
MUST REMAIN WITHIN DIMENSIONS

DIMENSION STYLE
MM ONLY
DRAWN BY B. RUTTLE
DATE 2006/10/04
CHECKED BY T. TOURSH
DATE 2006/10/04
APPROVED BY BMAGUIRE
DATE 2011/02/07
MATERIAL NO.
SEE SHEET 2

SCALE 1:1
DESIGN UNITS METRIC
THIRD ANGLE PROJECTION
TITLE RAST 5 VERT HDR
PA 66 HOUSING
HALOGEN FREE
DOCUMENT NO. SD-93319-001
SHEET NO. 1 OF 2
THIS DRAWING CONTAINS INFORMATION THAT IS PROPRIETARY TO MOLEX INCORPORATED AND SHOULD NOT BE USED WITHOUT WRITTEN PERMISSION

4 CIRCUIT

SEE CODE DESIGNATION TABLE FOR NUMBERING FORMAT WHEN ADDING NEW PART NUMBERS											P.C.B. OPTION	PACKAGING OPTION *	COLOUR STRIPE
PART NO. (TIN)	TERM NO. (TIN)	MOLEX HOUSING NO.	COLOUR	UNBLOCKED POSITION KEYS	UNBLOCKED CODING KEYS	LATCH POSITION	CONFIGURATION (SEE NOTES)	TERMINAL VOID CKT	TERM NO. (SILVER)	PART NO. (SILVER)			
93319-1254	91703-0002	93318-2000	NATURAL	1b	03c d40	1/2 3/4		NONE	91703-0003	93319-1999	A	A	NONE

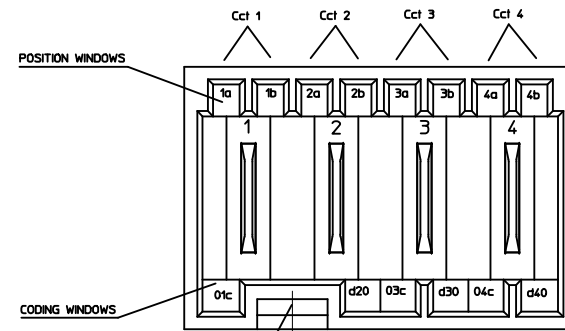

KEYING, CODING & LATCH POSITION
(4CCT EXAMPLE SHOWN)
VIEW INMATING DIRECTION

NOTES:
* SEE SHEET 1 NOTE 4

SEE SHEET 1 EC NO: IFC2076-1580 CHKD: DRWINZGRAMER APPR: BRUTTLE 2016/05/24 2016/08/30	QUALITY SYMBOLS	GENERAL TOLERANCES (UNLESS SPECIFIED)	DIMENSION STYLE	SCALE	DESIGN UNITS	THIRD ANGLE PROJECTION
	$\nabla=0$ $\nabla=0$	mm INCH 4 PLACES ± --- ± --- 3 PLACES ± --- ± --- 2 PLACES ± 0.1 ± --- 1 PLACE ± 0.2 ± --- ANGULAR ± 2 °	MM ONLY DRAWN BY DATE B. RUTLE 2006/10/04 CHECKED BY DATE T. TOURSH 2006/10/04 APPROVED BY DATE BMAGUIRE 2011/02/07	1:1	METRIC	
	DRAFT WHERE APPLICABLE MUST REMAIN WITHIN DIMENSIONS	SEE CHART	MATERIAL NO.	DOCUMENT NO.	RAST 5 VERT HDR PA 66 HOUSING HALOGEN FREE MOLEX INCORPORATED	
						SD-93319-001

THIS DRAWING CONTAINS INFORMATION THAT IS PROPRIETARY TO MOLEX INCORPORATED AND SHOULD NOT BE USED WITHOUT WRITTEN PERMISSION