

MATERIALS AND FINISHES:

BODY STAINLESS STEEL
 PASSIVATED

CENTER CONTACT BERYLLIUM COPPER
 PLATED GOLD

INSULATOR TEFLON

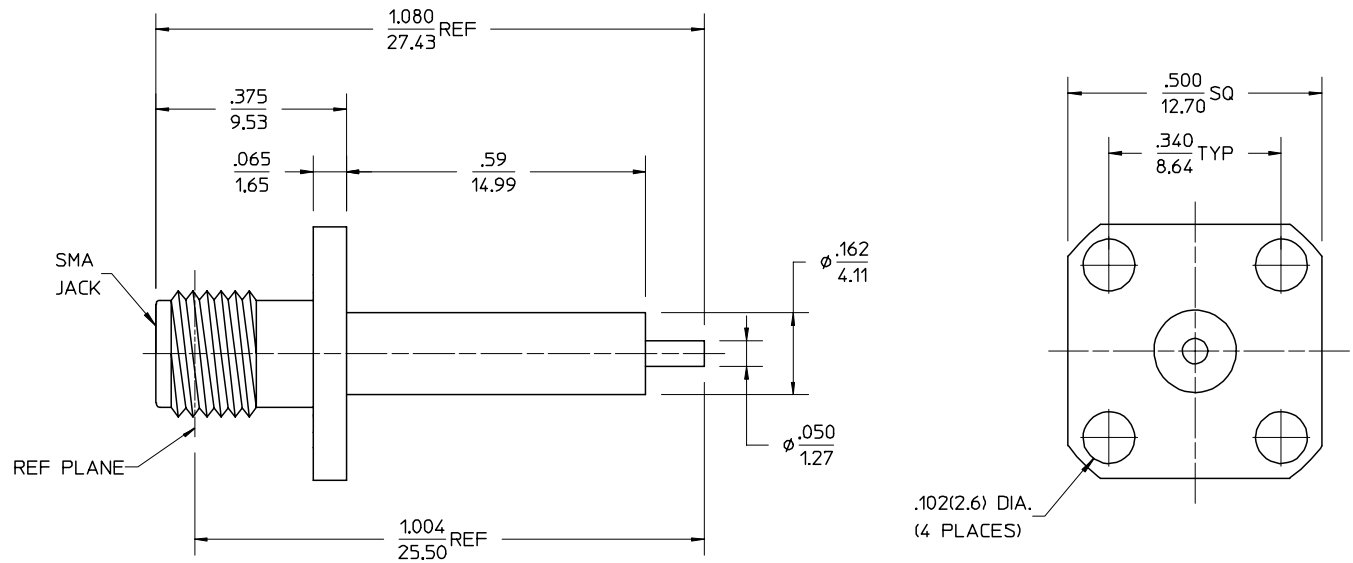

PART # 73251-0410

MIL-STD-348, FIGURE 310-2	INTERFACE
PS-89675-2820	ELECTRO/MECH PERFORMANCE
SPECIFICATION	DESCRIPTION

CHG: 58 WAS .590	EC NO. URF-1710 DRWN: JDW 04/11/03 CHK: SSS 04/11/03 APPR: GMH 04/11/03 CHG: NEW RELEASE	EC NO. URF-1699 DRWN: TEF 04/01/03 CHK: SSS 04/01/03 APPR: JW 04/01/03	REV 1 WAS A SINCE EC NO 0013 WAS CANCELLED REMOVED MIL SPECS FROM MATERIAL AND FINISHES TEF 03/19/02	EC NO. RF-0013 DRWN: EDC 12/10/97 CHK: DHG 01/09/98 APPR: GMH 01/09/98	DESCRIPTION
A1	A	2	1	REV	

UNLESS OTHERWISE SPECIFIED DIMS ARE INCHES AND ANGLES ARE DEGREES.

- ✓ 63 ALL OVER.
- NO CHATTER OR NON-UNIFORM SURFACE FINISH ALLOWED.
- PARTS TO BE FREE OF BURRS & SHARP EDGES .005 MAX BREAK.
- EXTERNAL THREADS TO BE ROLLED OR SINGLE POINT.
- DIAMETERS TO BE CONCENTRIC WITHIN .003 TIR.

QUALITY SYMBOLS	GENERAL TOLERANCES: (UNLESS SPECIFIED)	SCALE	DESIGN UNITS	THIRD ANGLE PROJECTION	DIMENSIONS:
MAJOR	mm INCH	DRAWN BY & DATE	mm INCH	mm INCH	mm INCH mm ONLY
CRITICAL	4 PLACES ± .0005	EDC 12/10/97	<input type="checkbox"/> mm <input checked="" type="checkbox"/> INCH	<input type="checkbox"/> mm <input checked="" type="checkbox"/> INCH	<input type="checkbox"/> mm <input checked="" type="checkbox"/> INCH
	3 PLACES ± .005	CHECKED BY & DATE			
	2 PLACES ± .01	DHG 01/09/98			
	1 PLACE ± .1	APPROVED BY & DATE			
	ANGULAR: ± 1/2°	GMH 01/09/98			
	DRAFT WHERE APPLICABLE MUST REMAIN WITHIN DIMENSIONS	CAD FILENAME			

TITLE:	1	A1
SMA JACK, RECEPTACLE, 4 HOLE FLANGE MOUNT, EXTENDED DIELECTRIC POST SMA-SDJR/F	SHT	REV
MOLEX MOLEX INCORPORATED	REVISE ON CAD ONLY	
MATERIAL NO. SEE NOTE	DRAWING NO. SD-73251-041	SHEET NO. 1 of 1
THIS DRAWING CONTAINS INFORMATION THAT IS PROPRIETARY TO MOLEX INCORPORATED AND SHOULD NOT BE USED WITHOUT WRITTEN PERMISSION.		SIZE B