

Approved	Checked	Designed	DEVELOPMENT SPECIFICATION						
<i>M. Yamashita</i>	<i>M. Iizuka</i>	<i>T. Takata</i>					P/N: <u>LN1471SYTRP</u>		
T	Y	P	E	Amber Light Emitting Diode					
APPLICATION				Indicators					
MATERIAL				GaAsP					
OUTLINE				Attached					
ABSOLUTE MAXIMUM RATINGS				P	※IFP	IFDC	VR	Topr	Tstg
				30	50	10	4	-30~+85	-40~+100
				mW	mA	mA	V	°C	°C
CONDITION				Ta=25±3 °C					
Test Specification									
Item	Symbol	Condition	Typ	Limit		Unit			
				Min	Max				
Forward Voltage	VF	IF= 5 mA	1.9		2.4	V			
Reverse Leakage Current	IR	VR= 4 V			10	μA			
Luminous Intensity	IO	IF= 5 mA · DC	1.0	0.4		mcđ			
Peak Emission Wavelength	λp	IF= 5 mA · DC	590			nm			
Spectral Line Half Width	Δλ	IF= 5 mA · DC	30			nm			
<p>※ · The condition of IFP is duty 10 % , Pulse width 1 ms · Please contact the Panasonic local office if you design at low current (below 0.5 mA DC) or pulse current operation and have any questions.</p> <p>NOTE</p> <p>★1 Soldering conditions. Refer to handling note.</p> <p>★2 Care should be taken that soldering is done within 3-days after opening the dry package and reel.</p> <p>★3 Package:Light yellow diffusion type.</p> <p>★4 Tone of Color is passed over.</p>									
Jun.13.1995									

Approved <i>M. Yamashita</i>	Checked <i>K. Kikuchi</i>	Designed <i>T. Taniota</i>	DEVELOPMENT SPECIFICATION		
			P/N: LN1471SYTRP		

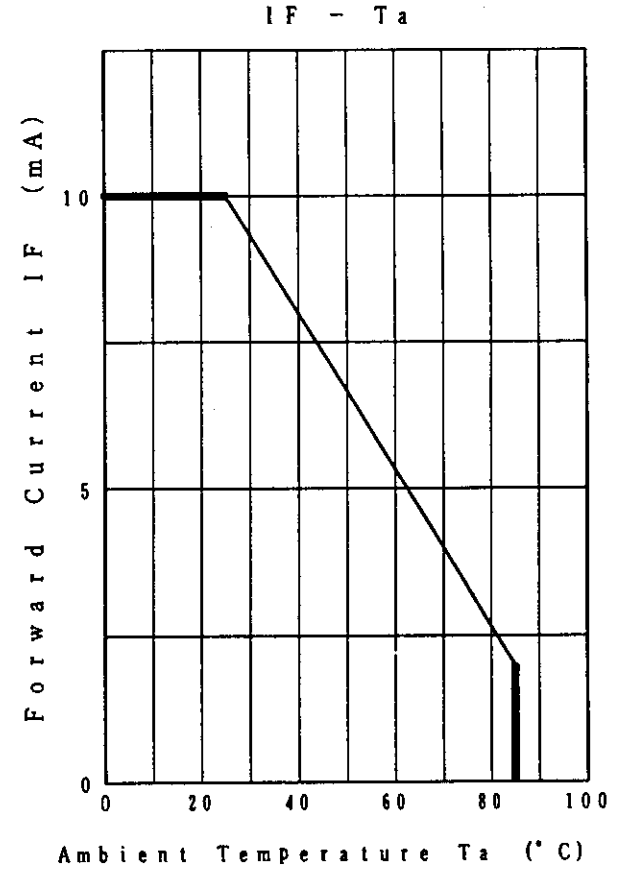
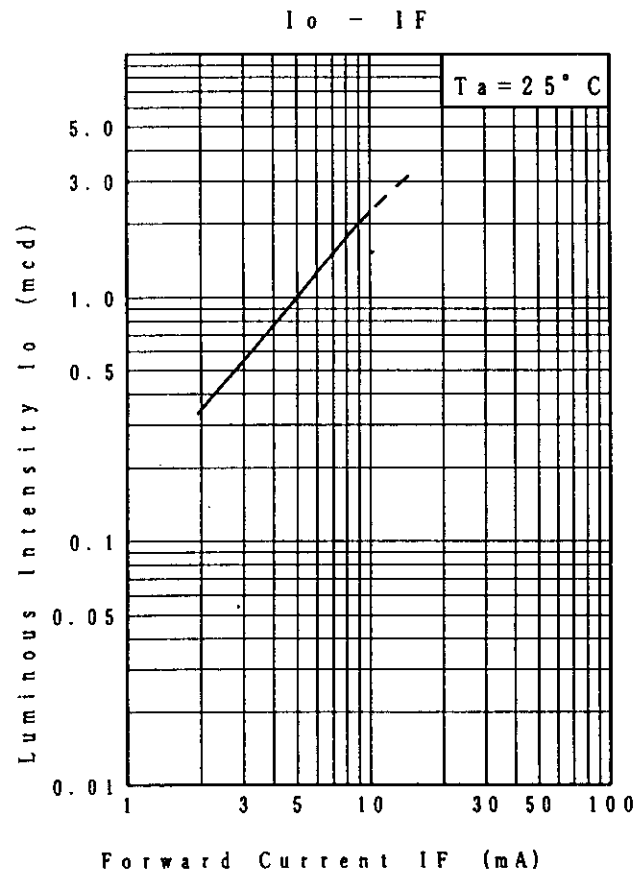
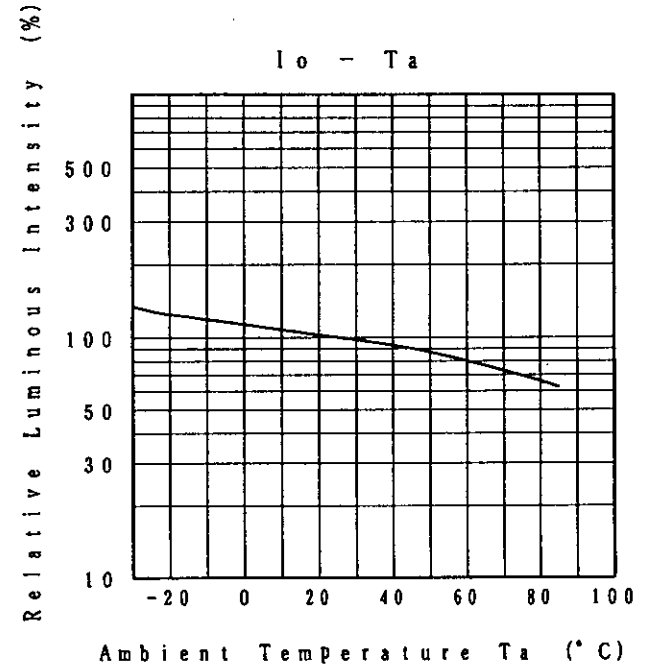
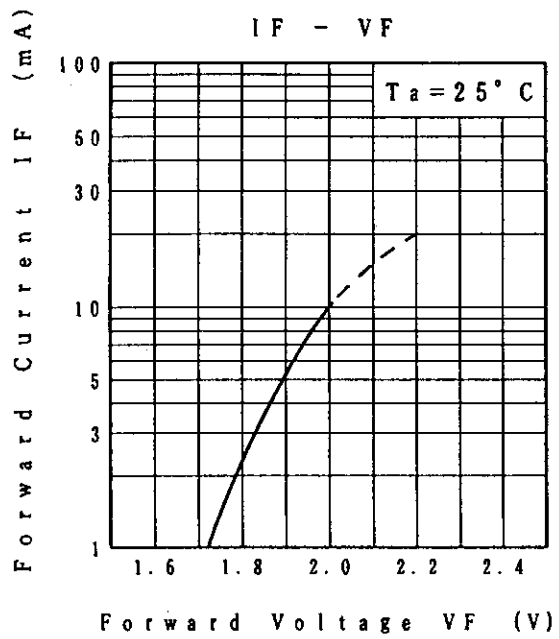

Approved	Checked	Designed
<i>M. Yamashita</i>	<i>K. Kikuchi</i>	<i>T. Takata</i>

DEVELOPMENT SPECIFICATION

P/N: LN1471SYTRP

Relative Luminous Intensity
Wavelength Characteristics

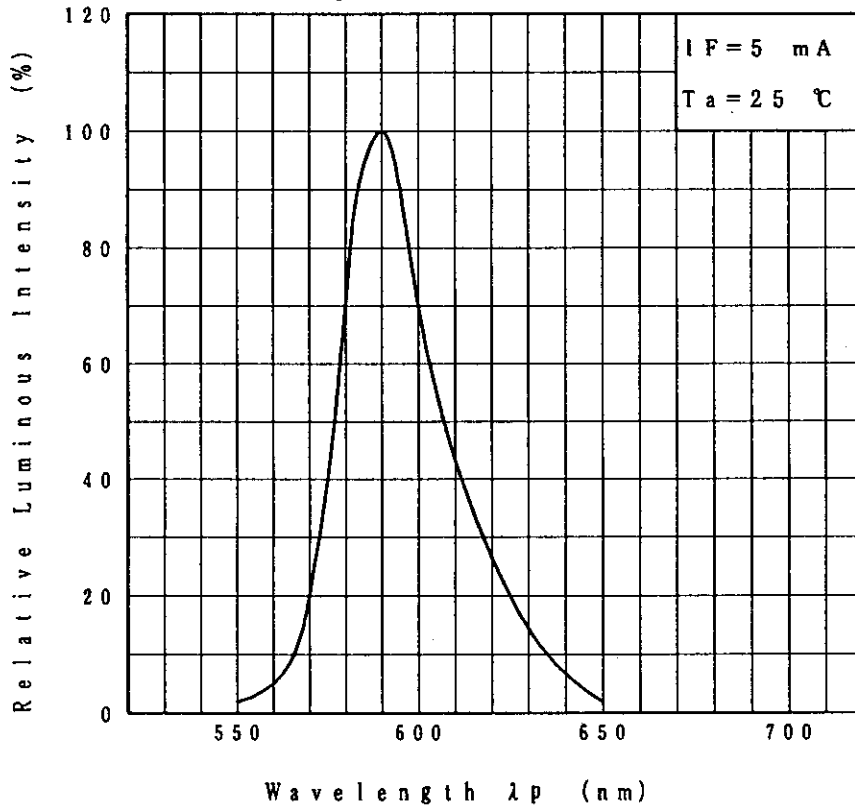

Directive Characteristics

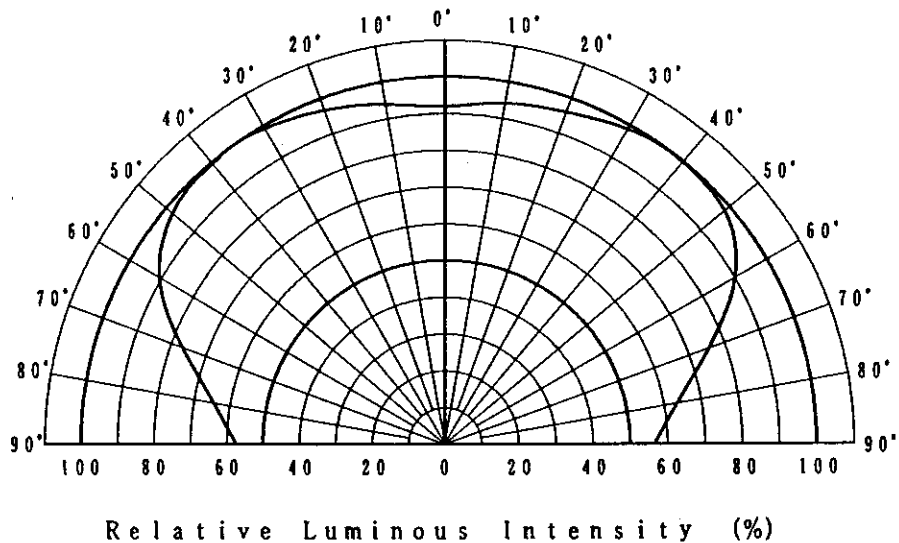

Jun. 13. 1995

Approved	Checked	Designed	DEVELOPMENT SPECIFICATION
<i>H. Yamashita</i>	<i>K. Kubota</i>	<i>T. Takata</i>	

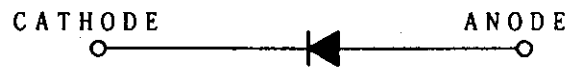
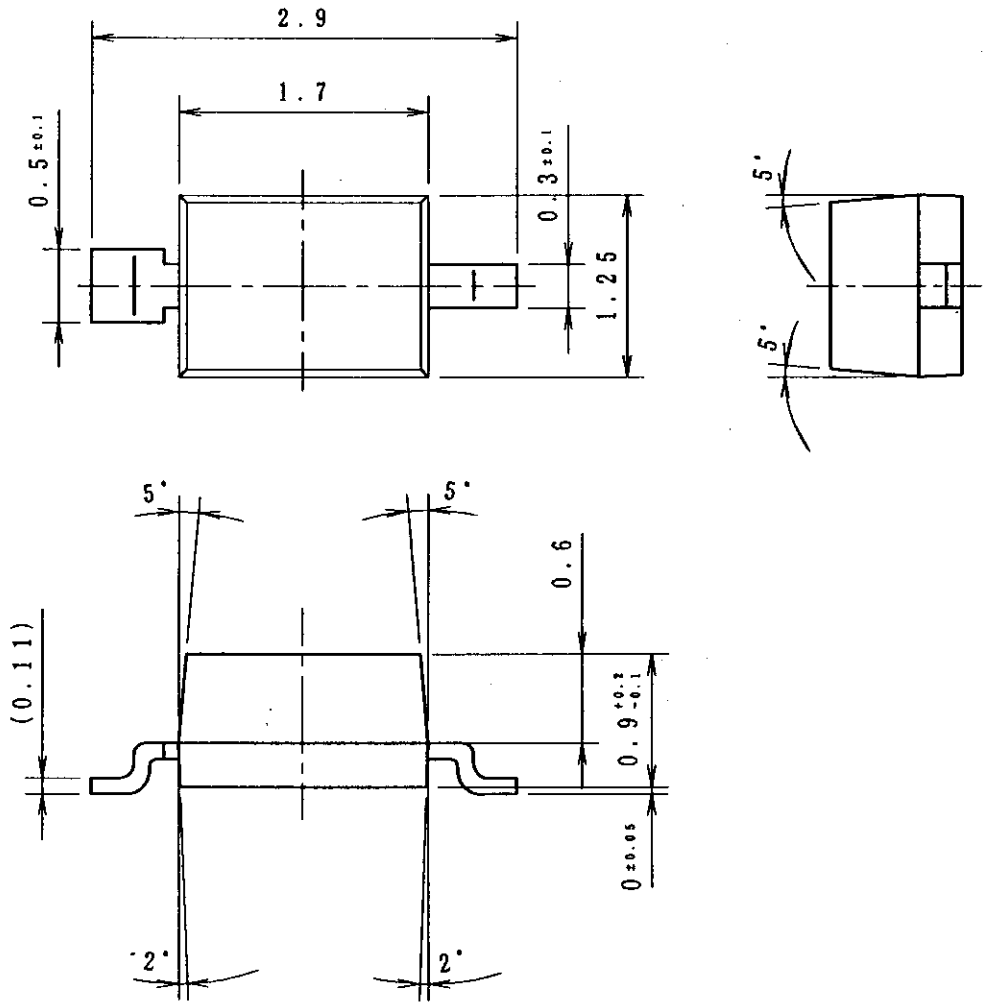

- (NOTE)
1. Unit: mm
 2. Tolerance unless specified is ±0.2.
 3. Measurement of the package doesn't include gate projection.
 4. Corner of the package is R 0.2max.
 5. Projection's tolerance of the package is 0.2max.

Jun. 13. 1995		
---------------	--	--