

NOTES:

- MATERIAL: HIGH PERFORMANCE COPPER ALLOY
- FINISH:
 - 222 - OVERALL TIN: 100 MI MIN OVER NICKEL
 - 228 - SELECT GOLD: 30 MI MIN, SELECT TIN: 100 MI MIN OVER NICKEL
- PRODUCT SPECIFICATION: PS-46064-001
- PACKAGING:
 - REEL PACK PER : PK-46056-002
 - LOOSE PACK PER : PK-5556-003
- TERMINAL TO BE USED WITH ASSY NUMBER: 46065
- WIRE SPECIFICATION: SEE CHART.
- WHEN USING OVERALL TIN PLATED TERMINALS: FOR APPLICATIONS INVOLVING VIBRATION AND/OR THERMAL CYCLING, MOLEX STRONGLY RECOMMENDS THE USE OF NYE LUBRICANT, NYOGEL 760G, ON THE MATING END OF THE TERMINAL. LUBRICANT MAY BE APPLIED BEFORE OR AFTER THE TERMINALS ARE INSERTED INTO THE HOUSING.

SECTION Y-Y
CONDUCTOR CRIMP

SECTION Z-Z
INSULATION CRIMP

LOOSE PACKAGED MATERIAL NUMBER	REEL PACKAGED MATERIAL NUMBER	FINISH	WIRE SPEC	INSULATION DIA	INSULATION (CRIMPED)			CONDUCTOR (CRIMPED)				
					HEIGHT		WIDTH		HEIGHT		WIDTH	
					MIN	MAX	MIN	MAX	MIN	MAX	MIN	MAX
46056-0004	46056-0002	222 - TIN	UL1015 18/20 AWG	2.52 / 2.81	N/A	3.20	2.70	2.90	1.05	1.15	1.50	1.70
46056-0005	46056-0003	228 - SELECT GOLD	UL1015 18/20 AWG	2.52 / 2.81	N/A	3.20	2.70	2.90	1.05	1.15	1.50	1.70

UPDATE NOTE 4 EC NO: UCP2011-1228 DRWN: JJAGUILAR 2010/10/29 CHKD: APPR: FSMITH 2010/11/09	QUALITY SYMBOLS	GENERAL TOLERANCES (UNLESS SPECIFIED)	DIMENSION STYLE	SCALE	DESIGN UNITS	THIRD ANGLE PROJECTION														
	$\nabla \text{E} = 0$ $\nabla \text{F} = 0$ $\nabla \text{B} = 0$	<table border="1"> <tr> <th></th> <th>mm</th> <th>INCH</th> </tr> <tr> <td>4 PLACES</td> <td>± ---</td> <td>± ---</td> </tr> <tr> <td>3 PLACES</td> <td>± ---</td> <td>± ---</td> </tr> <tr> <td>2 PLACES</td> <td>± 0.25</td> <td>± ---</td> </tr> <tr> <td>1 PLACE</td> <td>± 0.38</td> <td>± ---</td> </tr> </table>		mm	INCH		4 PLACES	± ---	± ---	3 PLACES	± ---	± ---	2 PLACES	± 0.25	± ---	1 PLACE	± 0.38	± ---	MM ONLY	4:1
		mm	INCH																	
	4 PLACES	± ---	± ---																	
3 PLACES	± ---	± ---																		
2 PLACES	± 0.25	± ---																		
1 PLACE	± 0.38	± ---																		
	ANGULAR ± 3 °	DRAWN BY KSAMIEC	DATE 2007/03/22	TITLE SEALED MINIFIT H20 PLUG TERMINAL																
	DRAFT WHERE APPLICABLE MUST REMAIN WITHIN DIMENSIONS	APPROVED BY FSMITH	DATE 2010/11/09	MOLEX INCORPORATED																
		MATERIAL NO. SEE CHART		DOCUMENT NO. SD-46056-001	SHEET NO. 1 OF 1															

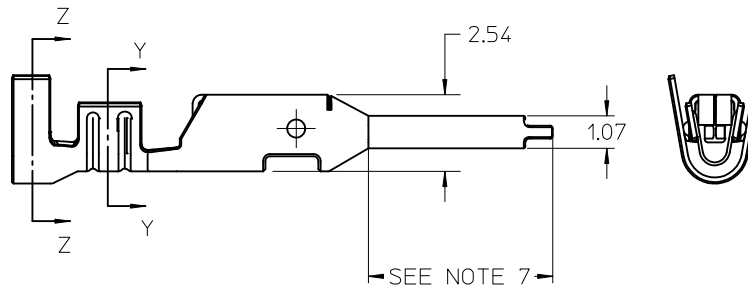
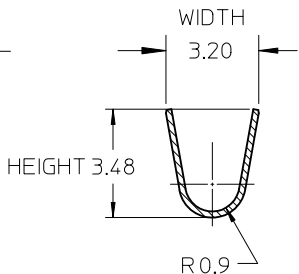
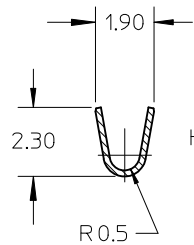
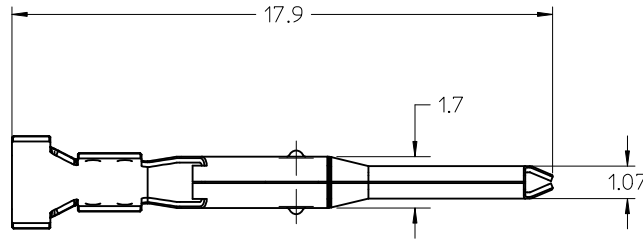
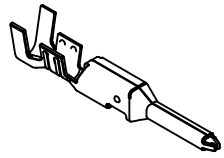

NOTES:

- MATERIAL: HIGH PERFORMANCE COPPER ALLOY
- FINISH:
 - 222 - OVERALL TIN: 100 MI MIN OVER NICKEL
 - 228 - SELECT GOLD: 30 MI MIN, SELECT TIN: 100 MI MIN OVER NICKEL
- PRODUCT SPECIFICATION: PS-46064-001
- PACKAGING:
 - REEL PACK PER : PK-46056-002
 - LOOSE PACK PER : PK-5556-003
- TERMINAL TO BE USED WITH ASSY NUMBER: 46065
- WIRE SPECIFICATION: SEE CHART.
- WHEN USING OVERALL TIN PLATED TERMINALS: FOR APPLICATIONS INVOLVING VIBRATION AND/OR THERMAL CYCLING, MOLEX STRONGLY RECOMMENDS THE USE OF NYE LUBRICANT, NYOGEL 760G, ON THE MATING END OF THE TERMINAL. LUBRICANT MAY BE APPLIED BEFORE OR AFTER THE TERMINALS ARE INSERTED INTO THE HOUSING.

SECTION Y-Y
CONDUCTOR CRIMP

SECTION Z-Z
INSULATION CRIMP

LOOSE PACKAGED MATERIAL NUMBER	REEL PACKAGED MATERIAL NUMBER	FINISH	WIRE SPEC	INSULATION DIA	INSULATION (CRIMPED)			CONDUCTOR (CRIMPED)				
					HEIGHT		WIDTH		HEIGHT		WIDTH	
					MIN	MAX	MIN	MAX	MIN	MAX	MIN	MAX
46056-0004	46056-0002	222 - TIN	UL1015 18/20 AWG	2.52 / 2.81	N/A	3.20	2.70	2.90	1.05	1.15	1.50	1.70
46056-0005	46056-0003	228 - SELECT GOLD	UL1015 18/20 AWG	2.52 / 2.81	N/A	3.20	2.70	2.90	1.05	1.15	1.50	1.70

UPDATE NOTE 4
EC NO: UCP2011-1228
DRWN: JJAGUILAR 2010/10/29
CHKD:
APPR: FSMITH 2010/11/09

QUALITY SYMBOLS	DESCRIPTION
	=0
	=0
	=0

	GENERAL TOLERANCES (UNLESS SPECIFIED)	
	mm	INCH
4 PLACES	± ---	± ---
3 PLACES	± ---	± ---
2 PLACES	± 0.25	± ---
1 PLACE	± 0.38	± ---
ANGULAR ± 3 °		
DRAFT WHERE APPLICABLE MUST REMAIN WITHIN DIMENSIONS		

DIMENSION STYLE MM ONLY	
DRAWN BY KSAMIEC	DATE 2007/03/22
CHECKED BY	DATE
APPROVED BY FSMITH	DATE 2010/11/09
MATERIAL NO. SEE CHART	

SCALE 4:1	DESIGN UNITS METRIC	THIRD ANGLE PROJECTION
TITLE SEALED MINIFIT H20 PLUG TERMINAL		
MOLEX MOLEX INCORPORATED		
MATERIAL NO. SD-46056-001	DOCUMENT NO.	SHEET NO. 1 OF 1
THIS DRAWING CONTAINS INFORMATION THAT IS PROPRIETARY TO MOLEX INCORPORATED AND SHOULD NOT BE USED WITHOUT WRITTEN PERMISSION		