

---

## Product Change Notification(PCN)

---

Issue Date: 14.08.2013  
Modification / Revision Date: 14.08.2013

### IEEE 1394, 6 contacts, vertical version, DIP (2010 catalogue page 137)

Change Notification # : PCN 20131408-A-IEE-DIP

Description of changes: CHANGE OF MANUFACTURING LOCATION  
CHANGE OF ORDERCODE  
1. Amendment of the specification  
2. Tolerance : New : x.xx ±0.13 // x.x ±0.25  
3. Change of dimensions, see sheet 3  
4. Catalogue 2010 shows different specification  
5. Draw.-No. ASS 3559 COrev03 substitutes ASS 3559 COrev02

Date of change and Implementation: Change: KW 33/13 [Datecode of Production]  
Implementation: KW 33/13

Key Characteristics of Change: Dimensions and Tolerances

Products Affected: A-IEE-DIP-C change to A-IEE-DIP

Reason for Change: Change of manufacturing location

Response : No response to this notification is required.

ASSMANN WSW components GmbH  
Auf dem Schüffel 1  
D-58513 Lüdenscheid  
Tel.: +49-2351 - 554-0  
Fax: +49-2351 - 554-99225

---

## Product Change Notification(PCN)

---

**Issue date:** 14.08.2013**Modification / Revision date:** 14.08.2013**Reference Documents / Attachments:****Document: Drawing**

ASSMANN WSW P/N	Drawing Number
A-IEE-DIP	ASS 3559 COrev03

As attached

**PCN Revision History:****Date of Revision:** 14.08.2013**Revision Number:** 00

## Product Change Notification(PCN)

Issue date: **14.08.2013**  
Modification / Revision date: **14.08.2013**

### A-IEE-DIP-C

### Old version

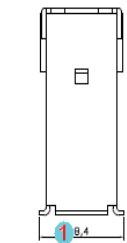

**NOTES:**

- 1.Insulation: PBT UL94V-0, Color Black
- 2.Contact : Brass
- 3.Plating : Selective 30µ" Gold over 50µ" Nickel
- 4,Shell ; Brass
- 5.Shell Plating: 80µ" Nickel over 50µ" Cu
- 6.Durability: 1500 cycles @

- (1) 8.4 ±0.30mm
- (2) 11.10 ±0.20mm
- (3) 2.80 ±0.20mm
- (4) 17.8 ±0.30mm
- (5) 13.5 ±0.30mm
- (6) 12.0 ±0.30mm

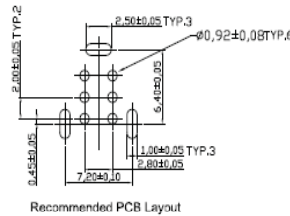
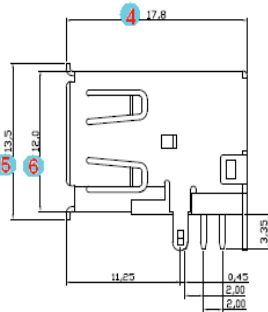
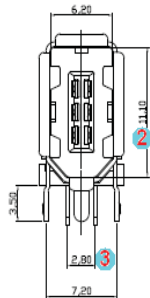

### A-IEE-DIP

### New version

③

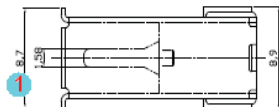

NO.	Name	Material	Finish	QTY
1	Housing	PBT	Black	1
2	Pin Terminal	Brass (=0,2	Gold30µ" Ni50-100µ" Sn:120-200µ"	6
3	Shell	Brass (=0,4	Ni 80-120µ"	1
4	Bottom Cover	PBT	Black	1

- (1) 8.7 ±0.25mm
- (2) 11.3 ±0.25mm
- (3) 1.5+1.5 ±0.13mm
- (4) 18.0 ±0.25mm
- (5) 13.85 ±0.13mm
- (6) 12.3 ±0.25mm

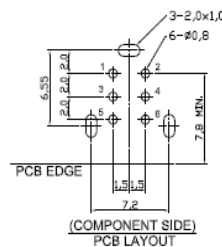
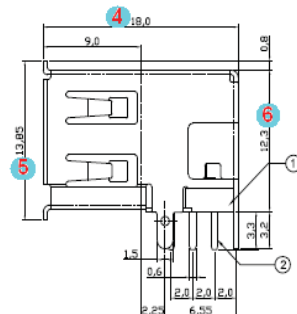
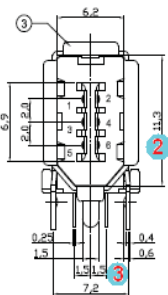

### PCN Revision History:

Date of Revision: 14.08.2013

Revision Number: 00

1	2	3	4	5	6	7																																																						
<p>③</p> <p>Top View Dimensions: 6.2, 6.9, 11.3, 0.25, 1.5, 0.4, 0.6, 1.5, 1.5, 7.2</p> <p>Side View Dimensions: 18.0, 9.0, 13.85, 12.3, 0.8, 2.0, 2.0, 2.0, 2.0, 6.55, 1.5, 0.6, 2.25</p> <p>PCB Edge Dimensions: 6.55, 2.0, 2.0, 2.0, 2.0, 1.5, 1.5, 7.2</p> <p>Callouts: 1, 2, 3, 4, 5, 6, 3-2,0x1,0, 6-∅0,8</p> <p>PCB EDGE (COMPONENT SIDE) PCB LAYOUT</p>																																																												
<p>Durability: 1500 cycles min.</p>																																																												
<table border="1"> <thead> <tr> <th>NO.</th> <th>Name</th> <th>Material</th> <th>Finish</th> <th>Q'TY</th> </tr> </thead> <tbody> <tr> <td>1</td> <td>Housing</td> <td>PBT</td> <td>Black</td> <td>1</td> </tr> <tr> <td>2</td> <td>Pin Terminal</td> <td>Brass <math>\pm 0.2</math></td> <td>Gold:30u" Ni:60~100u" Sn:120~200u"</td> <td>6</td> </tr> <tr> <td>3</td> <td>Shell</td> <td>Brass <math>\pm 0.4</math></td> <td>Ni 80~120u"</td> <td>1</td> </tr> <tr> <td>4</td> <td>Bottom Cover</td> <td>PBT</td> <td>Black</td> <td>1</td> </tr> </tbody> </table>							NO.	Name	Material	Finish	Q'TY	1	Housing	PBT	Black	1	2	Pin Terminal	Brass $\pm 0.2$	Gold:30u" Ni:60~100u" Sn:120~200u"	6	3	Shell	Brass $\pm 0.4$	Ni 80~120u"	1	4	Bottom Cover	PBT	Black	1																													
NO.	Name	Material	Finish	Q'TY																																																								
1	Housing	PBT	Black	1																																																								
2	Pin Terminal	Brass $\pm 0.2$	Gold:30u" Ni:60~100u" Sn:120~200u"	6																																																								
3	Shell	Brass $\pm 0.4$	Ni 80~120u"	1																																																								
4	Bottom Cover	PBT	Black	1																																																								
<table border="1"> <thead> <tr> <th>Scale</th> <th>Free</th> <th>Id.</th> <th>Modification</th> <th>Date</th> <th>Name</th> </tr> </thead> <tbody> <tr> <td>TOLERANCE</td> <td></td> <td></td> <td></td> <td></td> <td></td> </tr> <tr> <td>X.</td> <td><math>\pm 0.38</math></td> <td></td> <td></td> <td></td> <td></td> </tr> <tr> <td>.X</td> <td><math>\pm 0.25</math></td> <td></td> <td></td> <td></td> <td></td> </tr> <tr> <td>.XX</td> <td><math>\pm 0.13</math></td> <td>③</td> <td>Update the WSW P/N and drawing</td> <td>29.07.2013</td> <td>Amy</td> </tr> <tr> <td>DIM TOL</td> <td></td> <td>②</td> <td>Add durability</td> <td>24.11.2011</td> <td>Lucas</td> </tr> <tr> <td>X.°</td> <td><math>\pm 3^\circ</math></td> <td>①</td> <td>Drawn</td> <td>07.07.2009</td> <td>Dean</td> </tr> <tr> <td>.X.°</td> <td><math>\pm 1^\circ</math></td> <td></td> <td></td> <td></td> <td></td> </tr> <tr> <td>Angle TOL</td> <td></td> <td></td> <td></td> <td></td> <td></td> </tr> </tbody> </table>							Scale	Free	Id.	Modification	Date	Name	TOLERANCE						X.	$\pm 0.38$					.X	$\pm 0.25$					.XX	$\pm 0.13$	③	Update the WSW P/N and drawing	29.07.2013	Amy	DIM TOL		②	Add durability	24.11.2011	Lucas	X.°	$\pm 3^\circ$	①	Drawn	07.07.2009	Dean	.X.°	$\pm 1^\circ$					Angle TOL					
Scale	Free	Id.	Modification	Date	Name																																																							
TOLERANCE																																																												
X.	$\pm 0.38$																																																											
.X	$\pm 0.25$																																																											
.XX	$\pm 0.13$	③	Update the WSW P/N and drawing	29.07.2013	Amy																																																							
DIM TOL		②	Add durability	24.11.2011	Lucas																																																							
X.°	$\pm 3^\circ$	①	Drawn	07.07.2009	Dean																																																							
.X.°	$\pm 1^\circ$																																																											
Angle TOL																																																												
<p><b>RoHS compliant</b> Unit: mm</p>																																																												
<table border="1"> <thead> <tr> <th>Scale</th> <th>Free</th> <th>Id.</th> <th>Modification</th> <th>Date</th> <th>Name</th> </tr> </thead> <tbody> <tr> <td>TOLERANCE</td> <td></td> <td></td> <td></td> <td></td> <td></td> </tr> <tr> <td>X.</td> <td><math>\pm 0.38</math></td> <td></td> <td></td> <td></td> <td></td> </tr> <tr> <td>.X</td> <td><math>\pm 0.25</math></td> <td></td> <td></td> <td></td> <td></td> </tr> <tr> <td>.XX</td> <td><math>\pm 0.13</math></td> <td>③</td> <td>Update the WSW P/N and drawing</td> <td>29.07.2013</td> <td>Amy</td> </tr> <tr> <td>DIM TOL</td> <td></td> <td>②</td> <td>Add durability</td> <td>24.11.2011</td> <td>Lucas</td> </tr> <tr> <td>X.°</td> <td><math>\pm 3^\circ</math></td> <td>①</td> <td>Drawn</td> <td>07.07.2009</td> <td>Dean</td> </tr> <tr> <td>.X.°</td> <td><math>\pm 1^\circ</math></td> <td></td> <td></td> <td></td> <td></td> </tr> <tr> <td>Angle TOL</td> <td></td> <td></td> <td></td> <td></td> <td></td> </tr> </tbody> </table>							Scale	Free	Id.	Modification	Date	Name	TOLERANCE						X.	$\pm 0.38$					.X	$\pm 0.25$					.XX	$\pm 0.13$	③	Update the WSW P/N and drawing	29.07.2013	Amy	DIM TOL		②	Add durability	24.11.2011	Lucas	X.°	$\pm 3^\circ$	①	Drawn	07.07.2009	Dean	.X.°	$\pm 1^\circ$					Angle TOL					
Scale	Free	Id.	Modification	Date	Name																																																							
TOLERANCE																																																												
X.	$\pm 0.38$																																																											
.X	$\pm 0.25$																																																											
.XX	$\pm 0.13$	③	Update the WSW P/N and drawing	29.07.2013	Amy																																																							
DIM TOL		②	Add durability	24.11.2011	Lucas																																																							
X.°	$\pm 3^\circ$	①	Drawn	07.07.2009	Dean																																																							
.X.°	$\pm 1^\circ$																																																											
Angle TOL																																																												
<table border="1"> <thead> <tr> <th>Customer No.</th> <th>Name</th> <th>Date</th> <th>Name</th> </tr> </thead> <tbody> <tr> <td></td> <td>Dean</td> <td>07.07.2009</td> <td>Dean</td> </tr> <tr> <td></td> <td>Amy</td> <td>29.07.2013</td> <td>Amy</td> </tr> </tbody> </table>							Customer No.	Name	Date	Name		Dean	07.07.2009	Dean		Amy	29.07.2013	Amy																																										
Customer No.	Name	Date	Name																																																									
	Dean	07.07.2009	Dean																																																									
	Amy	29.07.2013	Amy																																																									
<p>ASSMANN WSW-No. ③ A-IEE-DIP</p>																																																												
<p>Drawing-No. ASS 3559 CO rev03</p>																																																												
<p>Replace SHEET</p>																																																												
1	2	3	4	5	6	7																																																						