



# Product Change Notification (PCN)

|   |   |             |                 |
|---|---|-------------|-----------------|
| PCN Number                              | 507457  | Date Issued | August 07, 2019 |
| Reason for Change                       | Manufacturing Process Change (Molex)  |             |                 |
| Change Type Description                 | This letter is to inform you that the manufacturing process for the part(s) identified in this notice is changing. No changes will be made to the product as a result of this process change. |             |                 |
| Reason for Short Notice                 | Special Request   |             |                 |
| Assessment of Change                    | Product will be fully qualified before it is shipped. Qualification reports will be available after below listed date   |             |                 |
| Internal Molex Qualification Date       | August 07, 2019   |             |                 |
| Sample Availability Date (Changed Part) | August 07, 2019   |             |                 |
| Planned Implementation Date             | September 07, 2019  |             |                 |
| Method of Identifying Change            | Laser mark  |             |                 |

RELEASED

Before Change

After Change

**Impacted Products Pictures**

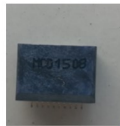
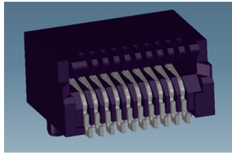

Before: ink printing

**Overview**

- The ink printing will be changed to laser marking on SFP product 744410010, to improve the stability and quality of marking
- Product Impact
  - no impact to fit, form or function
- Part Number Impact
  - 744410010
- Qualification Reports and samples available upon request after the date shown above



After: laser marking



## Product Change Notification (PCN)

---

You may address any technical inquiries regarding this PCN by sending E-mail to [pcn\\_coordinator@molex.com](mailto:pcn_coordinator@molex.com) or your Local Sales Engineer.

Note: While responding, please retain "**PCN Notification:507457**" in the e-mail Subject line for faster response.

RELEASED

**Molex, LLC**  
2222 Wellington Court  
Lisle, IL 60532  
TEL: 630-969-4747  
[www.molex.com](http://www.molex.com)