

SWM/REVISION DESCRIPTION	DFTM	DATE	APPD	APPD
A RELEASED FOR PRODUCTION	Joslen	2016.12.09	TZ	2016.12.09

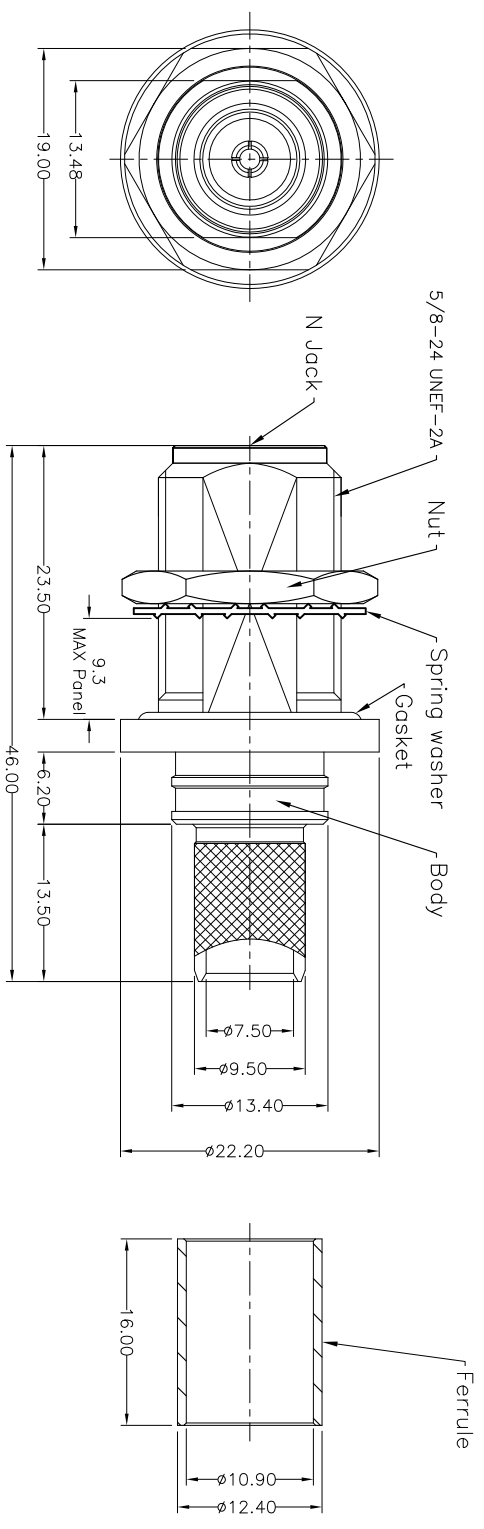

I. MATERIALS & FINISHES

Components	Materials	Finishes	Thk. (µ")
Body	Brass	Albaloy	80
Center Cont.	QB&Z	Gold	50
Ferrule	Brass	Albaloy	80
Nut	Brass	Albaloy	80
Insulator	PTFE	-	-
Gasket	Silicone	-	-

II. ELECTRICAL PROPERTIES

Impedance (Ω):	50
Frequency Range (GHz):	DC to 6 GHz
Working Voltage (V):	2500
Insulation Resistance (MΩ):	≥10000
V/SWR:	51.30
Insertion Loss(dB, f/GHz):	-0.1x √f

IV. MECHANICAL PROPERTIES

Center Cont.:	Finger Contact
Outer Cont.:	Chimp
Coupling Nut Torque (N.m):	1.7
Ch-Connector Retention Force (N):	500
Durability (cycles):	500

III. ENVIRONMENT PROPERTIES

Temperature Range:	-40°C~+125°C
Thermal Shock:	MIL-STD 202G, Meth. 107, Cond.B
Vibration:	MIL-STD 202G, Meth. 204, Cond.B
Shock:	MIL-STD 202G, Meth. 213, Cond I
Climatic Class:	IEC 60068 55/155/56
(2002/95/EC)RoHS:	Compliant

V. TOOLING

Shipping Tool: 3192-004/CST-400
 Crimping Tool: 3190-202/CT-400/300

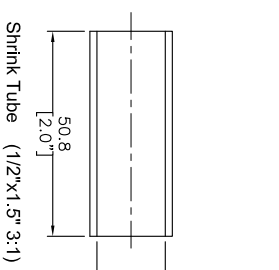

Shrink Tube (1/2"x1.5" 3:1)

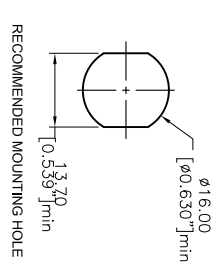
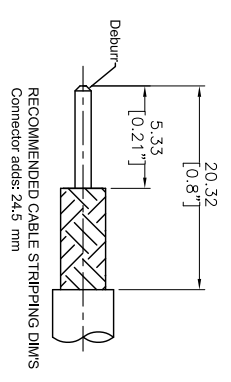

According to Standard: IEC 61169-16

SCALE: N/A	TIME SHEET 04	DO NOT SCALE DRAWING	CODE IDENT	68999	DATE 2016.12.09	DFTM. Joslen	MATERIAL:	
							UNLESS OTHERWISE SPECIFIED	
ALL DIMENSIONS ARE IN mm. MACHINED SURFACES FINISH 1.6 RMS MAX. REMOVE ALL BURRS 0.15X45° MAX. BREAK MACHINE CORNERS 0.15X45° D MAX. FILLET R. TOLERANCES ON DECIMALS X ±0.3 XX ±0.15 ANGLES ±2° FRACTIONS ±N/A								
USED ON: O					DATE	2016.12.09	CHKD	KG
					DATE	2016.12.09	APPD	TZ
				According to Standard: IEC 61169-16				
				3190-6328				