

THIS DRAWING IS UNPUBLISHED. RELEASED FOR PUBLICATION  
 © COPYRIGHT - By - ALL RIGHTS RESERVED.

REVISIONS					
P	LTR	DESCRIPTION	DATE	DWN	APVD
A4		REVISED PER ECR-18-018655	11DEC2018	BW	SV

- 1 CONTINUOUS STRIP ON REELS WITH TERMINALS LOCATED ON 5.59±0.08 [.220±.003] CENTERS.
- 2 SLOT ACCEPTS A SINGLE OR DOUBLE 0.36-0.57mm [#27-#23] AWG COPPER MAGNET WIRE OR SLOT ACCEPTS A SINGLE OR DOUBLE 0.51-0.64mm [#24-#22] AWG ALUMINUM MAGNET WIRE. ALUMINUM WIRE RANGE APPLIES FOR POST-TIN PLATED VERSIONS ONLY.
- 3 AFTER INSERTION INTO PLASTIC HOLDER TAB PORTION MUST BE BENT OVER 45° TO 90° OR POTTED TO PREVENT PULL-OUT WHEN MATING RECEPTACLE IS DISCONNECTED.
- 4 PRELIMINARY - NOT FOR PRODUCTION.

IDENTIFICATION NUMBER 10 FOR MAGNET WIRE RANGE

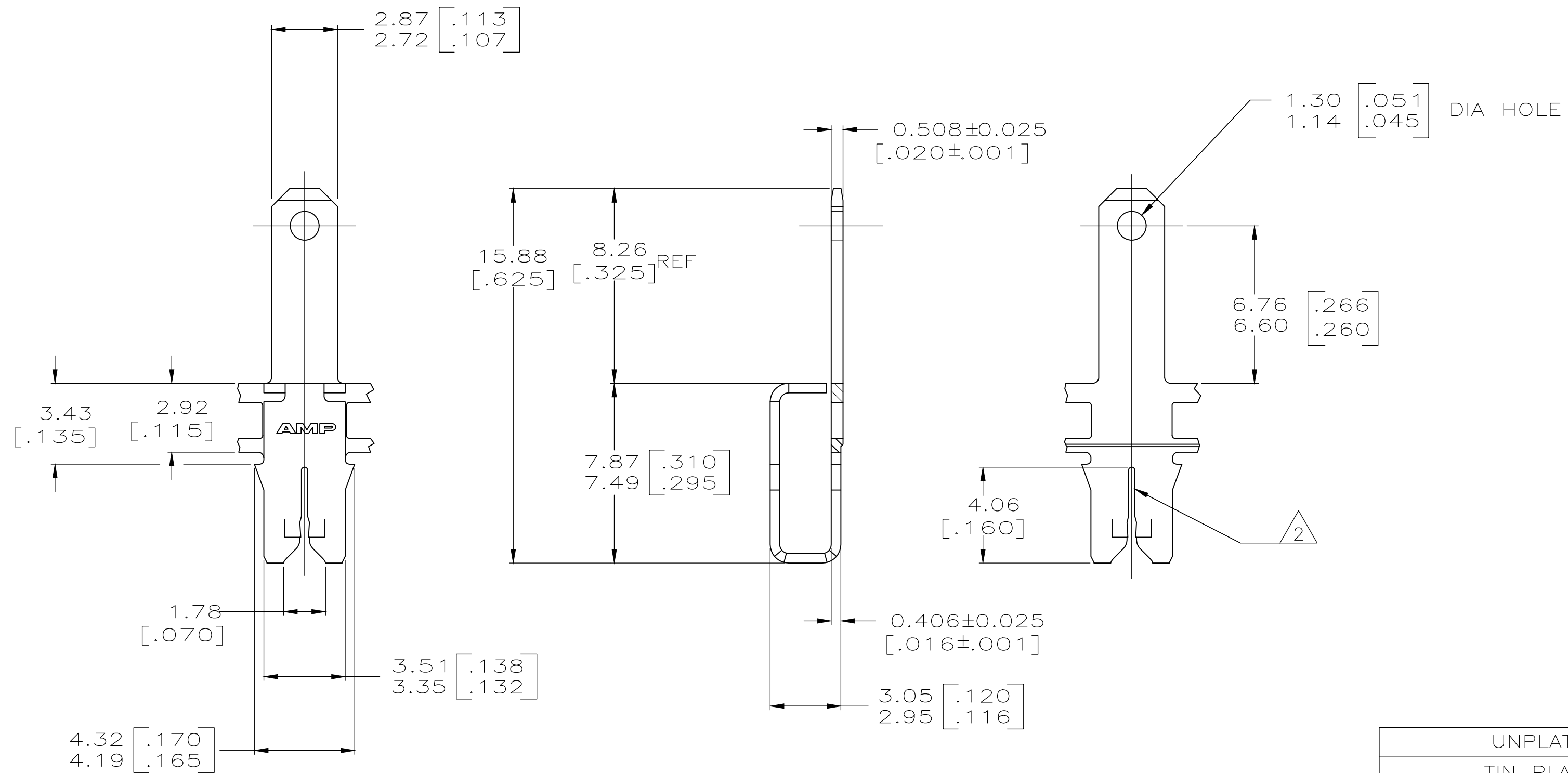
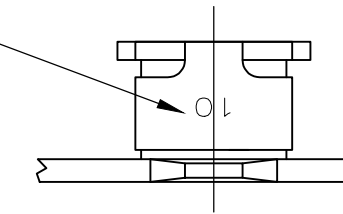

UNPLATED	4 63746-2
TIN PLATED	63746-1
FINISH	PART NO

THIS DRAWING IS A CONTROLLED DOCUMENT.		DWN	11/JAN/94	TE Connectivity Ltd.	
		CHK	13/JAN/94	NAME	
		APVD	14/JAN/94	TAB, 2.79 [.110] FASTON™	
		PRODUCT SPEC		MAG-MATE™	
		APPLICATION SPEC		-	
		114-2046		SIZE	CAGE CODE
		WEIGHT		A2	00779
		CUSTOMER DRAWING		SCALE	SHEET
				6:1	1 of 1
				REV	A4