

2-DIN-46284-ST / 3-DIN-46284-ST

Socket terminal blocks
with steel screws and mounting holes



GENERAL INFORMATION

No. of poles 2 + 3

TECHNICAL DATA

| | |
|--------------------------|---|
| Clamping Range | <i>solid / stranded / AWG</i> 1 - 6 mm ² / 1 - 4 mm ² / 16 - 10 AWG [1] |
| Rated Cross Section | 2,5 mm ² |
| Wire Stripping Length | 6,5 mm ± 0,5 mm |
| Rated Insulation Voltage | 450 V acc. to EN 60998-1 |
| Rated Current | 24 A |
| Torque | 0,5 Nm |
| Base mounting | Recommendation: Screw M3 with matching washer; max. torque 0.8 Nm; use of an elastic & insulating substrate. |
| Other specifications | Terminal strips must not be strung together without considering the clearance and creepage distances. |

APPROVALS

| | Current [A] | Voltage [V] | Group | AWG | [Nm] |
|--|-------------|-------------|-------|---------|------|
| | 20 | 300 | B | 18 - 12 | 0,51 |
| | 20 | 150 | C | 18 - 12 | 0,51 |
| | 10 | 300 | D | 18 - 12 | 0,51 |
| | 20 | 300 | B | 18 - 12 | 0,51 |
| | 20 | 150 | C | 18 - 12 | 0,51 |
| | 10 | 300 | D, E | 18 - 12 | 0,51 |

CONFIGURATIONS

| Item | Article number | PU |
|----------------|----------------|-----|
| 2-DIN-46284-ST | 10.610.012 | 264 |
| 3-DIN-46284-ST | 10.610.013 | 168 |

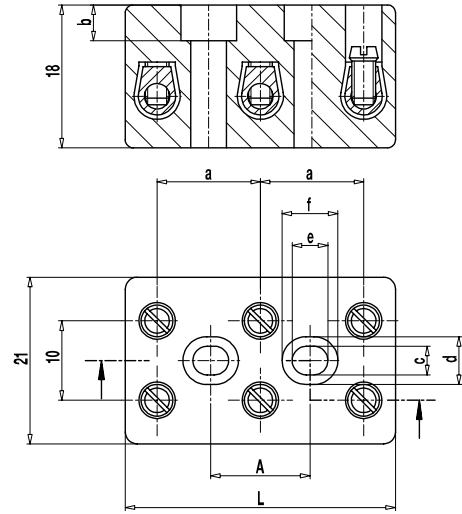

Dimensions (mm)

| Type | L | A | a | b | c | d | e | f |
|----------------|----|------|------|---|-------|-------|-----|---|
| 2-DIN-46284-ST | 20 | — | 11,5 | 4 | ∅ 3,5 | ∅ 6,6 | — | — |
| 3-DIN-46284-ST | 34 | 12,5 | 13 | 4 | 3,6 | 6 | 4,5 | 7 |

MATERIAL

| | |
|----------------------------|--|
| Moulding | Technical ceramics |
| Comparative Tracking Index | CTI ≥ 600 |
| Insulating Group | I |
| Temperature Range | -40°C up to 250°C |
| Terminal body | Nickel plated brass |
| Screw | M3; Zinc plated steel, blue passivated |

OPTIONS / ACCESSORIES

- Version with wire protector on request

[1] Recommendation: Use flexible and AWG conductors with ferrules only.