

RECOMMENDED P.C.B. HOLE LAYOUT

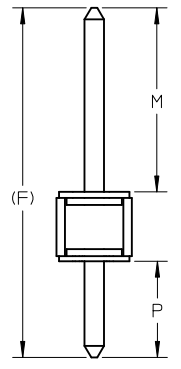
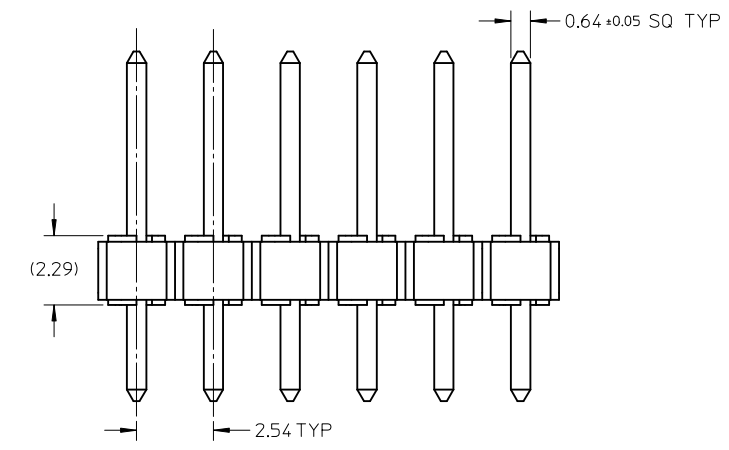

NOTES

1. MATERIAL:  
HSG: NYLON, GLASS-FILLED, UL94V-0 COLOR: BLACK  
PIN: 0.64MM SQ, COPPER ALLOY
2. PLATING TYPE:
  - (1) GOLD FLASH OVER  
1.270µm MIN. NICKEL OVERALL.
  - (2) GOLD FLASH ON CONTACT AND  
1.905µm MIN. TIN ON SOLDER TAIL OVER  
1.270µm MIN. NICKEL OVERALL.
  - (3) 0.254µm MIN. GOLD PLATE ON CONTACT AND  
1.905µm MIN. TIN ON SOLDER TAIL OVER  
1.270µm MIN. NICKEL OVERALL.
  - (4) 0.381µm MIN. GOLD PLATE ON CONTACT AND  
1.905µm MIN. TIN ON SOLDER TAIL OVER  
1.270µm MIN. NICKEL OVERALL.
  - (5) 0.762µm MIN. GOLD PLATE ON CONTACT AND  
1.905µm MIN. TIN ON SOLDER TAIL OVER  
1.270µm MIN. NICKEL OVERALL.
  - (6) 2.540µm/100µm MIN TIN OVERALL  
1.270µm/50µm NICKEL OVERALL
3. PRODUCT SPECIFICATION: PS-87920-019
4. PACKAGING TYPE: SEE TABLE
5. WAFER TO BE FLAT WITHIN 0.003 mm/mm
6. RECOMMENDED PCB THICKNESS IS 1.60mm±0.10
7. IRREGULAR CIRCUIT CUTOFF WITHIN BREAKAWAY SECTION IS PERMISSIBLE. CUTTING OR CHIPPING OF THE MAIN BODY IS NOT ACCEPTABLE
8. THE ABOVE CKT 6 IS FOR ILLUSTRATION PURPOSE ONLY
9. PACKAGING SPECIFICATION:  
TRAY: PK-89990-489  
BULK: PK-89990-491

0074-CN, +878910004 EC NO: S2010-0630 DRWN:ATSEE 2010/01/27 CHKD:SKANG 2010/03/16 APPR:MLONG 2010/03/23	QUALITY SYMBOLS ▽ <sub>A</sub> =0 ▽ <sub>B</sub> =0 ▽ <sub>P</sub> =0	GENERAL TOLERANCES (UNLESS SPECIFIED)		DIMENSION STYLE MM ONLY	SCALE NTS	DESIGN UNITS METRIC	THIRD ANGLE PROJECTION
			mm	INCH	DRAWN BY KCHO	DATE 2004/09/13	TITLE CUSTOM HEADER 2.54MM PITCH, S/ROW HDR. S/WFR W/O STANDOFF, T/H
		4 PLACES	± ---	± ---	CHECKED BY PTLIM	DATE 2004/09/24	MOLEX INCORPORATED
		3 PLACES	± ---	± ---	APPROVED BY MLONG	DATE 2010/03/19	
			ANGULAR ± 3 °		MATERIAL NO. SEE TABLE	DOCUMENT NO. SD-87891-008	SHEET NO. 1 OF 2
B2	DESCRIPTION	DRAFT WHERE APPLICABLE MUST REMAIN WITHIN DIMENSIONS		SIZE A3	THIS DRAWING CONTAINS INFORMATION THAT IS PROPRIETARY TO MOLEX INCORPORATED AND SHOULD NOT BE USED WITHOUT WRITTEN PERMISSION		

CKT SIZE	DIMENSION	
	A	B
02	5.08	2.54
03	7.62	5.08
04	10.16	7.62
05	12.70	10.16
06	15.24	12.70
07	17.78	15.24
08	20.32	17.78
09	22.86	20.32
10	25.40	22.86
11	27.94	25.40
12	30.48	27.94
13	33.02	30.48
14	35.56	33.02
15	38.10	35.56
16	40.64	38.10
17	43.18	40.64
18	45.72	43.18
19	48.26	45.72
20	50.80	48.26
21	53.34	50.80
22	55.88	53.34
23	58.42	55.88
24	60.96	58.42
25	63.50	60.96
26	66.04	63.50
27	68.58	66.04
28	71.12	68.58
29	73.66	71.12
30	76.20	73.66
31	78.74	76.20
32	81.28	78.74
33	83.82	81.28
34	86.36	83.82
35	88.90	86.36
36	91.44	88.90
37	93.98	91.44
38	96.52	93.98
39	99.06	96.52
40	101.60	99.06

PART NO. IN TRAY PACKAGING	PART NO. IN BULK PACKAGING	CKT SIZE	VOID PIN	KINK PIN	DIMENSION			PLATING TYPE
					F	MATING END	SOLDER TAIL	
						M	P	
87891-0003	-	3	2	-	13.72	9.65	1.78	6
87891-0004	-	4	-	-	35.10	29.71	3.10	6
-	87891-0006	6	-	-	11.56	6.09	3.18	6
87891-0007	-	7	-	-	13.72	9.65	1.78	6
87891-2200	-	22	-	-	11.56	6.09	3.18	6
-	87891-3600	36	-	-	11.56	6.09	3.18	2

<b>0074-CN, +878910004</b> EC NO: S2010-0630 DRWNATSEE 2010/01/27 CHKD:SKANG 2010/03/16 APPR:MLONG 2010/03/23	DESCRIPTION <b>B2</b>	QUALITY SYMBOLS	GENERAL TOLERANCES (UNLESS SPECIFIED)	DIMENSION STYLE	SCALE	DESIGN UNITS	THIRD ANGLE PROJECTION																
		$\nabla_A = 0$ $\nabla_C = 0$ $\nabla_P = 0$	<table border="1"> <tr><th>mm</th><th>INCH</th></tr> <tr><td>4 PLACES ± ---</td><td>± ---</td></tr> <tr><td>3 PLACES ± ---</td><td>± ---</td></tr> <tr><td>2 PLACES ± 0.20</td><td>± ---</td></tr> <tr><td>1 PLACE ± ---</td><td>± ---</td></tr> </table>	mm	INCH	4 PLACES ± ---	± ---	3 PLACES ± ---	± ---	2 PLACES ± 0.20	± ---	1 PLACE ± ---	± ---	MM ONLY	NTS	METRIC							
		mm	INCH																				
		4 PLACES ± ---	± ---																				
3 PLACES ± ---	± ---																						
2 PLACES ± 0.20	± ---																						
1 PLACE ± ---	± ---																						
<table border="1"> <tr><th>DRAWN BY</th><th>DATE</th><th>TITLE</th></tr> <tr><td>KCHO</td><td>2004/09/13</td><td rowspan="3">CUSTOM HEADER 2.54MM PITCH, S/ROW HDR. S/WFR W/O STANDOFF, T/H</td></tr> <tr><th>CHECKED BY</th><th>DATE</th></tr> <tr><td>PTLIM</td><td>2004/09/24</td></tr> <tr><th>APPROVED BY</th><th>DATE</th></tr> <tr><td>MLONG</td><td>2010/03/19</td></tr> </table>	DRAWN BY	DATE	TITLE	KCHO	2004/09/13	CUSTOM HEADER 2.54MM PITCH, S/ROW HDR. S/WFR W/O STANDOFF, T/H	CHECKED BY	DATE	PTLIM	2004/09/24	APPROVED BY	DATE	MLONG	2010/03/19	<table border="1"> <tr><th>MATERIAL NO.</th><th>DOCUMENT NO.</th></tr> <tr><td>SEE TABLE</td><td>SD-87891-008</td></tr> </table>	MATERIAL NO.	DOCUMENT NO.	SEE TABLE	SD-87891-008	MOLEX INCORPORATED	<table border="1"> <tr><th>SHEET NO.</th></tr> <tr><td>2 OF 2</td></tr> </table>	SHEET NO.	2 OF 2
DRAWN BY	DATE	TITLE																					
KCHO	2004/09/13	CUSTOM HEADER 2.54MM PITCH, S/ROW HDR. S/WFR W/O STANDOFF, T/H																					
CHECKED BY	DATE																						
PTLIM	2004/09/24																						
APPROVED BY	DATE																						
MLONG	2010/03/19																						
MATERIAL NO.	DOCUMENT NO.																						
SEE TABLE	SD-87891-008																						
SHEET NO.																							
2 OF 2																							
DRAFT WHERE APPLICABLE MUST REMAIN WITHIN DIMENSIONS		<table border="1"> <tr><th>SIZE</th></tr> <tr><td>A3</td></tr> </table>	SIZE	A3	THIS DRAWING CONTAINS INFORMATION THAT IS PROPRIETARY TO MOLEX INCORPORATED AND SHOULD NOT BE USED WITHOUT WRITTEN PERMISSION																		
SIZE																							
A3																							