

# Molded Parts Specification Control Drawing

Part Number : 101A062-X-14  
Description : Cap, Round End

## NOTES

- All dimensions are in  $\frac{\text{inches}}{[\text{millimeters}]}$
- Dimensions appearing in table are as follows:
  - As Supplied
  - After Unrestricted Recovery
- Coating is optional. As supplied dimensions appearing in table are for uncoated parts. When coating is added, entry diameters will be reduced by .06 max.
- Recovered parts may have angularity of 30° - 45°.

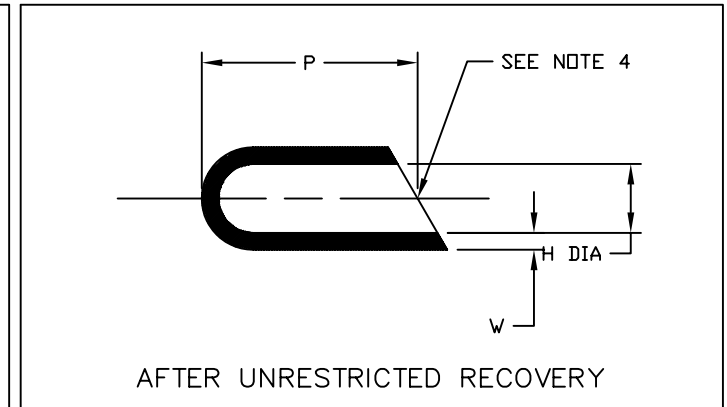
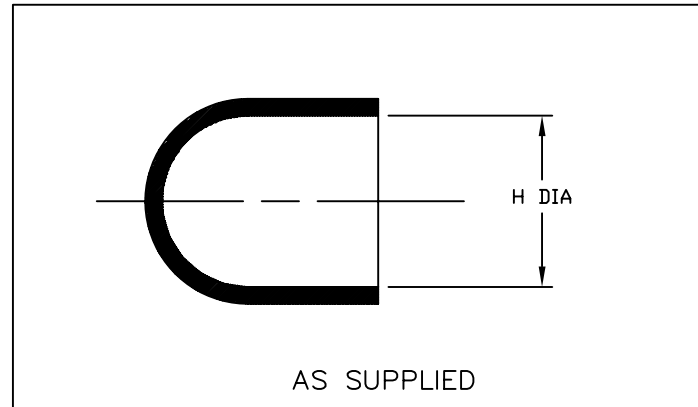

TABLE OF DIMENSIONS				
PART NUMBER	H		P	W
	Min	Max	±.25	±20%
	a	b	b	b
101A062-X-14	$\frac{1.00}{[25,4]}$	$\frac{.45}{[11,4]}$	$\frac{1.50}{[38,1]}$	$\frac{.09}{[2,29]}$

If this document is printed it becomes uncontrolled. Check for the latest revision

**tyco**  
Electronics **Raychem**

TYCO ELECTRONICS  
300 CONSTITUTION DRIVE  
MENLO PARK, CALIFORNIA 94025

© 2006 Tyco Electronics Corporation. All rights reserved

Revision : A  
Date : 12/6/06  
Page 1 Of 2

Part Number : 101A062-X-14  
Description : Cap, Round End  
DCR MP060172

# Molded Parts Specification Control Drawing

Part Number : 101A062-X-14

Description : Cap, Round End

COMPATABILITY CHART					
MATERIAL DASH NO.	MATERIAL DESCRIPTION	RT SPEC	COATING SLASH NO.	COATING S NO.	COATING DESCRIPTION
-3	Polyolefin, Semi-rigid	RT-301	N.A.		

## ORDERING INFORMATION

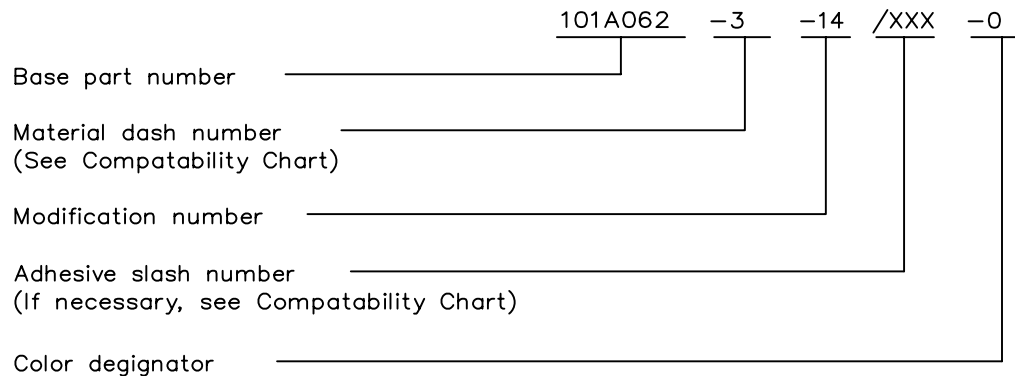

THIS DRAWING IS SUBJECT TO CHANGE WITHOUT NOTICE; CONSULT YOUR  
NEAREST FIELD REPRESENTATIVE FOR CURRENT REVISION

If this document is printed it becomes uncontrolled. Check for the latest revision

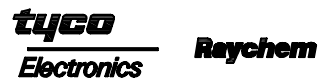

TYCO ELECTRONICS  
300 CONSTITUTION DRIVE  
MENLO PARK, CALIFORNIA 94025

© 2006 Tyco Electronics Corporation. All rights reserved

Revision : A

Date : 12/6/06

Page 2 Of 2

Part Number : 101A062-X-14

Description : Cap, Round End

DCR MP060172