

Housing - HC-B 24-TMZ-H-O1STM32G - 1410822

Please be informed that the data shown in this PDF Document is generated from our Online Catalog. Please find the complete data in the user's documentation. Our General Terms of Use for Downloads are valid (<http://phoenixcontact.com/download>)



HEAVYCON sleeve housing B24, with main latch, height 76 mm, with 1 x M32 thread, straight conductor outlet



Key Commercial Data

Packing unit	1 pc
Weight per Piece (excluding packing)	396.0 g
Custom tariff number	85389099
Country of origin	Germany

Technical data

Dimensions

Height	76 mm
Width	43 mm
Length	94 mm

Ambient conditions

Ambient temperature (operation)	-40 °C ... 125 °C
---------------------------------	-------------------

General

Note	For contact inserts HC-B24, BB46, D64, DD108, M
Size	B16
Housing type	Sleeve housing
Locking type	with main latch
No. of cable outlets	1
Cable exit	straight
Screw connection	none
Type of the screw connection	1x M32
Housing material	Aluminum die-cast

Housing - HC-B 24-TMZ-H-O1STM32G - 1410822

Technical data

General

Housing surface material	Powder-coated, gray
Material lock	Steel, galvanized

Classifications

eCl@ss

eCl@ss 4.0	272607xx
eCl@ss 4.1	27260701
eCl@ss 5.0	27143424
eCl@ss 5.1	27143424
eCl@ss 6.0	27143424
eCl@ss 7.0	27440209
eCl@ss 8.0	27440202
eCl@ss 9.0	27440202

ETIM

ETIM 4.0	EC000437
ETIM 5.0	EC000437

UNSPSC

UNSPSC 6.01	31261502
UNSPSC 7.0901	31261502
UNSPSC 11	31261502
UNSPSC 12.01	31261502
UNSPSC 13.2	31261502

Approvals

Approvals

Approvals

EAC

Ex Approvals

Approvals submitted

Housing - HC-B 24-TMZ-H-O1STM32G - 1410822

Approvals

Approval details

EAC

Drawings

Dimensional drawing

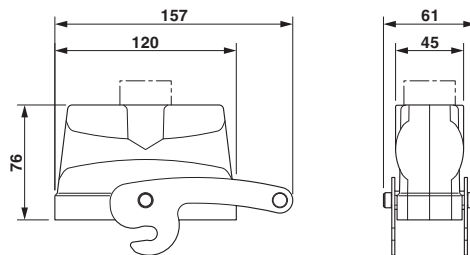

Dimensional drawing
