

SMD Laser Sealing Crystals 3.2 x 2.5 x 0.7 mm 4PADS



MDH Technology Co.,Ltd

ELECTRICAL CHARACTERISTICS

PARAMETERS	CONDITIONS	SMD3225			UNIT
		MIN	TYP	MAX	
Frequency		12		54	MHz
Mode	Fundamental	-	-	-	-
Frequency Tolerance	At 25°C	±10		±20	ppm
Frequency Stability		±10		±30	ppm
Operating Temperature	-20~+70°C, -40~+85°C, or specify				°C
Equivalent Series Resistance	See Table 1				Ω
Shut Capacitance	C0			3	pF
Load Capacitance	-	10pF, or specify			pF
Drive Level	DL		100		uW
Storage Temperature	-	-55		+125	°C
Aging	-			±3	ppm/Year

TABLE 1 - STANDARD ESR

Frequency(MHz)	ESR Ω Max.
12.000~16.000	80
16.000~20.000	70
20.000~24.000	40
50.000~54.000	30

DIMENSIONS

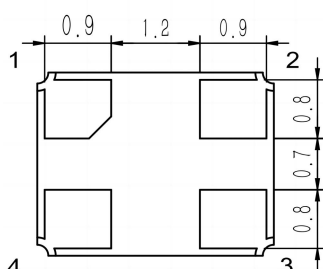
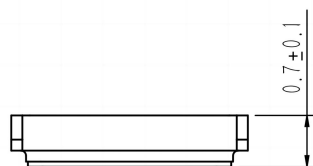
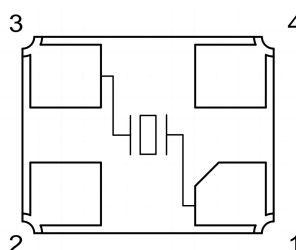
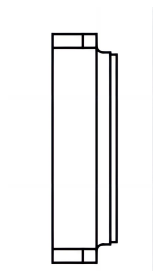
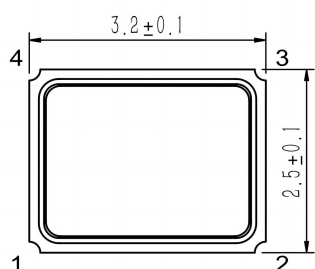

	Pin Connection
1# PIN	IN/OUT
2# PIN	GND
3# PIN	IN/OUT
4# PIN	GND

