

CONNECTOR P/N	CONNECTOR TYPE	FERRULE HOLE ϕD (μm)	FERRULE HOLE CONCENTRICITY ϕd (μm)	HOUSING COLOR	BOOT COLOR	BOOT LOGO VERSION
1060257420	SINGLE MODE	126.0	1.0	BLUE	WHITE	MOLEX LOGO
1060257451					BLUE	
1060257452					BEIGE	
1060247453					YELLOW	
1060257454					WHITE	
1060257455					RED	
1060257456					GREEN	
1060257457					BLUE	
1060257458					BEIGE	
1060257459					YELLOW	
1060257460	MULTIMODE	127.0	3.0	BEIGE	WHITE	NO LOGO
1060257461					RED	
1060257462					GREEN	
1060257470					BEIGE	
1060257471					WHITE	
						MOLEX LOGO

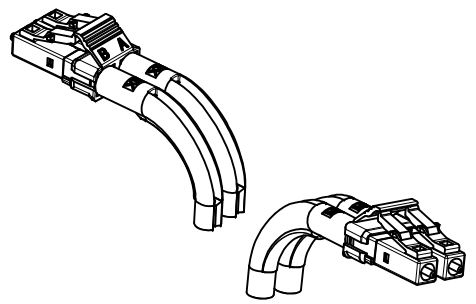

ISOMETRIC VIEWS
SCALE 1.5:1

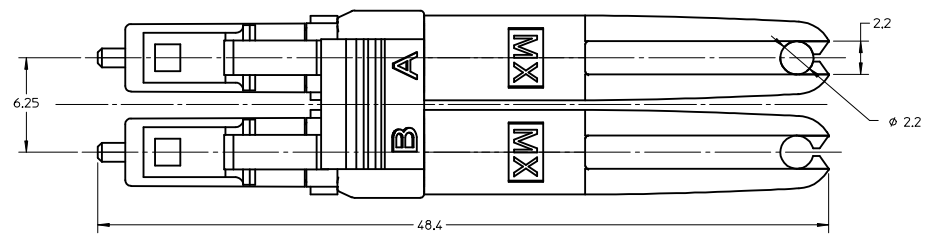
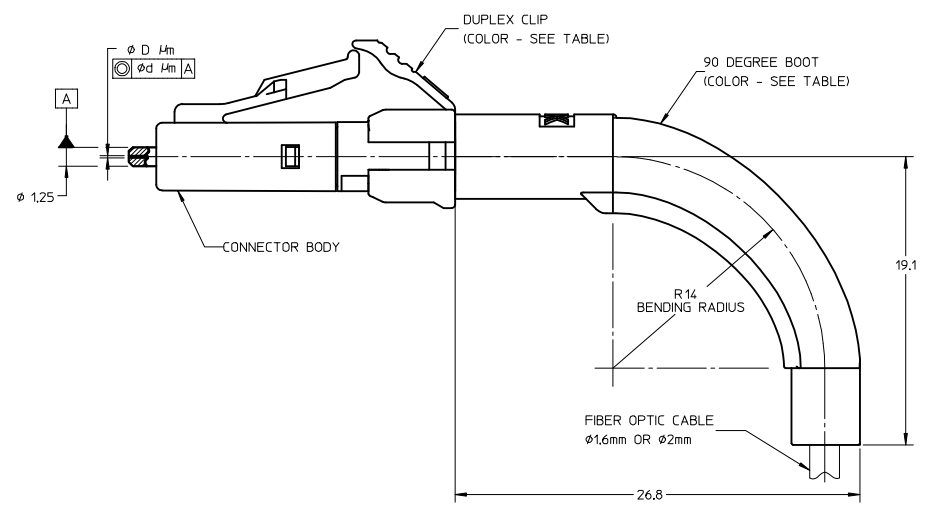
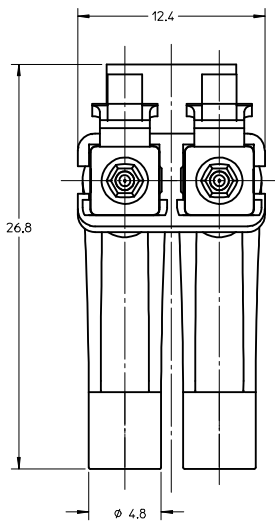

- NOTES:
- ALL DIMENSIONS ARE FOR REFERENCE ONLY.
 - DUST CAPS ARE NOT SHOWN.
 - DUPLEX CLIP AND 90 DEGREE BOOTS SHOULD BE ASSEMBLED AFTER POLISHING OPERATION.

ENTER DESCRIPTION EC NO: MF2008-0240 DRWN: IGJMIN 2007/12/04 CHKD: 2007/12/04 APPR: IGJMIN 2007/12/05	QUALITY SYMBOLS = 0 = 0.1	GENERAL TOLERANCES (UNLESS SPECIFIED)		DIMENSION STYLE MM ONLY	SCALE 4:1	DESIGN UNITS METRIC	THIRD ANGLE PROJECTION		
		4 PLACES ± --- ± --- 3 PLACES ± --- ± --- 2 PLACES ± --- ± --- 1 PLACE ± --- ± ---	mm INCH ± --- ± --- ± --- ± --- ± --- ± --- ± --- ± ---	DRAWN BY BGW	DATE 12/01/05	TITLE LC DUPLEX CONNECTOR, 90 DEG. TIGHT BEND BOOT, 1.6&2.0MM CABLE			
		ANGULAR ±1/2°		CHECKED BY DATE	APPROVED BY DATE	MOLEX INCORPORATED			
		DRAFT WHERE APPLICABLE MUST REMAIN WITHIN DIMENSIONS		MATERIAL NO. SEE TABLE	DOCUMENT NO. SD-106025-74XX	SHEET NO. 1 OF 1			

THIS DRAWING CONTAINS INFORMATION THAT IS PROPRIETARY TO MOLEX INCORPORATED AND SHOULD NOT BE USED WITHOUT WRITTEN PERMISSION